

POWER INDUCTORS

AIMT-01 (V)(H) SERIES



STANDARD SPECIFICATIONS:

Part Number AIMT-01-*	L (μH) ±20%	I _{DC} Max (A)	L (μH) Min @I _{DC}	R _{DC} Max (Ω)	Dim A Nom.	Dim D Nom.
5.0-0.5	5.0	0.5	4.9	0.007	0.30 (7,5)	0.18 (4,5)
8.2-2.0	8.2	2	7.2	0.017	0.57 (14,5)	0.28 (7,0)
10-2.0	10	2	7.7	0.013	0.48 (12,0)	0.28 (7,0)
15-2.0	15	2	12.6	0.023	0.61 (15,5)	0.30 (7,5)
20-3.0	20	1	15	0.021	0.69 (17,5)	0.35 (9,0)
24-1.0	24	1	22	0.055	0.54 (13,5)	0.24 (6,0)
25-5.0	25	5	18	0.016	0.95 (24,0)	0.41 (10,5)
29-4.0	29	4	20	0.020	0.83 (21,0)	0.44 (11,0)
30-2.0	30	2	25	0.035	0.67 (17,0)	0.34 (8,5)
30-10	30	10	21	0.009	1.42 (36,0)	0.77 (19,5)
35-3.0	35	3	28	0.026	0.81 (20,5)	0.41 (10,5)
35-10	35	10	25	0.010	1.42 (36,0)	0.77 (19,5)
43-1.0	43	1	37	0.074	0.57 (14,5)	0.28 (7,0)
43-3.0	43	3	30	0.030	0.91 (23,0)	0.38 (9,5)
50-5.0	50	5	33	0.022	1.05 (26,5)	0.50 (12,5)
60-3.0	60	3	35	0.038	0.71 (18,0)	0.40 (10,0)
68-1.0	68	1	53	0.095	0.54 (13,5)	0.26 (6,5)
68-7.0	68	7	46	0.021	1.34 (34,0)	0.71 (18,0)
75-3.0	75	3	54	0.039	1.00 (25,5)	0.44 (11,0)
75-10	75	10	43	0.014	1.66 (42,0)	0.77 (19,5)
82-3.0	82	3	60	0.042	0.97 (24,5)	0.41 (10,5)
82-5.0	82	5	52	0.033	1.24 (31,5)	0.61 (15,5)
82-7.0	82	7	53	0.023	1.36 (34,5)	0.71 (18,0)
90-3.0	90	3	52.5	0.044	0.81 (20,5)	0.50 (12,5)
90-5.0	90	5	54	0.034	1.16 (29,5)	0.61 (15,5)
100-2.0	100	2	63	0.081	0.67 (17,0)	0.35 (9,0)
100-3.0	100	3	80	0.044	0.905 (23,0) min 0.984 (25,0) max	.472 (12,0) min .571 (14,5) max
100-5.0	100	5	53	0.033	1.05 (26,5)	0.50 (12,5)

PHYSICAL CHARACTERISTICS:

Horizontal Mounted

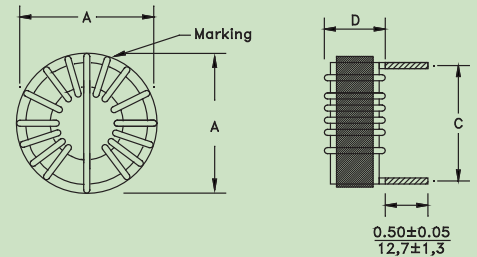

Vertical Mounted

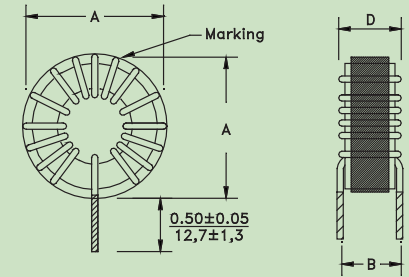

Dimension: inch/mm

Part Number AIMT-01-*	L (μH) ±20%	I _{DC} Max (A)	L (μH) Min @I _{DC}	R _{DC} Max (Ω)	Dim A Nom.	Dim D Nom.
110-2.0	110	2	79	0.069	0.77 (19,5)	0.40 (10,0)
110-4.0	110	4	56	0.042	0.93 (23,5)	0.44 (11,0)
130-1.0	130	1	116	0.146	0.75 (19,0)	0.35 (9,0)
130-3.0	130	3	77	0.055	0.91 (23,0)	0.41 (10,5)
130-7.0	140	7	79	0.031	1.62 (41,0)	0.67 (17,0)
140-1.0	140	1	104	0.140	0.60 (15,0)	0.30 (7,5)
140-3.0	150	3	98	0.064	1.10 (28,0)	0.57 (14,5)
150-1.0	150	1	137	0.159	0.85 (21,5)	0.30 (7,5)
150-4.0	150	4	110	0.053	1.28 (32,5)	0.65 (16,5)
150-5.0	150	5	87	0.042	1.06 (27,0)	0.54 (13,5)
200-2.0	200	2	154	0.114	1.10 (28,0)	0.55 (14,0)
200-3.0	200	3	147	0.078	1.22 (31,0)	0.63 (16,0)
200-5.0	200	5	134	0.056	1.54 (39,0)	0.67 (17,0)
220-1.0	220	1	162	0.190	0.65 (16,5)	0.32 (8,0)
220-2.4	220	2.4	114	0.120	0.84 (21,3)	0.43(10,9)
220-4.0	220	4	105	0.059	1.04 (26,5)	0.52(13,0)
250-10	250	10	105	0.027	1.67 (42,5)	0.85 (21,5)
270-3.0	270	3	140	0.081	1.02 (26,0)	0.50 (12,0)
300-2.0	300	2	250	0.142	1.24 (31,5)	0.61 (15,5)
300-5.0	300	5	240	0.064	1.18 (30,0)	0.61 (15,5)
350-5.0	350	5	260	0.076	1.18 (30,0)	0.61 (15,5)
390-4.0	390	4	165	0.088	1.16 (29,5)	0.60 (15,0)
450-2.0	450	2	280	0.174	1.12 (28,0)	0.55 (14,0)
500-3.0	500	3	242	0.124	1.14 (29,0)	0.55 (14,0)
680-5.0	680	5	295	0.105	1.54 (39,0)	0.73 (18,5)
780-2.0	780	2	428	0.225	1.12 (28,5)	0.54 (13,5)
850-2.0	850	2	567	0.211	1.28 (32,5)	0.65 (16,5)
960-1.0	960	1	625	0.438	0.98 (25,0)	0.44 (11,0)

TECHNICAL INFORMATION:

- Inductance (L) measured @ 100KHz, 0.1VRMS
- Operating Temperature: -55°C to +125°C
- Add "-V" for vertical mounted and "-H" for horizontal mounted
- Dimension B : D ± 0.60 (1,53)
- Dimension C = A ± 0.60 (1,53)

Note: All specifications subject to change without notice. RoHS Compliance Product.