

### LO568NRB2-80Q-A

#### Features

5mm Oval Lens  
 No Stand Offs  
 White Diffused Lens  
 Blue/Red Bi-Color LED

#### Applications

Variable Message Signs  
 Message Board

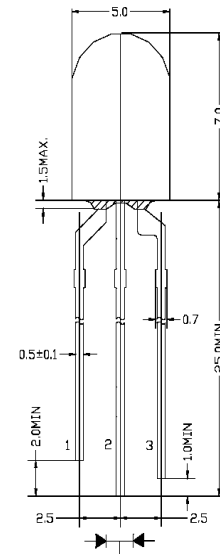

- 1. BLUE ANODE
- 2. COMMON CATHODE
- 3. RED ANODE

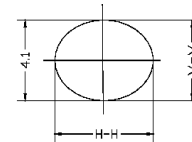

- NOTES: 1. ALL DIMENSIONS ARE IN mm TOLERANCE IS ±0.25mm UNLESS OTHERWISE NOTED.  
 2. AN EPOXY MENISCUS MAY EXTEND ABOUT 1.5mm DOWN THE LEADS.  
 3. BURR AROUND BOTTOM OF EPOXY MAY BE 0.5 mm MAX.

#### Maximum Ratings (Ta=25°C)

Characteristic	Symbol	Max.		Unit
		TBL	AHR	
Forward Current	I <sub>F</sub>	25	50	mA
Reverse Voltage	V <sub>R</sub>	5	5	V
Power Dissipation	P <sub>D</sub>	105.00	125.00	mW
Operating Temperature	T <sub>opr</sub>	-40 ~ +95	-40 ~ +95	°C
Storage Temperature	T <sub>stg</sub>	-40 ~ +100	-40 ~ +100	°C
Soldering Temperature	T <sub>sol</sub>	260	260	°C
Soldering Time	-	for 3 sec. max	for 3 sec. max	-

#### Opto-Electrical Characteristics (Ta=25°C)

Characteristic	Symbol	Test Condition	Min		Typ		Max		Unit
			TBL	AHR	TBL	AHR	TBL	AHR	
Forward Voltage	V <sub>F</sub>	I <sub>F</sub> =20mA	-	-	3.60	2.00	4.20	2.50	V
Reverse Current	I <sub>R</sub>	V <sub>R</sub> =5V	-	-	-	-	100	100	μA
Luminous Intensity	I <sub>v</sub>	I <sub>F</sub> =20mA	52.00	102.00	120.00	200.00	-	-	mcd
Viewing Angle	2θ <sup>1/2</sup>	-	-	-	80° x 60°	80° x 60°	-	-	deg.
Peak Wavelength	λ <sub>p</sub>	I <sub>F</sub> =20mA	-	-	465	632	-	-	nm
Dominant Wavelength	λ <sub>d</sub>	I <sub>F</sub> =20mA	-	-	470	624	-	-	nm
Spectral Line Half Width	Δλ	I <sub>F</sub> =20mA	-	-	26	20	-	-	nm

### LO568NRB2-80Q-A Graphs

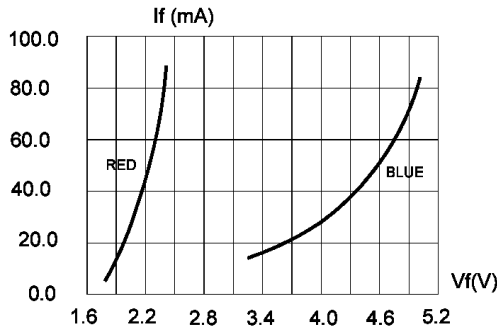

FIG.1 FORWARD CURRENT VS. FORWARD VOLTAGE.

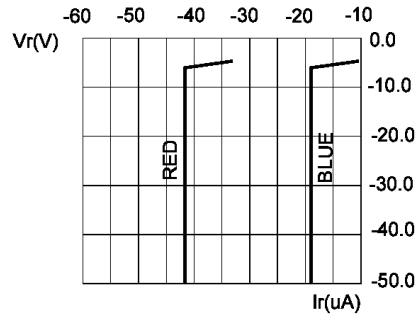

FIG.2 REVERSE CURRENT VS. REVERSE VOLTAGE.

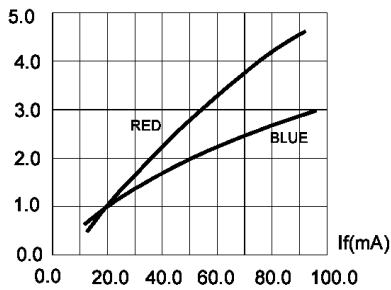

FIG.3 RELATIVE LUMINOUS INTENSITY VS. FORWARD CURRENT

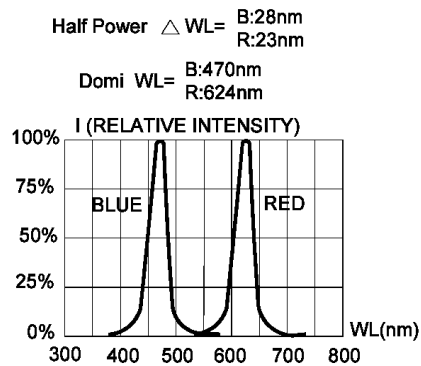

FIG.4 RELATIVE INTENSITY VS. WAVE LENGTH.

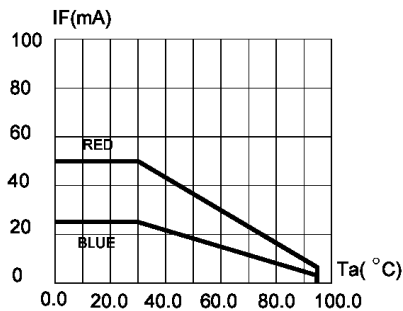

FIG.5 MAXIMUM FORWARD DC CURRENT VS. AMBIENT TEMPERATURE ( $T_{jmax}=105\text{ }^{\circ}\text{C}$ )

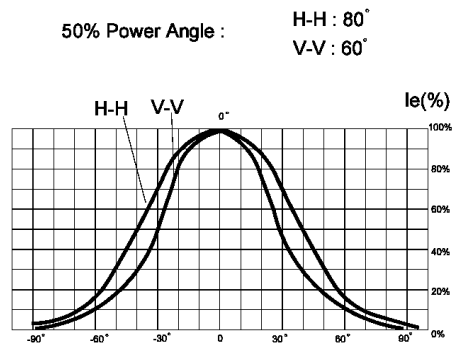

FIG.6 SPATIAL DISTRIBUTION.