

8.0 Amp SINGLE PHASE SILICON BRIDGE

KBU800 . . . 810 Series

Description



Mechanical Dimensions

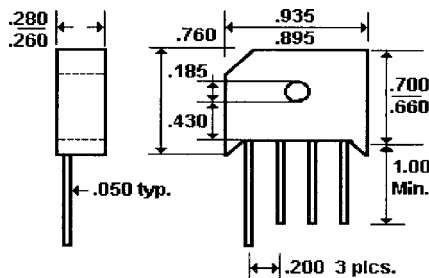

Mechanical Data: Weight - 0.3 Ounces. Mounting Torque - 5.1 lbs. Mounting Position - Any.

Features

- **COMPACT SIZE**
- **LOW LEAKAGE CURRENT**
- **300 AMP SURGE OVERLOAD RATING**
- **MEETS UL SPECIFICATION 94V-0**

Electrical Characteristics @ 25°C.	<i>KBU800 . . . 810 Series</i>							Units	
Maximum Ratings	KBU800	KBU801	KBU802	KBU804	KBU806	KBU808	KBU810		
Peak Repetitive Reverse Voltage... V_{RRM}	50	100	200	400	600	800	1000	Volts	
RMS Reverse Voltage... $V_{R(rms)}$	35	70	140	280	420	560	700	Volts	
DC Blocking Voltage... V_{DC}	50	100	200	400	600	800	1000	Volts	
Average Forward Rectified Current... $I_{F(av)}$ $T_A = 25^\circ C$			8.0			Amps	
Non-Repetitive Peak Forward Surge Current... I_{FSM} 8.3 mS Single ½ Sine Wave Imposed on Rated Load			300			Amps	
Rating for Fusing ($T < 8.3mS$)			167			A°S	
Forward Voltage... V_F Per Leg @ 8.0 Amps			1.0			Volts	
DC Reverse Current... I_R @ Rated DC Blocking Voltage			1.0			μAmps mAmps	
Typical Thermal Resistance... $R_{\theta JC}$ (Alum Heat Sink)			6.0			°C/W	
Thermal Resistance... $R_{\theta JA}$ (Free Air)			8.0			°C/W	
Typical Junction Capacitance... C_j	<		210	> <		90	>		pF
Operating & Storage Temperature Range... T_J, T_{STRG}			-55 to 150			°C	

8.0 Amp SINGLE PHASE SILICON BRIDGE

KBU800 . . . 810 Series

Forward Current Derating Curve

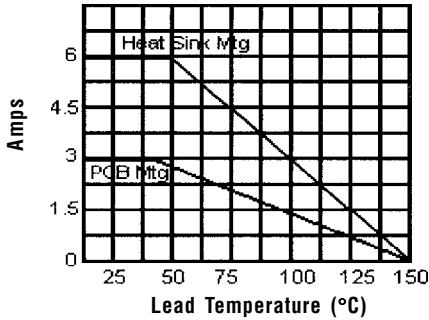

Non-Repetitive Peak Forward Surge Current

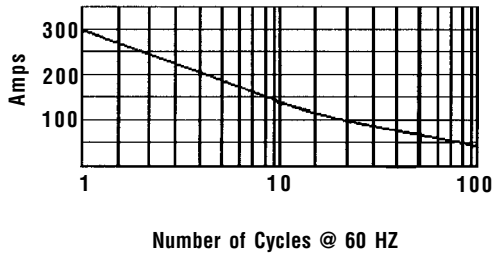

Typical Instantaneous Forward Characteristics

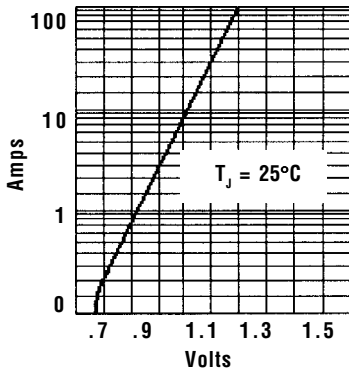

Typical Reverse Characteristics

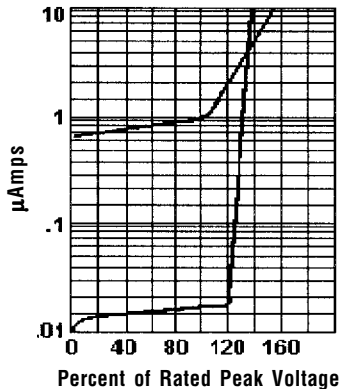

Typical Junction Capacitance

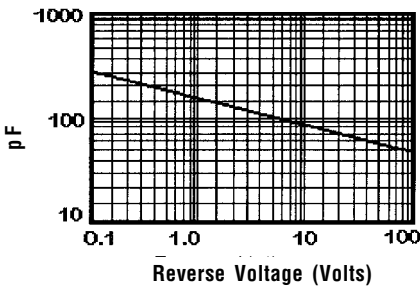

Electrical Description

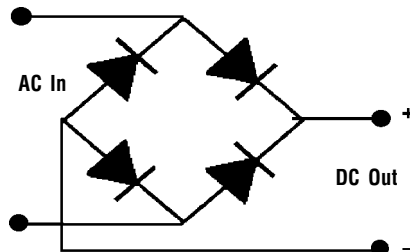

Ratings at 25 Deg. C ambient temperature unless otherwise specified.

Single Phase Half Wave, 60 HZ Resistive or Inductive Load.

For Capacitive Load, Derate Current by 20%.