

Case: B-Puk

| MAXIMUM RATINGS (Tj = 25 °C unless stated otherwise) | | | | | |
|--|-------------|-----------------|-------------|-------------|-------------------|
| Parameter | Symbol | SD2000C 04L | SD2000C 08L | SD2000C 10L | Unit |
| Repetitive Peak Reverse Voltage | V_{RRM} | 400 | 800 | 1000 | Volt |
| Maximum Average On-State Current | $I_{F(AV)}$ | 2100 at TC=55°C | | | Amp |
| Peak Forward Surge Current | I_{FSM} | 25000 | | | Amp |
| Maximum I^2T for Fusing | I^2T | 2608 | | | A ² /S |
| Maximum Storage Temperature Range | $T_{(STG)}$ | -55 to +200 | | | °C |
| Maximum Junction Temperature Range | T_j | -40 to +180 | | | °C |

| ELECTRICAL CHARACTERISTICS at 25 °C Maximum Unless Stated | | | | Value | | | Unit |
|---|----------------|------------------------------|-----|-------|-------|------|------|
| Parameter | Symbol | Condition | Min | Typ | Max | | |
| Maximum Forward Voltage | V_{FM} | $I_{pk} = 6000 \text{ Amps}$ | | | 1.55 | Volt | |
| Repetitive Peak Off- State Current at TC=175°C | I_{RRM} | $V_R = V_{RRM}$ | | | 60.0 | mA | |
| Thermal Resistance (Junction toHeatsink) | $R_{TH (j-h)}$ | | | | 0.073 | °C/W | |
| Mounting Torque | M_T | | | | 14700 | NM | |
| Weight | Wt | | | | 255 | grms | |

Mechanical Dimensions

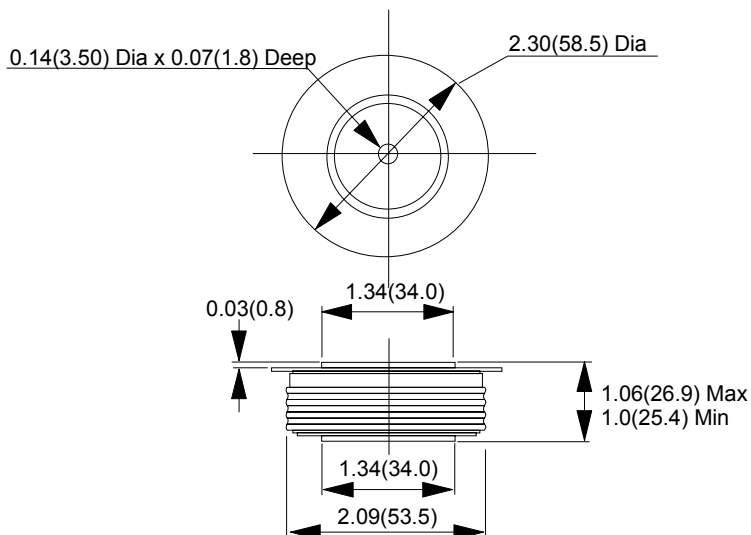

All Dimensions in Inches (Millimeters)
 Third Angle Projection