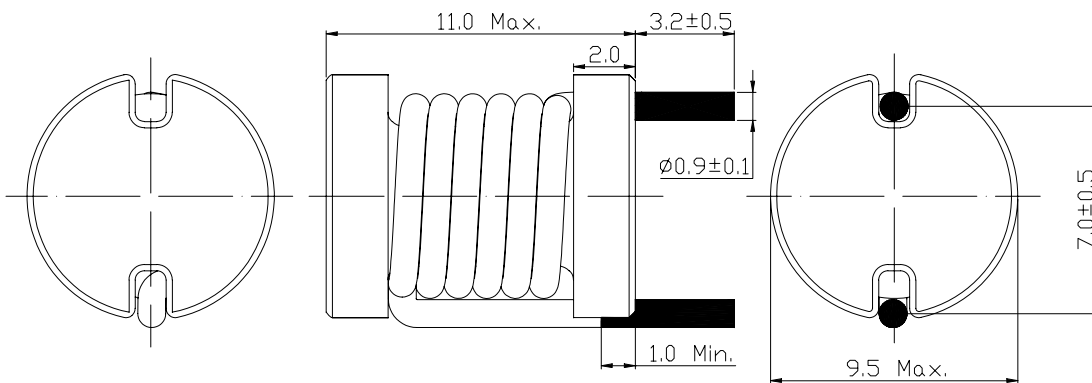

Type: MCDR810
◆ Product Description

- 9.5mm Max. ϕ , 11.0mm Max.Height
- Inductance range: 1.0 μ H
- Rated current range: 10.0A
- Custom design is available.

◆ Feature

- Magnetically unshielded construction.
- Ideally Used in Printers, LCD TV, DVD, Printer, Copy Machine, Mainboard of PC etc as Power Supply Inductors or DC-DC Converter inductors.
- RoHS Compliance.

◆ Dimensions (mm)

◆ Specification

Part Name	Stamp	Inductance (μ H) 100kHz	D.C.R. (m Ω)[Max.] at 20°C	Saturation Current (A) ※1		Temperature Rise Current (A)※2
				(at 20°C)	(at 105°C)	
MCDR810NP-1R0N	1R0	1.0 μ H \pm 30%	4.5(3.2)	15	12	10

※1 Saturation current: The DC current at which the inductance decreases to 90% of its initial value.

※2 Temperature rise current: The DC current at which the temperature rise is $\Delta t=40^{\circ}\text{C}$ ($T_a=20^{\circ}\text{C}$).