

**Alchip® MVJ Series**

- Endurance : 105°C 2000 hours
- Solvent-proof type
- Pb-free design



◆SPECIFICATIONS

Items	Characteristics							
<b>Category</b>	-40 to +105°C							
<b>Temperature Range</b>	-40 to +105°C							
<b>Rated Voltage Range</b>	6.3 to 50V <sub>dc</sub>							
<b>Capacitance Tolerance</b>	±20% (M) (at 20°C, 120Hz)							
<b>Leakage Current</b>	I=0.01CV or 3μA, whichever is greater. Where, I : Max. leakage current (μA), C : Nominal capacitance (μF), V : Rated voltage (V) (at 20°C after 2 minutes)							
<b>Dissipation Factor (tanδ)</b>	Rated voltage (V <sub>dc</sub> )	6.3V	10V	16V	25V	35V	50V	(at 20°C, 120Hz)
	tanδ (Max.)	0.30	0.24	0.20	0.16	0.14	0.12	
<b>Low Temperature Characteristics (Max. Impedance Ratio)</b>	Rated voltage (V <sub>dc</sub> )	6.3V	10V	16V	25V	35V	50V	(at 120Hz)
	Z(-25°C)/Z(+20°C)	4	3	2	2	2	2	
	Z(-40°C)/Z(+20°C)	12	8	6	4	3	3	
<b>Endurance</b>	The following specifications shall be satisfied when the capacitors are restored to 20°C after the rated voltage is applied for 2000 hours at 105°C.							
	Rated voltage	6.3V <sub>dc</sub>			10 & 16V <sub>dc</sub>		25 to 50V <sub>dc</sub>	
	Capacitance change	≤±30% of the initial value			≤±25% of the initial value		≤±20% of the initial value	
	D.F. (tanδ)	≤300% of the initial specified value			≤300% of the initial specified value		≤200% of the initial specified value	
	Leakage current	The initial specified value			≤The initial specified value		≤The initial specified value	
<b>Shelf Life</b>	The following specifications shall be satisfied when the capacitors are restored to 20°C after exposing them for 1000 hours at 105°C without voltage applied.							
	Rated voltage	6.3V <sub>dc</sub>			10 & 16V <sub>dc</sub>		25 to 50V <sub>dc</sub>	
	Capacitance change	≤±30% of the initial value			≤±25% of the initial value		≤±20% of the initial value	
	D.F. (tanδ)	≤300% of the initial specified value			≤300% of the initial specified value		≤200% of the initial specified value	
	Leakage current	≤The initial specified value			≤The initial specified value		≤The initial specified value	

◆DIMENSIONS [mm]

●Terminal Code : A

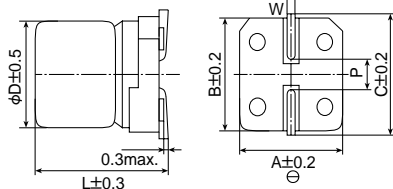

Size code	D	L	A	B	C	W	P
D60	4	5.7	4.3	4.3	5.1	0.5 to 0.8	1.0
E60	5	5.7	5.3	5.3	5.9	0.5 to 0.8	1.4
F60	6.3	5.7	6.6	6.6	7.2	0.5 to 0.8	1.9

◆PART NUMBERING SYSTEM

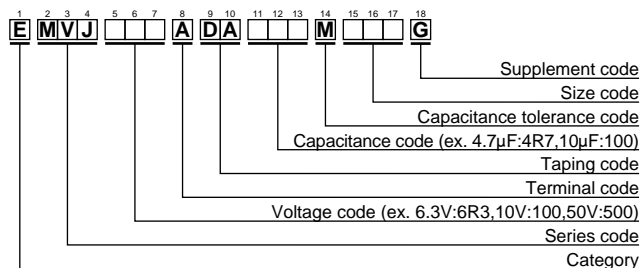

◆MARKING

EX) 6.3V100μF

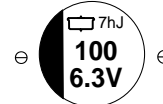

◆STANDARD RATINGS

WV (V <sub>dc</sub> )	Cap (μF)	Size code	tanδ	Rated ripple current (mArms/105°C,120Hz)	Part No.	WV (V <sub>dc</sub> )	Cap (μF)	Size code	tanδ	Rated ripple current (mArms/105°C,120Hz)	Part No.
6.3	22	D60	0.30	21	EMVJ6R3ADA220MD60G	35	22	F60	0.14	40	EMVJ350ADA220MF60G
	47	E60	0.30	36	EMVJ6R3ADA470ME60G		0.10	D60	0.12	1.3	EMVJ500ADAR10MD60G
	100	F60	0.30	56	EMVJ6R3ADA101MF60G		0.22	D60	0.12	2.6	EMVJ500ADAR22MD60G
10	33	E60	0.24	34	EMVJ100ADA330ME60G	50	0.33	D60	0.12	3.2	EMVJ500ADAR33MD60G
	10	D60	0.20	16	EMVJ160ADA100MD60G		0.47	D60	0.12	3.8	EMVJ500ADAR47MD60G
	22	E60	0.20	30	EMVJ160ADA220ME60G		1.0	D60	0.12	5.6	EMVJ500ADA1R0MD60G
47	F60	0.20	48	EMVJ160ADA470MF60G	2.2		D60	0.12	10	EMVJ500ADA2R2MD60G	
25	33	F60	0.16	45	EMVJ250ADA330MF60G		3.3	D60	0.12	14	EMVJ500ADA3R3MD60G
	4.7	D60	0.14	15	EMVJ350ADA4R7MD60G		4.7	E60	0.12	19	EMVJ500ADA4R7ME60G
35	10	E60	0.14	25	EMVJ350ADA100ME60G		10	F60	0.12	29	EMVJ500ADA100MF60G

Specifications in this bulletin are subject to change without notice.