

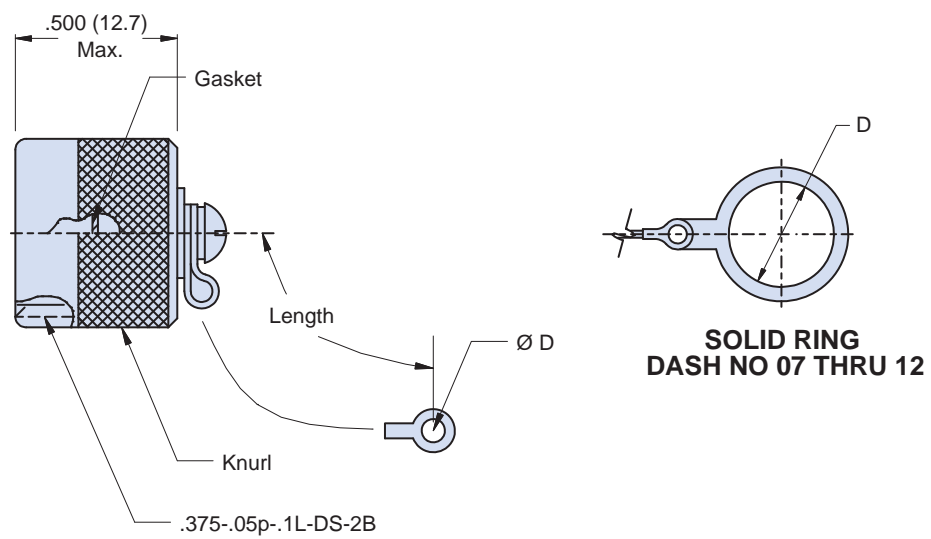

**189-047 (3) Wall-Mounting/Jam Nut  
Receptacle Protective Cover  
for Single Channel 180-071 Fiber Optic Connector**

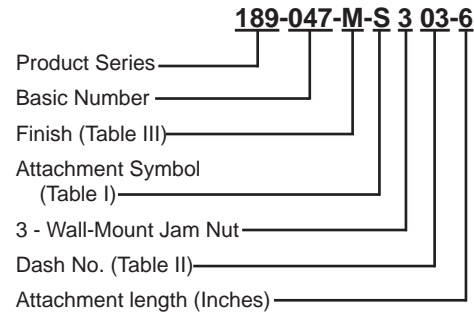

**3 - WALL MTG/JAM NUT**

**APPLICATION NOTES**

1. Assembly packaged in plastic bag and tag identified with manufacturer's name and part number.
2. Material/Finish:  
Cover: Aluminum Alloy/See Table III.  
Gasket: Fluorosilicone.  
Attachments: see Table I.
3. Metric dimensions (mm) are in parentheses.

**189-047 (3) Wall-Mounting/Jam Nut  
Receptacle Protective Cover  
for Single Channel 180-071 Fiber Optic Connector**



TABLE I: ATTACHMENT	
Sym	Attachment Type
D	Bead Chain, Cres., Passivate
F	Wire Rope with Nylon Jacket
G	Nylon Rope
H	Wire Rope with Teflon Jacket
N	No Attachment
R	Wire Rope with PVC Jacket
S	#8 Sash Chain, Cres., Passivate
T	Wire Rope, No Jacket
U	Wire Rope with Polyurethane Jacket and Terminal

TABLE II: DASH NO.	
Dash No.	D
01	.125 (3.2)
02	.140 (3.6)
03	.167 (4.2)
04	.182 (4.6)
05	.191 (4.9)
06	.197 (5.0)
07	.391 (9.9)
08	.516 (13.1)
09	.583 (14.8)
10	.766 (19.5)
11	.896 (22.8)
12	1.016 (25.8)

TABLE III: FINISH		
SYM	MATERIAL	FINISH
C	Aluminum	Black Anodize
M	Aluminum	Electroless Nickel (Coupling Nut Electrodeposited)
NF	Aluminum	Olive Drab Cadmium over Electroless Nickel
ZN	Aluminum	Zinc-Nickel/Olive Drab over Electroless Nickel
Z1	Stainless Steel	Passivate