

Tous droits strictement reserves. Reproduction ou communication a des tiers interdite sous quelque forme que ce soit sans autorisation écrite du propriétaire. Propriete de c FCI. Droits de reproduction FCI.

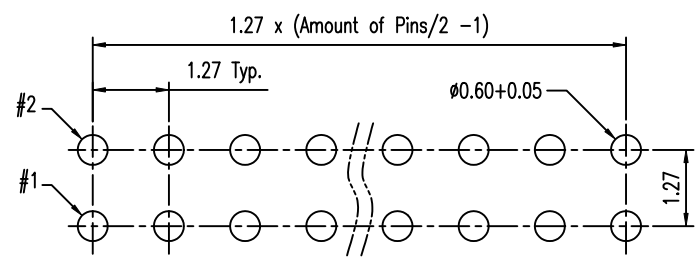

All rights strictly reserved. Reproduction or issue to third parties in any form whatever is not permitted without written authority from the proprietor. Property of FCI. Copyright FCI.

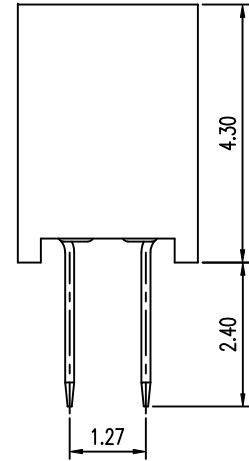
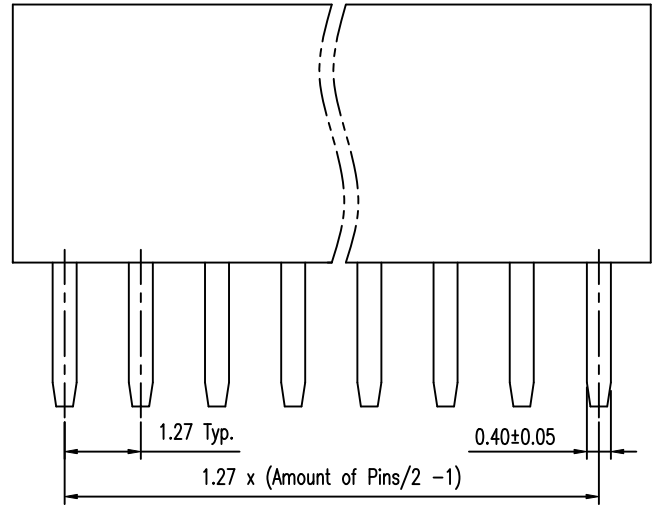
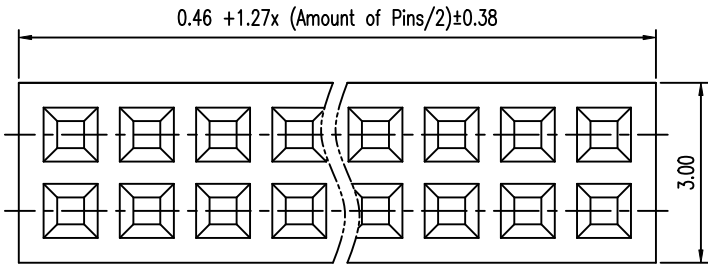

Recommended P.C.B. Layout
Layout Tolerance = ± 0.05 mm

NOTE:

- MATERIAL,
HOUSING: HIGH TEMP PLASTIC, UL94-V0
TERMINAL: COPPER ALLOY, T=0.15MM
CAP: STAINLESS STEEL, T=0.1MM
- FINISH:
TERMINAL: GOLD AT CONTACT,
G/F OVER 1.27um(50u")MIN Ni OVER ALL

- SPEC.:
PRODUCT SPEC: GS-12-629
PACKING SPEC: GS-14-1420
- THE HSG. WILL WITHSTAND EXPOSURE TO 260C PEAK TEMP. FOR 10 SEC. IN A CONVECTION, INFRA-RED OR VAPOR PHASE REFLOW OVEN.

5. PRODUCT NUMBERING:
20021311 - 0 0 0 XX X X LF

- LEAD FREE
- PLATING:
1: GOLD FLASH ALL OVER
4: 0.25um(10U")GOLD AT CONTACT
8: 0.76um(30U")GOLD AT CONTACT
- PACKING
T: TUBE
- PIN COUNT
6, 8, 10, ..., 98, A0
(EVERY EVEN PIN)

mat'l. code				tolerances unless otherwise specified		CUSTOMER COPY	FCI www.fciconnect.com	
ltr	ecn no	dr	date	linear	.X ± 0.38	projection	title	
A	T09-1117	S.LIN	09/15/09		.XX ± 0.25		1.27X1.27MM BTB RECEPTACLE VERTICAL, TH	
B	T10-0018	S.LIN	01/20/10	angles	.XXX ± 0.10	MM	product family 585	
					0° ±2°		size dwg no	
				dr	STERLING LIN 09/15/09	← MM →	code	
				enrg	STERLING LIN 09/15/09		TWN	
				chr	GARY HSIEH 09/15/09	scale	sheet	
				appd	JOSEPH HSIA 09/15/09		1 of 1	
sheet index	revision sheet	B	1			NA	A4	20021311