

**PLEASE CHECK WWW.MOLEX.COM FOR LATEST PART INFORMATION**

**Part Number:** [0353000550](#)  
**Status:** **Active**  
**Overview:** [kk](#)  
**Description:** 2.50mm (.098") Pitch Wire-to-Board KK® Header, Vertical, with Friction Ramp, Tube Packaged Version of 5045, 5 Circuits, Tin (Sn) Plating

**Documents:**

[3D Model](#) [Product Specification PS-35300-001 \(PDF\)](#)  
[Drawing \(PDF\)](#) [RoHS Certificate of Compliance \(PDF\)](#)

**Agency Certification**

CSA LR 19980  
 UL E29179

**General**

Product Family PCB Headers  
 Series [35300](#)  
 Application Wire-to-Board  
 Overview [kk](#)  
 Product Name KK®

**Physical**

Breakaway No  
 Circuits (Loaded) 5  
 Circuits (maximum) 5  
 Color - Resin Natural  
 Durability (mating cycles max) 30  
 First Mate / Last Break No  
 Flammability 94V-0  
 Glow-Wire Compliant No  
 Guide to Mating Part No  
 Keying to Mating Part None  
 Lock to Mating Part Yes  
 Material - Plating Mating Tin  
 Material - Plating Termination Tin  
 Material - Resin Nylon  
 Number of Rows 1  
 Orientation Vertical  
 PCB Locator No  
 PCB Retention None  
 PCB Thickness Recommended (in) 0.062 In  
 PCB Thickness Recommended (mm) 1.60 mm  
 Packaging Type Tube  
 Pitch - Mating Interface (in) 0.098 In  
 Pitch - Mating Interface (mm) 2.50 mm  
 Plating min: Mating (µin) 200  
 Plating min: Mating (µm) 5  
 Plating min: Termination (µin) 200  
 Plating min: Termination (µm) 5  
 Polarized to Mating Part No  
 Polarized to PCB No  
 Shrouded No  
 Stackable No  
 Surface Mount Compatible (SMC) No  
 Temperature Range - Operating -40°C to +105°C  
 Termination Interface: Style Through Hole

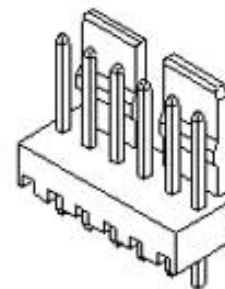

Series

image - Reference only

**EU RoHS**

**ELV and RoHS  
 Compliant**

**REACH SVHC**

**Contains SVHC: No**

**Halogen-Free**

**Status**

**Not Halogen-Free**

**Need more information on product  
 environmental compliance?**

Email [productcompliance@molex.com](mailto:productcompliance@molex.com)  
 For a multiple part number RoHS Certificate of Compliance, [click here](#)

Please visit the [Contact Us](#) section for any non-product compliance questions.

**China RoHS**

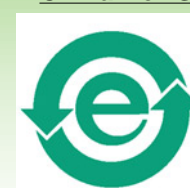

**Search Parts in this Series**

[35300Series](#)

**Mates With**

[5051 Housing](#), [51191 Housing](#)

**Electrical**

Current - Maximum per Contact

3A

Voltage - Maximum

250V

**Material Info****Reference - Drawing Numbers**

Packaging Specification

PK-35300-001

Product Specification

PS-35300-001

Sales Drawing

SD-35300-001, SD-35300-010

This document was generated on 05/24/2010

**PLEASE CHECK [WWW.MOLEX.COM](http://WWW.MOLEX.COM) FOR LATEST PART INFORMATION**

DWG. NO.  
SD-35300-001

SIMILAR ITEM

PROJECT NO.

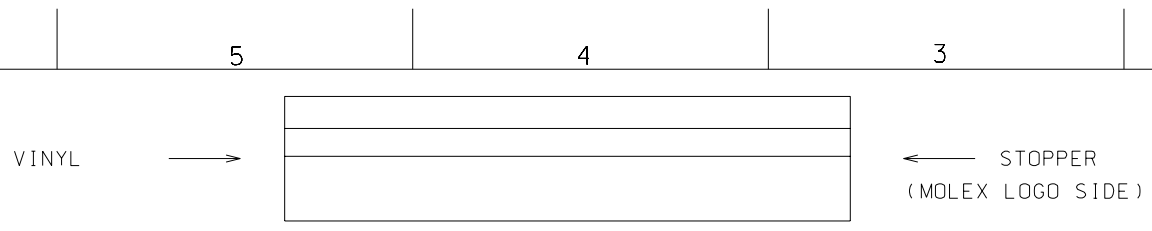

NOTES

1. TUBE : STOPPER & VINYL LOCKING TYPE
2. THICKNESS : 0.6 †
3. LENGTH : 540mm

LEGEND

35300- \*\* 5 \*  
 COLOR : 0 --- NATURAL  
 2 --- RED  
 CKT (02, 03, 04, ....)

5045-NA SERIES

TUBE

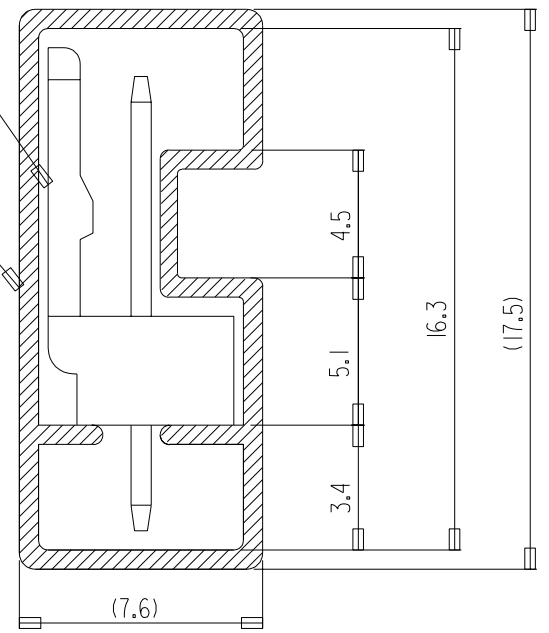

15	35300-155*	35300155*	5045-NA SERIES	
14	-145*	35300145*		
13	-135*	35300135*		
12	-125*	35300125*		
11	-115*	35300115*		
10	-105*	35300105*		
9	-095*	35300095*		
8	-085*	35300085*		
7	-075*	35300075*		
6	-065*	35300065*		
5	-055*	35300055*		
4	-045*	35300045*		
3	-035*	35300035*		
2	35300-025*	35300025*		USED
CKTS	ENG NO.	MAT'L NO.		ON.

NEW RELEASED EC NO. KOR2004-0124 DRWN: K.S.KIM (040324) CHK: J.K.OH APPR: C.W.LEE	DESCRIPTION MAJOR CRITICAL C	GENERAL TOLERANCES: (UNLESS SPECIFIED)		SCALE NONE	DESIGN UNITS <input checked="" type="checkbox"/> mm <input type="checkbox"/> INCH	<input type="checkbox"/> mm <input type="checkbox"/> INCH <input type="checkbox"/> mm ONLY	THIRD ANGLE PROJECTION	DIMENSIONS: <input type="checkbox"/> mm <input type="checkbox"/> INCH <input type="checkbox"/> mm <input type="checkbox"/> INCH	SHT REV
		4 PLACES ±0.    ±.	DRAWN BY & DATE H.S.SHIN (910120)	TITLE: TUBE PACKAGED FOR 5045-NA SERIES					
		3 PLACES ±0.    ±.	CHECKED BY & DATE J.K.OH						
		2 PLACES ±0.    ±.	APPROVED BY & DATE C.W.LEE	MOLEX INCORPORATED					
1 PLACE ±0.    ±.	CAD FILENAME SD-35300-001.dgn	MATERIAL NO. SEE TABLE	DRAWING NO. SD-35300-001				SHEET NO. 1 OF 1		
ANGULAR: ±    °	DRAFT WHERE APPLICABLE MUST REMAIN WITHIN DIMENSIONS				THIS DRAWING CONTAINS INFORMATION THAT IS PROPRIETARY TO MOLEX INCORPORATED AND SHOULD NOT BE USED WITHOUT WRITTEN PERMISSION.				SIZE A

5

4

3

2

MX-A4

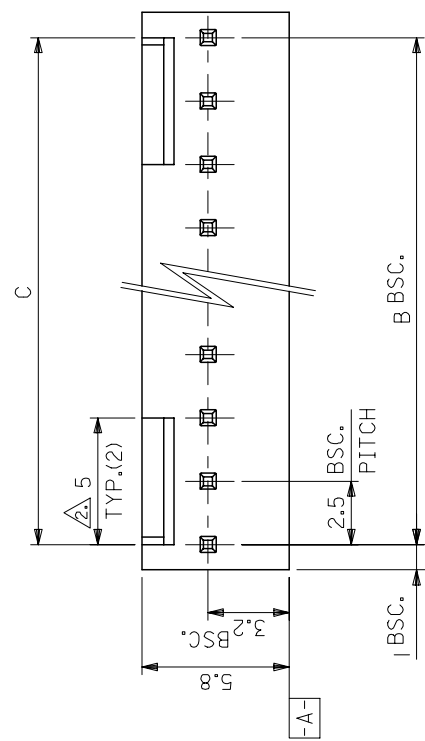

NOTE.

1. MATERIAL  
PIN: 0.635x14.2 BRASS TIN OVER COPPER PLATING.  
WAFER: NYLON66, UL94V-0  
TO BE APPLIED FOR 6 CKT. AND MORE THEN 6 CKT.  
3. NO SLIT IS PROVIDED FOR 5 CKT. AND LESS THAN 5 CKT.

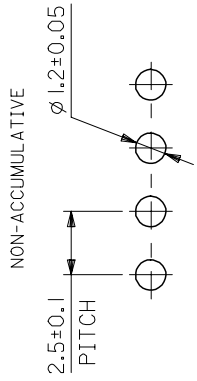

RECOMMENDED P.C. BOARD HOLE DIM.

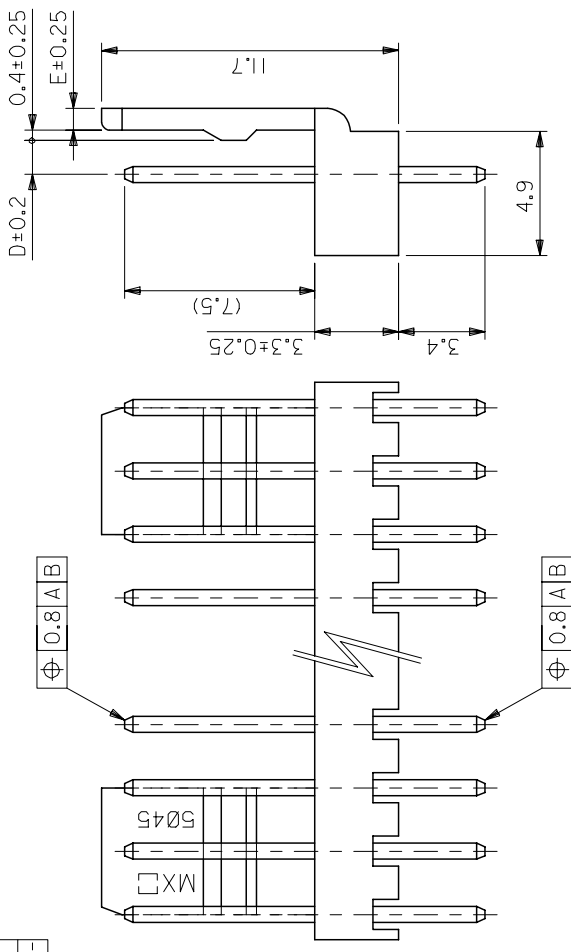

DO NOT SCALE DRAWING  
DIMENSION IN METRIC

NEW RELEASED	DESCRIPTION	REV
ECN NO. KOR2006-0082	DRWN: K.S.KIM (060102)	A
CHK: Y.SOOKIM	APP: S.H.CHOI	REV

QUALITY SYMBOLS	MAJOR	CRITICAL
4 PLACES ±0.	±.	±.
3 PLACES ±0.	±.	±.
2 PLACES ±0.	±.	±.
1 PLACE ±0.	±.	±.

GENERAL TOLERANCES: (UNLESS SPECIFIED)	MM	INCH
ANGULAR: ±	°	
DRAFT WHERE APPLICABLE MUST REMAIN WITHIN DIMENSIONS		

SCALE	DESIGN UNITS	THIRD ANGLE PROJECTION	TITLE:
5:1	MM/INCH	<input type="checkbox"/> INCH <input checked="" type="checkbox"/> MM	KK 2.5 WAFER ASSY WITH LOCK
DRAWN BY & DATE	CHECKED BY & DATE	APPROVED BY & DATE	
K.S.KIM (060102)	Y.SOOKIM	S.H.CHOI	
CAD FILENAME	MATERIAL NO.	DRAWING NO.	
		SD-35300-010	

MOLEX INCORPORATED		SHEET NO.
KOREA		1 OF 1
Korea		SIZE
KOREA		B

PROJECT NO.	C	B	A	DIMENSIONS:		SHT	REV
				MM	INCH		
1.35	0.85	35	22-04-1151	5045-15A	35300-1550	15	
		32.5	-1141	-14A	35300-1450	14	
		30	-1131	-13A	35300-1350	13	
		27.5	-1121	-12A	35300-1250	12	
		25	-1111	-11A	35300-1150	11	
		22.5	-1101	-10A	35300-1050	10	
		20	-1091	-09A	35300-0950	9	
		17.5	-1081	-08A	35300-0850	8	
		15	-1071	-07A	35300-0750	7	
		12.5	-1061	-06A	35300-0650	6	
		10	-1051	-05A	35300-0550	5	
1.35	0.85	7.5	-1041	-04A	35300-0450	4	
1.2	1	5	-1031	-03A	35300-0350	3	
1.2	1	2.5	22-04-1021	5045-02A	35300-0250	2	
D	E	C	EDP.NO.	ENG.NO.	ENG NO.	CKT.	
				APPLIED CONNECTOR			