

PLEASE CHECK WWW.MOLEX.COM FOR LATEST PART INFORMATION

Part Number: [0365150242](#)
Status: **Active**
Overview: [din_41612](#)
Description: 2.54mm (.100") Pitch DIN 41612 R Style Male Header with Wire-Wrap, Vertical, Through Hole Press-Fit, 0.60µm (24µ") Selective Gold (Au) Plating, 64 Circuits, without Mounting Clips, No First-Mate-Last-Break, Soldertail Length 13.25mm(.522"), 1.25µm (50µ") N

Documents:

[Drawing \(PDF\)](#) [RoHS Certificate of Compliance \(PDF\)](#)
[Product Specification PS-36515-001 \(PDF\)](#)

General

| | |
|----------------|--|
| Product Family | Backplane Connectors |
| Series | 36515 |
| Application | Backplane |
| Comments | No Mounting Clips, Secured with Tubular Rivets/ Cheesehead Screws. No First-Mate-Last-Break |
| Component Type | PCB Header |
| Overview | din_41612 |
| Product Name | IEC 603-2/DIN 41612 |
| Style | R |

Physical

| | |
|--------------------------------|------------------|
| Circuits (Loaded) | 64 |
| Circuits (maximum) | 64 |
| Circuits Detail | 1,2,3,...32; a+c |
| Color - Resin | Gray |
| Durability (mating cycles max) | 400 |
| First Mate / Last Break | No |
| Guide to Mating Part | No |
| Keying to Mating Part | Yes |
| Material - Metal | Phosphor Bronze |
| Material - Plating Mating | Gold |
| Material - Plating Termination | Nickel |
| Material - Resin | Polyester |
| Number of Columns | 32 |
| Number of Pairs | Open Pin Field |
| Number of Rows | 2 |
| Orientation | Vertical |
| PC Tail Length (in) | 0.522 In |
| PC Tail Length (mm) | 13.25 mm |
| PCB Locator | No |
| PCB Retention | Yes |
| PCB Thickness Recommended (in) | 0.063 In |
| PCB Thickness Recommended (mm) | 1.60 mm |
| Packaging Type | Carton |
| Pitch - Mating Interface (in) | 0.100 In |
| Pitch - Mating Interface (mm) | 2.54 mm |
| Pitch - Term. Interface (in) | 0.100 In |
| Pitch - Term. Interface (mm) | 2.54 mm |
| Plating min: Mating (µin) | 24 |
| Plating min: Mating (µm) | 0.60 |
| Plating min: Termination (µin) | 49 |
| Plating min: Termination (µm) | 1.25 |
| Polarized to PCB | No |

EU RoHS

**ELV and RoHS
Compliant**

REACH SVHC

Not Reviewed

**Halogen-Free
Status**

Not Reviewed

China RoHS



**Need more information on product
environmental compliance?**

Email productcompliance@molex.com
 For a multiple part number RoHS Certificate of Compliance, [click here](#)

Please visit the [Contact Us](#) section for any non-product compliance questions.

Search Parts in this Series

[36515Series](#)

| | |
|--------------------------------|---|
| Stackable | No |
| Surface Mount Compatible (SMC) | No |
| Temperature Range - Operating | -55°C to +125°C |
| Termination Interface: Style | Through Hole - Compliant Pin, Wire Wrap |

Electrical

| | |
|-------------------------------|---------------|
| Current - Maximum per Contact | 1A |
| Data Rate | 622.0 Mbps |
| Voltage - Maximum | 250V AC (RMS) |

Material Info

Reference - Drawing Numbers

| | |
|-----------------------|--------------|
| Product Specification | PS-36515-001 |
| Sales Drawing | SD-36515-011 |

This document was generated on 05/13/2010

PLEASE CHECK WWW.MOLEX.COM FOR LATEST PART INFORMATION

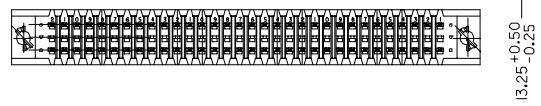
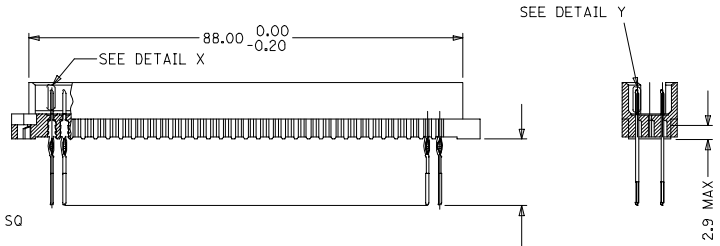
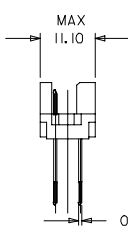
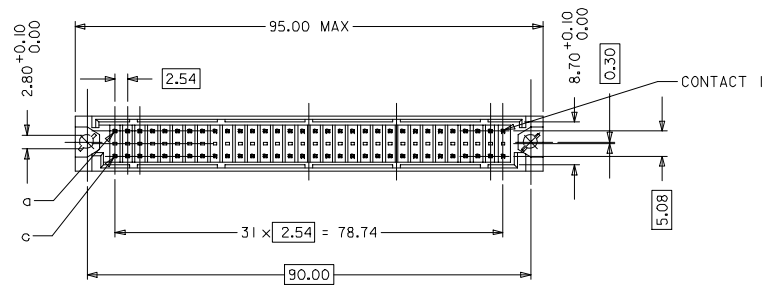

WITH MOUNTING CLIPS

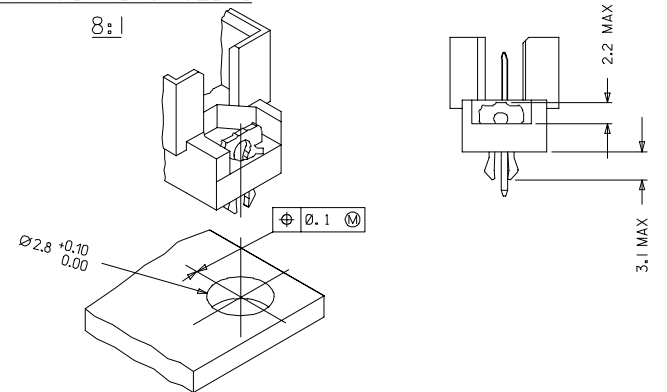

- NOTES:
- MATERIALS: THERMOPLASTIC POLYESTER, GLASS FILLED, UL94V-0, COLOUR: PEBBLE GREY RAL 7032
 TERMINAL - PHOSPHOR BRONZE
 MOUNTING CLIP: STEEL
 - FINISH: TERMINAL:-
 CONTACT AREA
 - PERFORMANCE LEVEL 1: SELECTIVE GOLD (Au), THICKNESS = 1.1 MICROMETER OVER NICKEL, THICKNESS = 1.25 MICROMETER MIN
 PERFORMANCE LEVEL 2: SELECTIVE GOLD (Au), THICKNESS = 0.6 MICROMETER OVER NICKEL, THICKNESS = 1.25 MICROMETER MIN
 PERFORMANCE LEVEL 3: SELECTIVE GOLD (Au), THICKNESS = 0.3 MICROMETER OVER NICKEL, THICKNESS = 1.25 MICROMETER MIN
 PRESS-IN AREA : NICKEL, THICKNESS = 1.25 MICROMETER MIN OVERALL
 WRAP AREA : NICKEL, THICKNESS = 1.25 MICROMETER MIN OVERALL
 ADAPTER INSERTION AREA : PERFORMANCE LEVEL 3: SELECTIVE GOLD (Au), THICKNESS = 0.3 MICROMETER OVER NICKEL, THICKNESS = 1.25 MICROMETER MIN
 - MOUNTING CLIP:-
 TIN (Sn), THICKNESS = 5-10 MICROMETER,
 OVER NICKEL (Ni), THICKNESS = 2.5 MICROMETER
 - FOR NON MOUNTING CLIP OPTION, CONNECTOR TO BE SECURED WITH RIVETS: 2 TUBULAR RIVETS 2.5 x 0.3 ... DIN 7340
 SCREWS: 2 CHEESEHEAD SCREWS M2.5 x ... DIN 84 AND 2 HEXAGONAL NUTS M2.5 DIN 934
 - MATERIAL NUMBER, BATCH CODE, UL AND CSA MARKING TO BE PRINTED ON THE CONNECTOR
 - CUT FACE OF TIP WITHOUT PLATING PERMITTED
 - PRODUCT SPECIFICATION PS-36515-001

RECOMMENDED PCB LAYOUT
COMPONENT SIDE

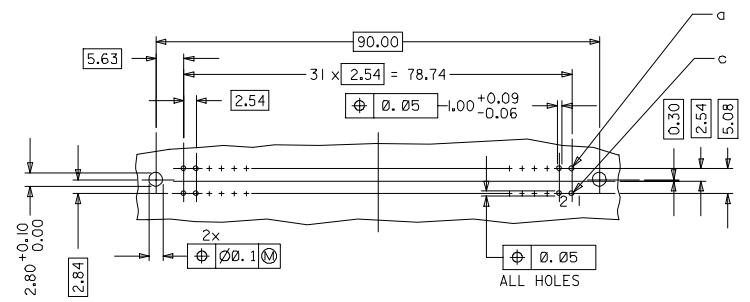

RoHS COMPLIANT

| | | | | | | | | | |
|---|-------------------------------|---|-----------------------|----------------------------|------------------------------|--------------------|------------------------|------------------------|--------------------|
| EC No: P2007-0044 DRAWING APPROVED 2006/10/10 CHECKED BY 2006/10/10 APPROVED BY 2006/10/10 | QUALITY SYMBOLS ▽=0 ▽=0 | GENERAL TOLERANCES (UNLESS SPECIFIED) | | DIMENSION STYLE MM ONLY | | SCALE 2:1 | DESIGN UNITS METRIC | THIRD ANGLE PROJECTION | |
| | | 4 PLACES ± 0.15 ± --- | 3 PLACES ± 0.05 ± --- | 2 PLACES ± 0.1 ± --- | 1 PLACE ± 0.15 ± --- | DRAWN BY SS | DATE 1999/09/24 | CHECKED BY G J LOWE | DATE 1999/09/24 |
| REV C1 | DESCRIPTION | DRAFT WHERE APPLICABLE MUST REMAIN WITHIN DIMENSIONS | | MATERIAL NO. SEE CHART | DOCUMENT NO. SD-36515-011 | MOLEX INCORPORATED | | SHEET NO. 1 OF 2 | |
| | | THIS DRAWING CONTAINS INFORMATION THAT IS PROPRIETARY TO MOLEX INCORPORATED AND SHOULD NOT BE USED WITHOUT WRITTEN PERMISSION | | | | | | | |

| MATERIAL No. | MOLEX ENG No. | PERF LEVEL | PLATING | CONTACT SEQUENCE/ROW | DIM "L" MM | MOUNTING CLIP | FMLB |
|--------------|---------------|------------|---------|----------------------|------------|---------------|-------------|
| 36515-0241 | MM-B1466-R963 | 1 | Au + Ni | 1,2,3...32 a+c | 13.25 | NO | NO |
| 36515-0242 | MM-B1566-R963 | 2 | Au + Ni | 1,2,3...32 a+c | 13.25 | NO | NO |
| 36515-0243 | MM-B1666-R963 | 3 | Au + Ni | 1,2,3...32 a+c | 13.25 | NO | NO |
| 36515-0247 | MM-B1466-R913 | 1 | Au + Ni | 1,2,3...32 a+c | 13.25 | YES | NO |
| 36515-0248 | MM-B1566-R913 | 2 | Au + Ni | 1,2,3...32 a+c | 13.25 | YES | NO |
| 36515-0249 | MM-B1666-R913 | 3 | Au + Ni | 1,2,3...32 a+c | 13.25 | YES | NO |
| 36515-0253 | MM-B1466-R933 | 1 | Au + Ni | 1,2,3...32 a+c | 13.25 | NO | 1,32a 1,32c |
| 36515-0254 | MM-B1566-R933 | 2 | Au + Ni | 1,2,3...32 a+c | 13.25 | NO | 1,32a 1,32c |
| 36515-0255 | MM-B1666-R933 | 3 | Au + Ni | 1,2,3...32 a+c | 13.25 | NO | 1,32a 1,32c |
| 36515-0259 | MM-B1466-R953 | 1 | Au + Ni | 1,2,3...32 a+c | 13.25 | YES | 1,32a 1,32c |
| 36515-0260 | MM-B1566-R953 | 2 | Au + Ni | 1,2,3...32 a+c | 13.25 | YES | 1,32a 1,32c |
| 36515-0261 | MM-B1666-R953 | 3 | Au + Ni | 1,2,3...32 a+c | 13.25 | YES | 1,32a 1,32c |

DETAILY DETAILX

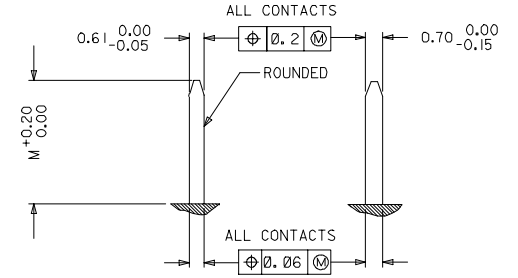

| | |
|---------------------|-----|
| PRE MATING CONTACTS | 5.4 |
| NORMAL CONTACTS | 4.8 |
| | M |

RoHS COMPLIANT

| EC No: 2007/0044 DRAWING APPROVED 2006/10/10 CHECKED BY: CHIKKOSUDHAR 2006/10/11 APPROVED BY: APPR:SSUDHAR 2006/10/10 | QUALITY SYMBOLS | GENERAL TOLERANCES (UNLESS SPECIFIED) <table border="1"> <tr> <th></th> <th>mm</th> <th>INCH</th> </tr> <tr> <td>4 PLACES</td> <td>± 0.15</td> <td>± 0.006</td> </tr> <tr> <td>3 PLACES</td> <td>± 0.05</td> <td>± 0.002</td> </tr> <tr> <td>2 PLACES</td> <td>± 0.1</td> <td>± 0.004</td> </tr> <tr> <td>1 PLACE</td> <td>± 0.15</td> <td>± 0.006</td> </tr> </table> | | mm | INCH | 4 PLACES | ± 0.15 | ± 0.006 | 3 PLACES | ± 0.05 | ± 0.002 | 2 PLACES | ± 0.1 | ± 0.004 | 1 PLACE | ± 0.15 | ± 0.006 | DIMENSION STYLE MM ONLY | SCALE 2:1 | DESIGN UNITS METRIC | THIRD ANGLE PROJECTION |
|--|----------------------------|---|---|--|---------------------------|------------------------------|---------------------|---------|----------|--------|---------|----------|-------|---------|---------|--------|---------|----------------------------|--------------|------------------------|------------------------|
| | | mm | INCH | | | | | | | | | | | | | | | | | | |
| 4 PLACES | ± 0.15 | ± 0.006 | | | | | | | | | | | | | | | | | | | |
| 3 PLACES | ± 0.05 | ± 0.002 | | | | | | | | | | | | | | | | | | | |
| 2 PLACES | ± 0.1 | ± 0.004 | | | | | | | | | | | | | | | | | | | |
| 1 PLACE | ± 0.15 | ± 0.006 | | | | | | | | | | | | | | | | | | | |
| DRAFT WHERE APPLICABLE MUST REMAIN WITHIN DIMENSIONS | DIMENSION STYLE MM ONLY | SCALE 2:1 | DRAWN BY: SS DATE: 1999/09/24 CHECKED BY: GJLOWE DATE: 1999/09/24 APPROVED BY: GJLOWE DATE: 1999/09/24 | TITLE ASSY, DIN 41612, R MALE 64P A+C LOADED, PRESS-IN | MATERIAL NO. SEE CHART | DOCUMENT NO. SD-36515-011 | SHEET NO. 2 OF 2 | | | | | | | | | | | | | | |