

PLEASE CHECK WWW.MOLEX.COM FOR LATEST PART INFORMATION

Part Number: [0955032441](#)
Status: **Active**
Overview: [modular_plugs_jacks](#)
Description: 4/4 JACK THROUGH HOLE NO KEY VERSION

Documents:

| | |
|---|--|
| 3D Model | Product Specification PS-95503-001 (PDF) |
| Drawing (PDF) | RoHS Certificate of Compliance (PDF) |
| Application Specification (PDF) | |

Agency Certification

| | |
|----|---------|
| UL | E107635 |
|----|---------|

General

| | |
|---------------------------|-------------------------------------|
| Product Family | Modular Jacks/Plugs |
| Series | 95503 |
| Component Type | PCB Jack |
| Magnetic | No |
| Overview | modular_plugs_jacks |
| Performance Category | 3 |
| Power over Ethernet (PoE) | N/A |
| Product Name | RJ11 |

Physical

| | |
|--------------------------------|--------------------------------|
| Boot Color | N/A |
| Color - Resin | Black |
| Durability (mating cycles max) | 1,000 |
| Flammability | 94V-0 |
| Inverted / Top Latch | No |
| Lightpipes/LEDs | None |
| Material - Metal | Brass |
| Material - Plating Mating | Gold |
| Material - Plating Termination | Tin |
| Material - Resin | High Temperature Thermoplastic |
| Orientation | Vertical (Top Entry) |
| PCB Locator | Yes |
| PCB Retention | Yes |
| PCB Thickness Recommended (in) | 0.062 In |
| PCB Thickness Recommended (mm) | 1.57 mm |
| Packaging Type | Tray |
| Pitch - Mating Interface (in) | 0.040 In |
| Pitch - Mating Interface (mm) | 1.02 mm |
| Pitch - Term. Interface (in) | 0.050 In |
| Pitch - Term. Interface (mm) | 1.27 mm |
| Plating min: Mating (µin) | 50.8 |
| Plating min: Mating (µm) | 1.27 |
| Plating min: Termination (µin) | 76 |
| Plating min: Termination (µm) | 1.9 |
| Ports | 1 |
| Positions / Loaded Contacts | 4/4 |
| Surface Mount Compatible (SMC) | Yes |
| Temperature Range - Operating | -40°C to +80°C |
| Termination Interface: Style | Through Hole |
| Waterproof / Dustproof | No |
| Wire/Cable Type | N/A |

EU RoHS

**ELV and RoHS
Compliant**
**REACH SVHC
Contains SVHC: No**
**Halogen-Free
Status**
Halogen-Free

China RoHS



**Need more information on product
environmental compliance?**

Email productcompliance@molex.com
 For a multiple part number RoHS Certificate of
 Compliance, [click here](#)

Please visit the [Contact Us](#) section for any
 non-product compliance questions.

Search Parts in this Series

[95503Series](#)

Mates With

FCC 68 Plugs

Electrical

| | |
|-------------------------------|---------|
| Current - Maximum per Contact | 1.5A |
| Shielded | No |
| Voltage - Maximum | 125V DC |

Solder Process Data

| | |
|--|------------------------|
| Duration at Max. Process Temperature (seconds) | 5 |
| Lead-free Process Capability | Wave Capable (TH only) |
| Max. Cycles at Max. Process Temperature | 1 |
| Process Temperature max. C | 260 |

Material Info**Reference - Drawing Numbers**

| | |
|-------------------------|--------------|
| Packaging Specification | PK-95003 |
| Product Specification | PS-95503-001 |
| Sales Drawing | SD-95503-003 |
| Test Summary | STR-1181 |

This document was generated on 06/07/2010

PLEASE CHECK WWW.MOLEX.COM FOR LATEST PART INFORMATION

NOTES :

1- MATERIAL:

- HOUSING: LCP FIBER GLASS FILLED UL 94-V0
COLOR BLACK.
- TERMINAL: TIN BRASS.

PLATING 2:

POST PLATE (0.00127-0.00152)/.000050-.000060 GOLD IN CONTACT AREA. (0.00190)/.000075 MIN. PURE TIN IN TAIL AREA BOTH OVER (0.00127)/.000050 MIN. NICKEL OVERALL.

PLATING 7: ONLY ON REQUEST

POST PLATE 0.00005/.000002 MIN GOLD OVER 0.000763 .000030 MIN PALLADIUM NICKEL IN CONTACT AREA. 0.00190/.000075 MIN PURE TIN IN TAIL AREA. BOTH OVER 0.00127/.000050 MIN NICKEL OVERALL:

2- JACK FOR MATING WITH F.C.C. 68 PLUGS
90075 MOLEX SERIES.

3- PRODUCT SPECIFICATION PS-95503-001

4- PACKAGING SPECIFICATION PK-95003:

- STANDARD PACKAGING SHEET 1.
- TUBE PACKAGING FOR SMT VERSION SHEET 2.
- TUBE PACKAGING FOR THROUGH HOLE VERSION SHEET 3.

5- MANUFACTURING I.D. CAN BE MXF, MG OR MXI.

| TYPE \ DIM. | POS. 4 | POS. 6 | | POS. 8 |
|-------------|----------------|----------------|----------------|----------------|
| | 4 CKTS. | 4 CKTS. | 6 CKTS. | 8 CKTS. |
| A | (11.18) / .440 | (13.21) / .520 | (13.21) / .520 | (15.24) / .600 |
| B | (7.62) / .300 | (10.16) / .400 | (10.16) / .400 | (11.43) / .450 |
| D | (3.81) / .150 | (3.81) / .150 | (6.35) / .250 | (8.89) / .350 |

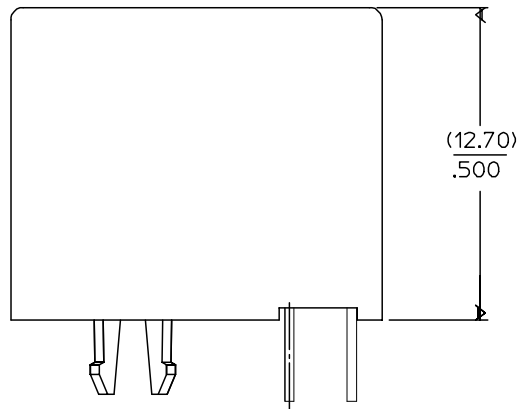

SHORT VERSION

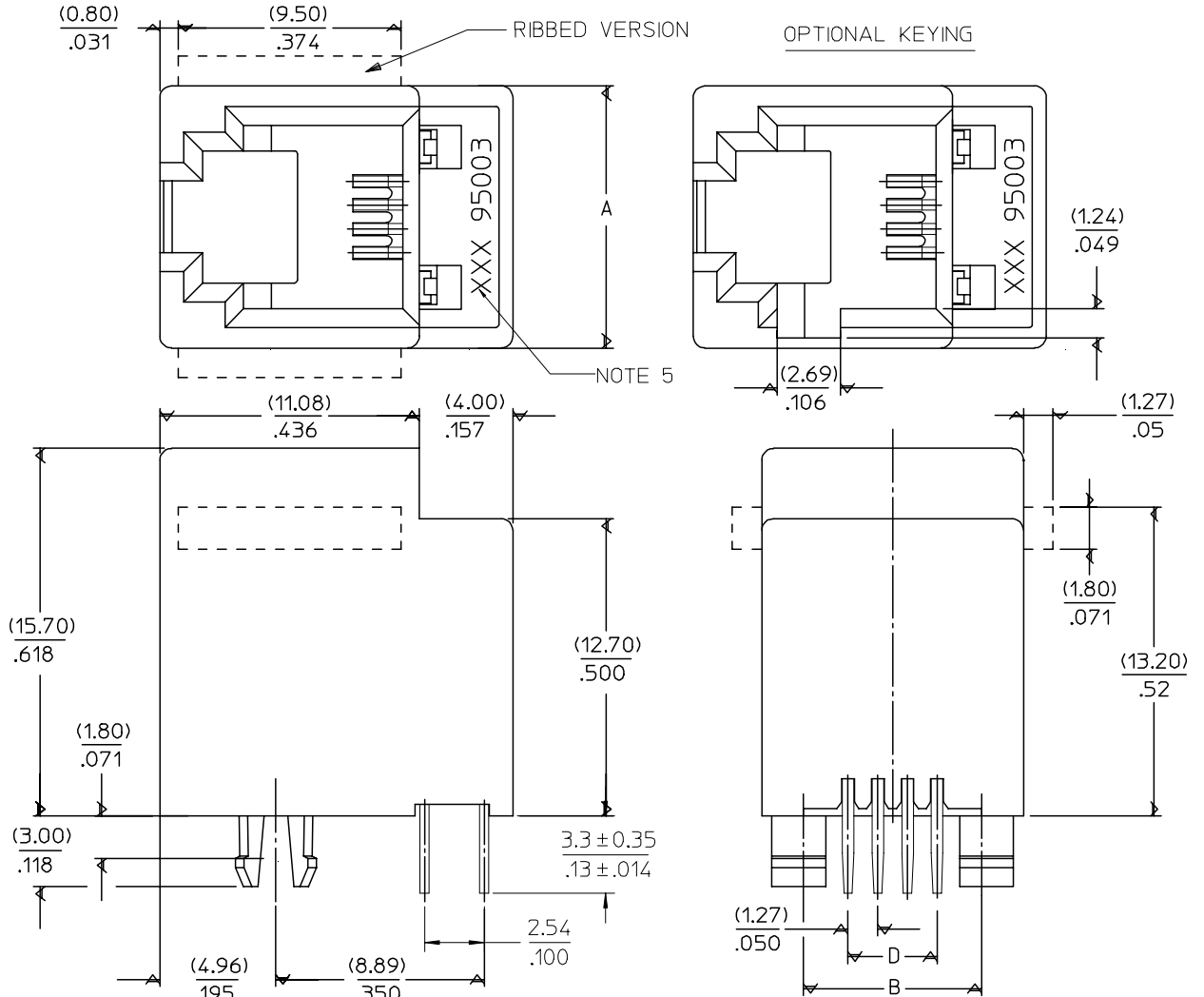

| | | | | | |
|---|---|---|---|--|--|
| ADDED TABLE EC NO: E2008-0267 DRWN: DBRYNES CHKD: APPR: EOMAHONY 2007/11/27 2007/11/28 2007/11/28 | QUALITY SYMBOLS ▽=0 ▽=0 | GENERAL TOLERANCES (UNLESS SPECIFIED) mm INCH 4 PLACES ± --- ± --- 3 PLACES ± --- ± .006 2 PLACES ± 0.15 ± .010 1 PLACE ± 0.25 ± --- ANGULAR ± .5 ° | DIMENSION STYLE MM/IN DRAWN BY DATE TMARTIN 2005/06/15 CHECKED BY DATE FCARABETTA 2005/06/15 APPROVED BY DATE KNOLLER 2005/06/15 | SCALE 5:1 DESIGN UNITS METRIC THIRD ANGLE PROJECTION | TITLE LOW PROFILE TOP ENTRY JACK (THROUGH HOLE VERSION) MOLEX INCORPORATED |
| | DRAFT WHERE APPLICABLE MUST REMAIN WITHIN DIMENSIONS | MATERIAL NO. SEE SHT 4,5 | DOCUMENT NO. SD-95503-003 | SHEET NO. 1 OF 5 | |
| | THIS DRAWING CONTAINS INFORMATION THAT IS PROPRIETARY TO MOLEX INCORPORATED AND SHOULD NOT BE USED WITHOUT WRITTEN PERMISSION | | | | |
| | SIZE A3 | | | | |

| TYPE DIM. | POS. 4 | POS. 6 | | POS. 8 |
|-------------------------------|---------------|----------------|----------------|----------------|
| | 4 CKTS. | 4 CKTS. | 6 CKTS. | 8 CKTS. |
| F (± 0.05)/ ± 0.002 | (7.62) / .300 | (10.16) / .400 | (10.16) / .400 | (11.43) / .450 |
| G (± 0.05)/ ± 0.002 | (3.81) / .150 | (3.81) / .150 | (6.35) / .250 | (8.89) / .350 |

P.C.B MOUNTING PATTERNS - SEEN FROM COMPONENT SIDE

FOR SMT JACK (SURFACE MOUNT)

FOR STANDARD JACK (THROUGH HOLE)

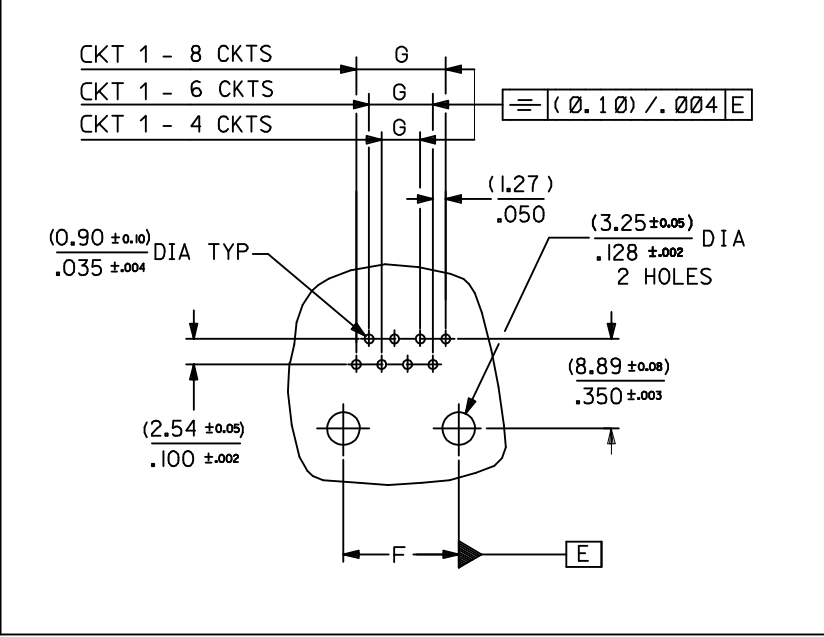
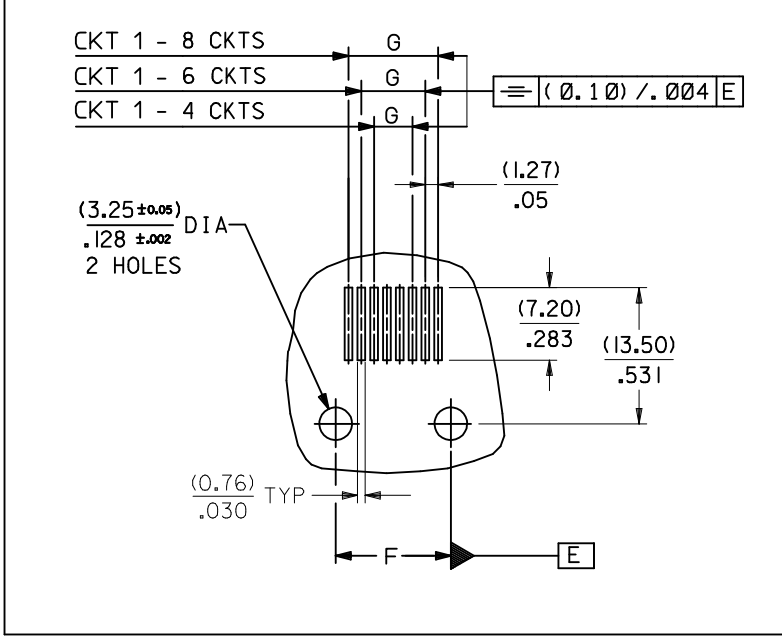

| | | |
|--|-----------------|-------------|
| ARDED CKT 1 EC NO: E2010-0075 DRWN: DBYRNES 2009/08/13 CHKD: 2009/08/19 APPR: J WALLACE 2009/08/19 | QUALITY SYMBOLS | DESCRIPTION |
| | $\nabla = 0$ | |
| | $\square = 0$ | |
| | REV | |

| | |
|--|-----------------------|
| GENERAL TOLERANCES (UNLESS SPECIFIED) | DIMENSION STYLE |
| mm INCH | MM/IN |
| 4 PLACES \pm --- \pm --- | DRAWN BY DATE |
| 3 PLACES \pm --- \pm .006 | T MARTIN 2005/06/15 |
| 2 PLACES \pm 0.15 \pm .010 | CHECKED BY DATE |
| 1 PLACE \pm 0.25 \pm --- | FCARABETTA 2005/06/15 |
| ANGULAR \pm .5 ° | APPROVED BY DATE |
| | KNOLLER 2005/06/15 |
| DRAFT WHERE APPLICABLE MUST REMAIN WITHIN DIMENSIONS | MATERIAL NO. |
| | SEE SHT. 4, 5 |

| | | |
|----------------------|--------------|------------------------|
| SCALE | DESIGN UNITS | THIRD ANGLE PROJECTION |
| 1:1 | METRIC | |
| TITLE | | |
| LOW PROFILE T/E JACK | | |
| MATERIAL NO. | | |
| SD-95503-003 | | |
| DOCUMENT NO. | | |
| SD-95503-003 | | |
| SHEET NO. | | |
| 3 OF 5 | | |

| | | | |
|---|--|--------------|--|
| MATERIAL NO. | | DOCUMENT NO. | |
| SEE SHT. 4, 5 | | SD-95503-003 | |
| SHEET NO. | | 3 OF 5 | |
| THIS DRAWING CONTAINS INFORMATION THAT IS PROPRIETARY TO MOLEX INCORPORATED AND SHOULD NOT BE USED WITHOUT WRITTEN PERMISSION | | | |

TRAY PACKAGING, SEE PACKAGING SPEC PK95003 SHEET 1

| HOUSING SIZE | LOADED CONTACTS | PLATING | PART NO FOR JACK ASSEMBLY THROUGH HOLE STANDARD VERSION | | | | | PART NO FOR JACK ASSEMBLY THROUGH HOLE SHORT VERSION | | | | | | |
|--------------|-----------------|---------|---|--------|------------|--------|--------|--|------------|-----|--------|--------|--|--|
| | | | LCP FIBER GLASS FILLED 94V0 COLOR BLACK | | | | | LCP FIBER GLASS FILLED 94V0 COLOR BLACK | | | | | | |
| | | | NO KEY | TOOLED | KEY | TOOLED | TOOLED | NO KEY | TOOLED | KEY | TOOLED | TOOLED | | |
| NO RIB | TOOLED | NO RIB | TOOLED | TOOLED | NO RIB | TOOLED | NO RIB | TOOLED | TOOLED | | | | | |
| 4 | 4 | 2 | 95503-2441 | X | | | | | | | | | | |
| 6 | 4 | 2 | 95503-2641 | X | | | | | | | | | | |
| 6 | 6 | 2 | 95503-2661 | X | | | | | | | | | | |
| 8 | 8 | 2 | 95503-2881 | X | 95503-2882 | X | | | 95503-2884 | X | | | | |

| | |
|------------|---|
| TOOLED | X |
| NOT TOOLED | |

| | | | | | | | | | | | |
|---|--|--------------------|-------------------------------|---------------------------------------|--------------------|--------------------------|--------------------|---------------------------|---|------------------------|--|
| CORRECTED PART #'s EC NO: E2007-0482 DRWN: DBYRNES CHKD: APPR: EOMAHONY | 2007/01/08 2007/01/08 2007/01/09 | DESCRIPTION REV | QUALITY SYMBOLS ▽=0 ◻=0 | GENERAL TOLERANCES (UNLESS SPECIFIED) | | DIMENSION STYLE MM/IN | | SCALE --- | DESIGN UNITS METRIC | THIRD ANGLE PROJECTION | |
| | | | | | mm | INCH | DRAWN BY DATE | | TITLE | | |
| | | | | 4 PLACES | ±--- | ±--- | TMARTIN 2005/06/16 | | LOW PROFILE T/E JACK THROUGH HOLE VERS. | | |
| | | | | 3 PLACES | ±--- | ±--- | CHECKED BY DATE | | | | |
| 2 PLACES | ±--- | ±--- | FCARABETTA 2005/06/16 | | MOLEX INCORPORATED | | | | | | |
| 1 PLACE | ±--- | ±--- | APPROVED BY DATE | | | | | | | | |
| | | | ANGULAR | ±---- | ° | KNOLLER 2005/06/16 | | MATERIAL NO. DOCUMENT NO. | | SHEET NO. | |
| DRAFT WHERE APPLICABLE MUST REMAIN WITHIN DIMENSIONS | | | | SEE CHART | | SD-95503-003 | | | | 4 OF 5 | |
| THIS DRAWING CONTAINS INFORMATION THAT IS PROPRIETARY TO MOLEX INCORPORATED AND SHOULD NOT BE USED WITHOUT WRITTEN PERMISSION | | | | | | | | | | | |