

# SMD Power Inductor CDRH129R

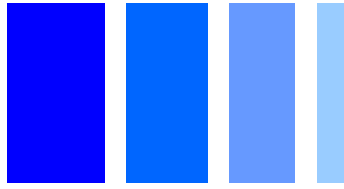

## Description

- Ferrite drum core construction.
- Magnetically shielded.
- L × W × H: 12.4 × 12.4 × 10.0 mm Max.
- Product weight: 5.3g(Ref.)
- Moisture Sensitivity Level: 1
- RoHS compliance.
- Halogen Free available.

## Dimension - [mm]

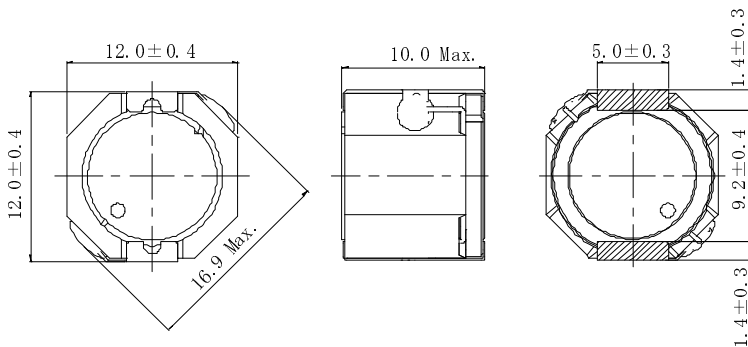

## Land pattern and Schematics - [mm]

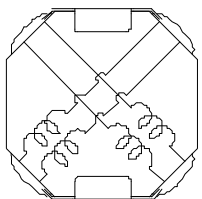
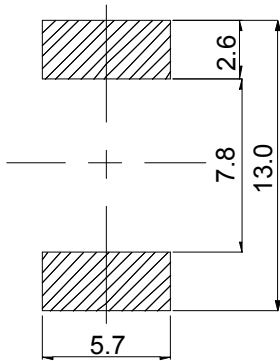

10 μH ~ 56 μH

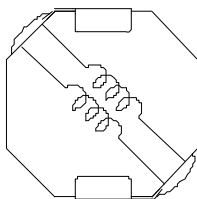

68 μH ~ 330 μH

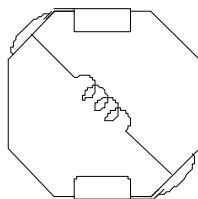

470 μH ~ 1.0mH

## Environmental Data

- Operating temperature range: -40°C ~ +125°C (including coil's self temperature rise)
- Storage temperature range: -40°C ~ +125°C
- Solder reflow temperature: 260 °C peak.

## Packaging

- Carrier tape and reel packaging.
- 13" diameter reel.
- 250pcs per reel.

## Applications

- Ideally used in LED lighting, etc.

# SMD Power Inductor CDRH129R



## Electrical Characteristics

Part No.	Stamp	Inductance ( $\mu$ H) 100kHz [Within]	D.C.R.(m $\Omega$ ) [Max] (at 20°C)※1	Saturation current (A) (at20°C)※2	Temperature rise current (A) ※3
CDRH129RNP-100MC	100	10 $\pm$ 20%	16.5(13.2)	7.60	6.50
CDRH129RNP-150MC	150	15 $\pm$ 20%	20.3(16.2)	5.80	6.00
CDRH129RNP-220MC	220	22 $\pm$ 20%	32.9(26.3)	5.30	4.70
CDRH129RNP-330MC	330	33 $\pm$ 20%	39.3(31.4)	4.00	4.25
CDRH129RNP-470MC	470	47 $\pm$ 20%	53.4(42.7)	3.45	3.80
CDRH129RNP-560MC	560	56 $\pm$ 20%	67.0(53.6)	3.15	3.25
CDRH129RNP-680MC	680	68 $\pm$ 20%	83.5(66.8)	2.95	2.85
CDRH129RNP-820MC	820	82 $\pm$ 20%	90.6(72.5)	2.60	2.75
CDRH129RNP-101MC	101	100 $\pm$ 20%	116(93)	2.40	2.45
CDRH129RNP-151MC	151	150 $\pm$ 20%	159(127)	1.95	2.20
CDRH129RNP-221MC	221	220 $\pm$ 20%	226(181)	1.60	1.85
CDRH129RNP-331MC	331	330 $\pm$ 20%	366(293)	1.30	1.45
CDRH129RNP-471MC	471	470 $\pm$ 20%	415(330)	1.08	1.30
CDRH129RNP-561MC	561	560 $\pm$ 20%	521(417)	1.00	1.18
CDRH129RNP-681MC	681	680 $\pm$ 20%	654(523)	0.91	1.04
CDRH129RNP-821MC	821	820 $\pm$ 20%	825(660)	0.82	0.92
CDRH129RNP-102MC	102	1000 $\pm$ 20%	938(750)	0.75	0.82

※1 ( ) are typical value.

※2 The saturation current: This indicates the value of DC current when the inductance decreases to 75% of its nominal.

※3 The temperature rise: The value of DC current when the temperature rise is  $\Delta T=40^{\circ}\text{C}$  ( $T_a=20^{\circ}\text{C}$ ).

# SMD Power Inductor CDRH129R

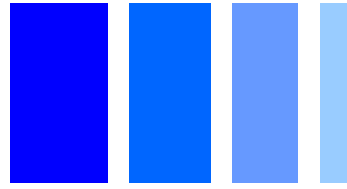

## Saturation Current & Temperature Rise Graph

— L (20°C) — L (105°C) —  $\Delta T$

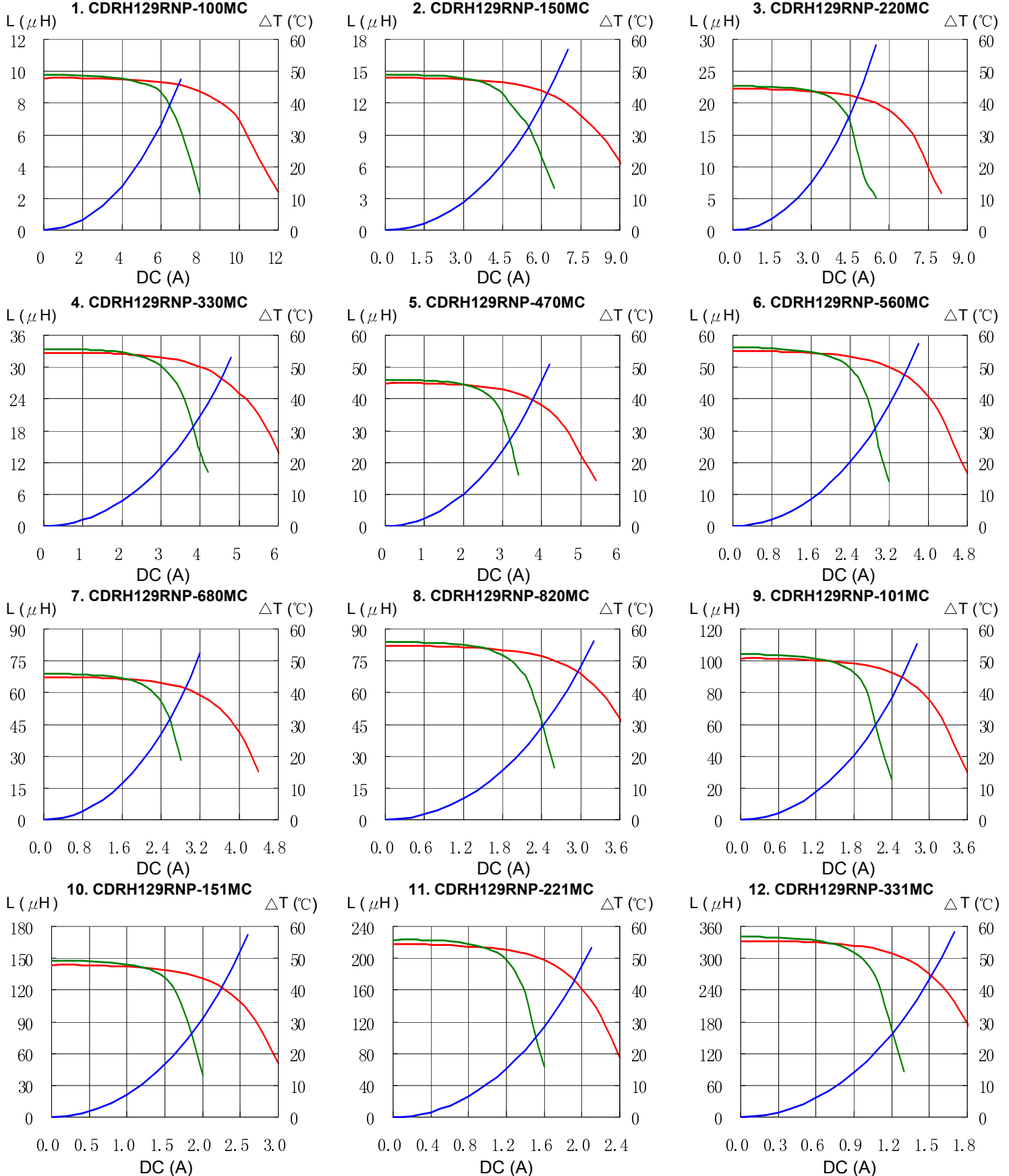

# SMD Power Inductor CDRH129R

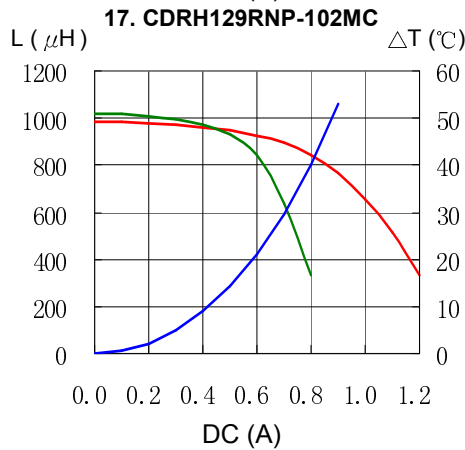
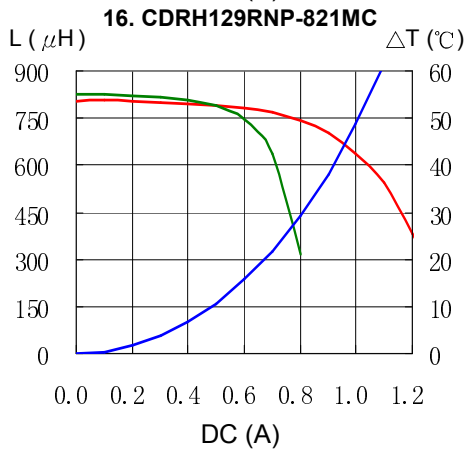
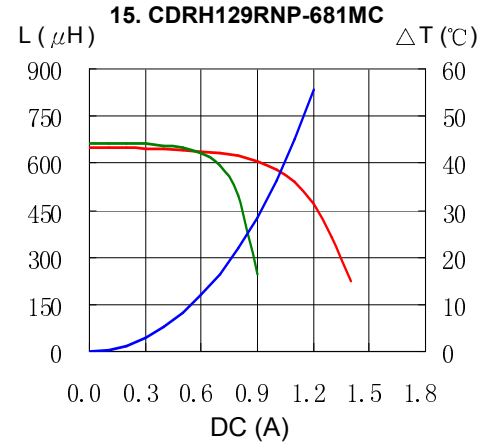
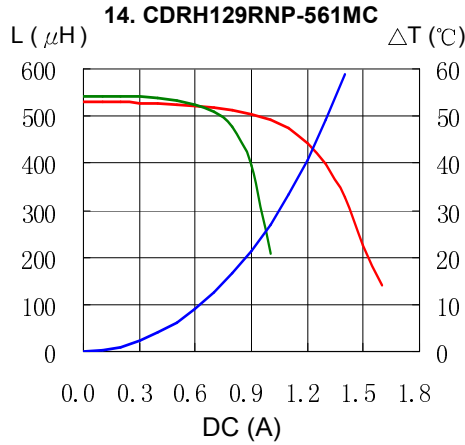
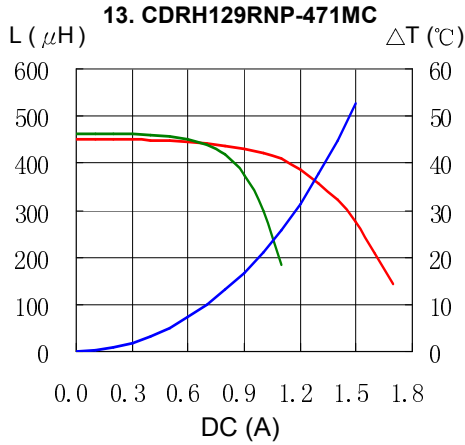
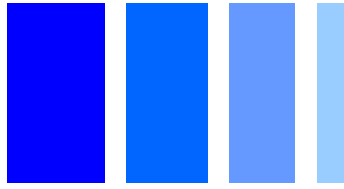

## Solder Reflow Condition

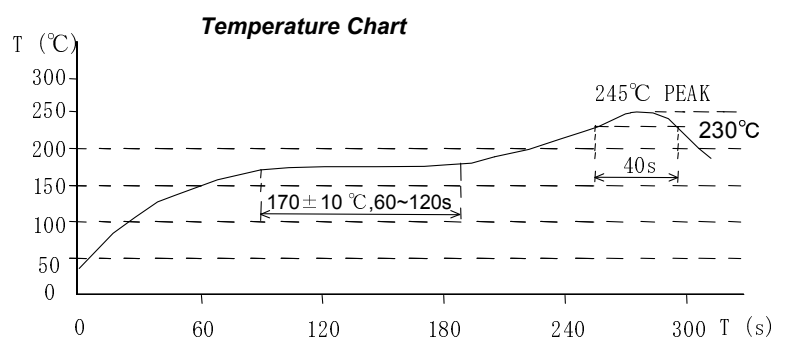
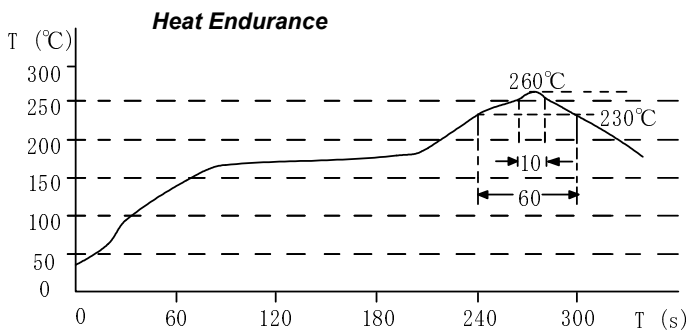

Please refer to the sales offices on our website - <http://www.sumida.com>

### Hong Kong

Tel. +852-2880-6688  
FAX. +852-2565-9600  
[sales@hk.sumida.com](mailto:sales@hk.sumida.com)

### Tokyo

Tel. +81-3-5202-7112  
FAX. +81-3-5202-7105  
[sales@jp.sumida.com](mailto:sales@jp.sumida.com)

### Chicago

Tel. +1-847-545-6700  
FAX. +1-847-545-6720  
[sales@us.sumida.com](mailto:sales@us.sumida.com)

### Shanghai

Tel. +86-021-5836-3299  
FAX. +86-021-5836-3266  
[shanghai.sales@cn.sumida.com](mailto:shanghai.sales@cn.sumida.com)

### Seoul

Tel. +82-2-6237-0777  
FAX. +82-2-6237-0778  
[sales@kr.sumida.com](mailto:sales@kr.sumida.com)

### Obernzell

Tel. +49-8591-937-0  
FAX. +49-8591-937-103  
[contact@sumida-eu.com](mailto:contact@sumida-eu.com)

### Shenzhen

Tel. +86-755-8291-0228  
FAX. +86-755-8291-0338  
[shenzhen.sales@cn.sumida.com](mailto:shenzhen.sales@cn.sumida.com)

### Singapore

Tel. +65-6296-3388  
FAX. +65-6296-3390  
[sales@sg.sumida.com](mailto:sales@sg.sumida.com)

### Neumarkt

Tel. +49-9181-4509-110  
FAX. +49-9181-4509-310  
[infocomp@eu.sumida.com](mailto:infocomp@eu.sumida.com)

### Taipei

Tel. +886-2-8751-2737  
FAX. +886-2-8751-2738  
[sales@tw.sumida.com](mailto:sales@tw.sumida.com)

### San Jose

Tel. +1-408-3219660  
FAX. +1-408-321-9308  
[sales@us.sumida.com](mailto:sales@us.sumida.com)