



TAI-SAW TECHNOLOGY CO., LTD.

No. 3, Industrial 2nd Rd., Ping-Chen Industrial District,
Taoyuan, 324, Taiwan, R.O.C.

TEL: 886-3-4690038 FAX: 886-3-4697532

E-mail: tstsales@mail.taisaw.com Web: www.taisaw.com

Approval Sheet For Product Specification

Issued Date: Jul, 23, 2002

Product Name: SAW Filter 1960MHz SMD 3.0 mm SQ

TST Parts No.: :TA0175A

Customer Parts No.: _____

Company: _____
Division: _____
Approved by : _____
Date: _____

Checked by: _____ Bob Chau

Approval by: _____ Vincent Lee

Date: _____ Jul, 23, 2002



TAI-SAW TECHNOLOGY CO., LTD.

No. 3, Industrial 2nd Rd., Ping-Chen Industrial District,
Taoyuan, 324, Taiwan, R.O.C.

TEL: 886-3-4690038 FAX: 886-3-4697532

E-mail: tstsales@mail.taisaw.com Web: www.taisaw.com

SAW Filter 1960 MHz for Mobile Communication

MODEL NO.: TA0175A

REV. NO.:2.0

A. MAXIMUM RATING:

1. Input Power Level: 10 dB_m
2. DC voltage: 0 V
3. Operating Temperature: -30°C to +80°C
4. Storage Temperature: -40°C to +85°C

RoHS Compliant
 Lead free
 Lead-free soldering

B. ELECTRICAL CHARACTERISTICS:

Item		Min.	Typ.	Max.
Center frequency	F_c (dB)	-	1960	-
Insertion loss within 1930 ~1990 MHz	IL (dB)	-	2.35	4
Amplitude ripple (p-p) within 1930 ~ 1990 MHz	(dB)	-	1.4	2.4
Attenuation (Reference level from 0 dB)				
D.C. ~ 1850 MHz	(dB)	20.0	32.0	-
1850 ~ 1910 MHz	(dB)	10.0	21.0	-
2010 ~ 2040 MHz	(dB)	4.5	10.0	-
2040 ~ 2070 MHz	(dB)	20.0	50.0	-
2070 ~ 5000 MHz	(dB)	22.0	29.0	-
VSWR within 1930 ~1990 MHz		-	1.7	2.4
Source impedance	Z_S (Ω)	-	50	-
Load impedance	Z_L (Ω)	-	50	-

Note1. No matching network required for operation at 50 Ω

C. Frequency Characteristics : Transfer function

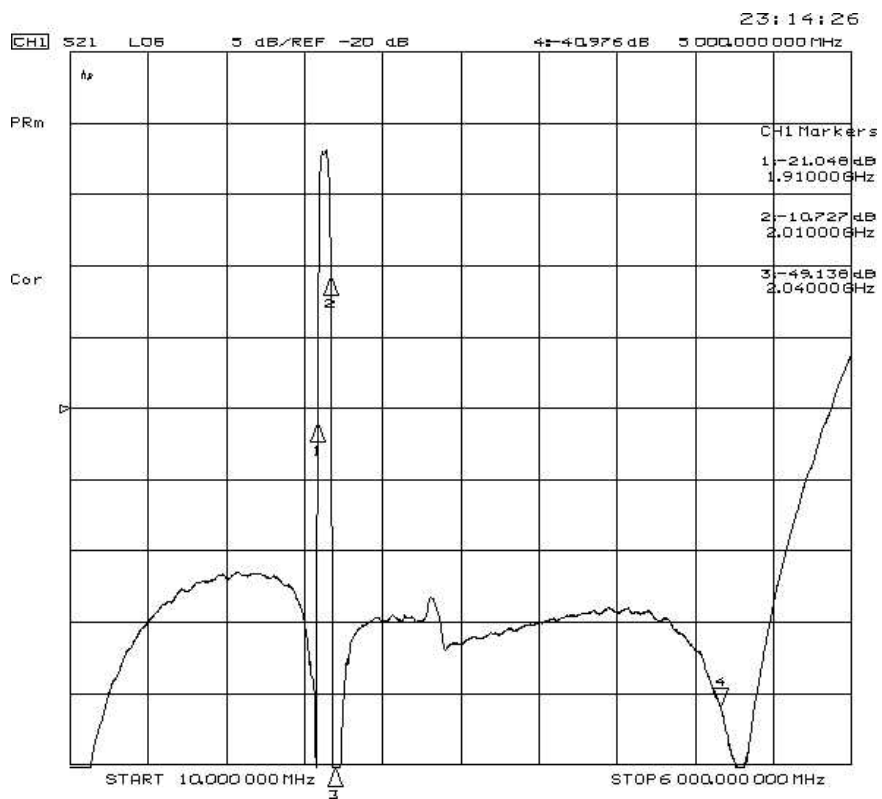
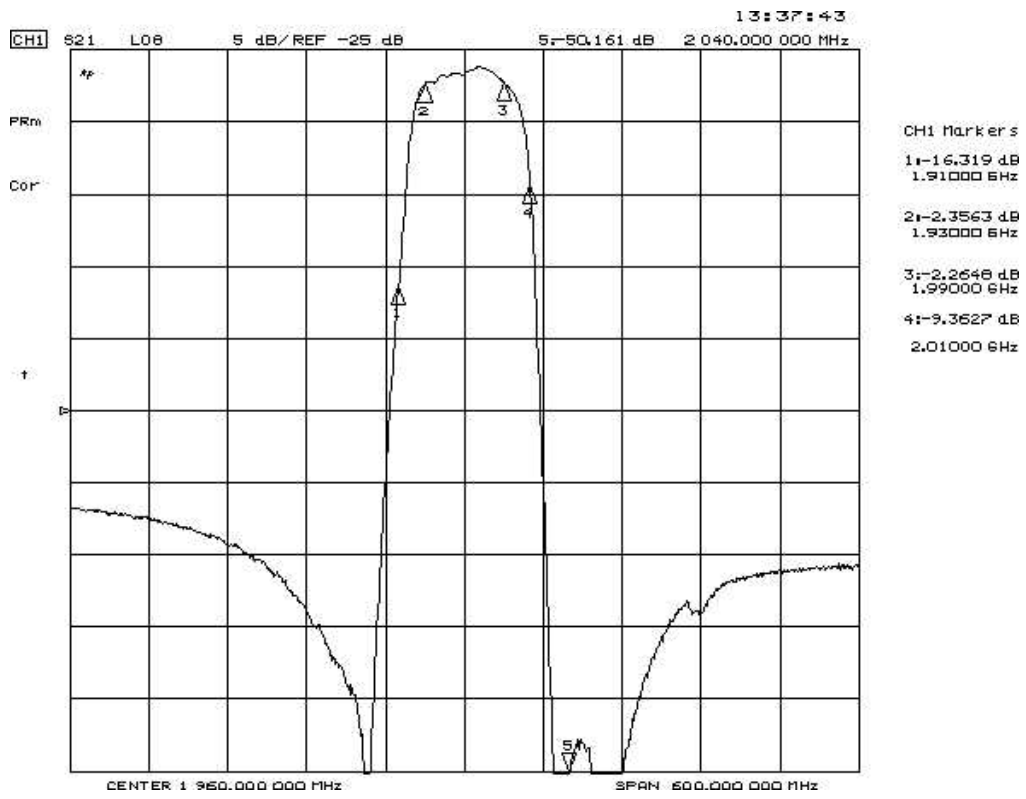

Reflections Functions :

S11 VSWR

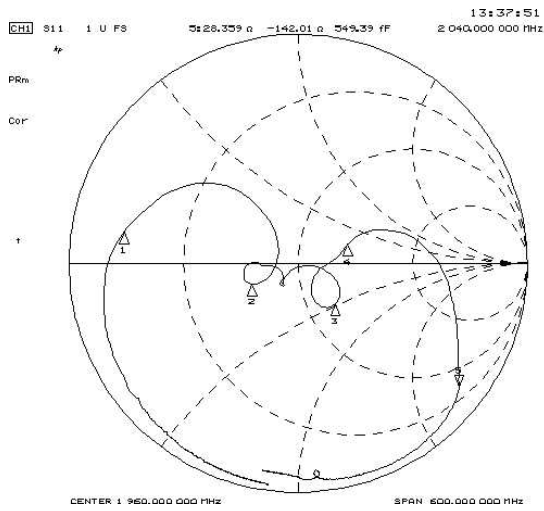

CHI Markers

1: 6.4773 a
4.2457 a
1.91000 GHz
2: 32.911 a
-62.793 a
1.93000 GHz
3: 64.304 a
-24.086 a
1.99000 GHz
4: 76.259 a
13.430 a
2.01000 GHz

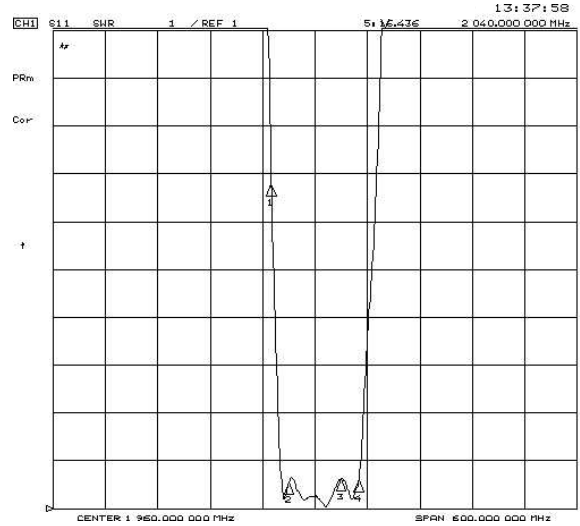

CHI Markers

1: 7.7935 a
1.91000 GHz
2: 1.5651 a
1.93000 GHz
3: 1.6212 a
1.99000 GHz
4: 1.6068 a
2.01000 GHz

S22 VSWR

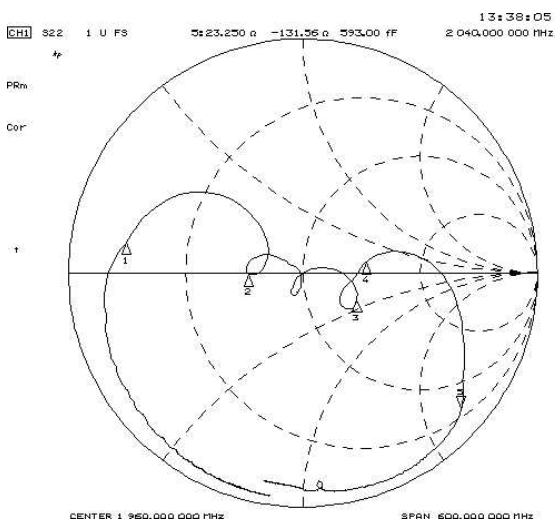

CHI Markers

1: 6.7395 a
4.2583 a
1.91000 GHz
2: 31.166 a
-126.52 a
1.93000 GHz
3: 77.234 a
-18.918 a
1.99000 GHz
4: 87.004 a
9.0097 a
2.01000 GHz

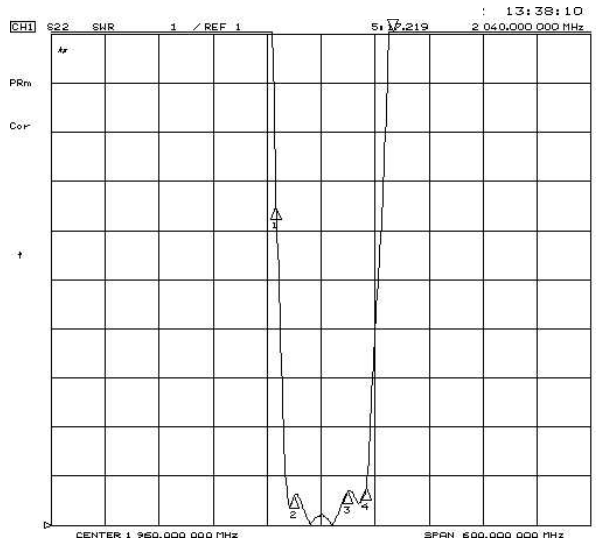

CHI Markers

1: 7.4889 a
1.91000 GHz
2: 1.6057 a
1.93000 GHz
3: 1.6960 a
1.99000 GHz
4: 1.7704 a
2.01000 GHz

D. MEASUREMENT CIRCUIT:

HP Network analyzer

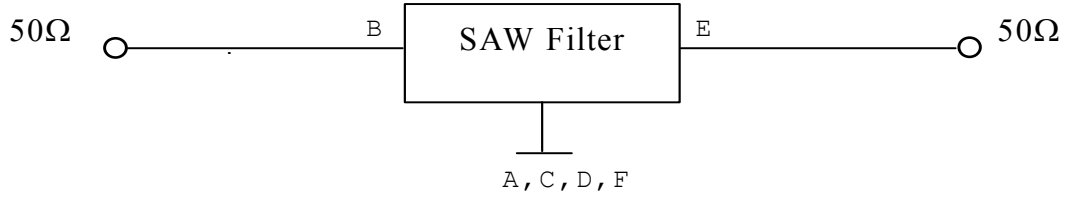

E. OUTLINE DRAWING:

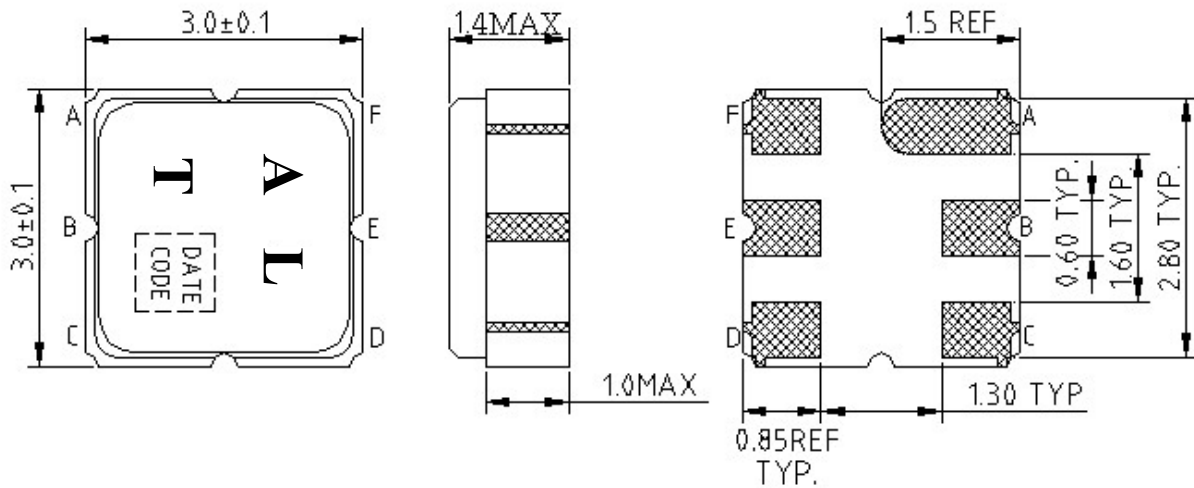

B INPUT
 E OUTPUT
 A,C,D,F GROUND
 DIMENSION : mm

F. PACKING:

1. REEL DIMENSION

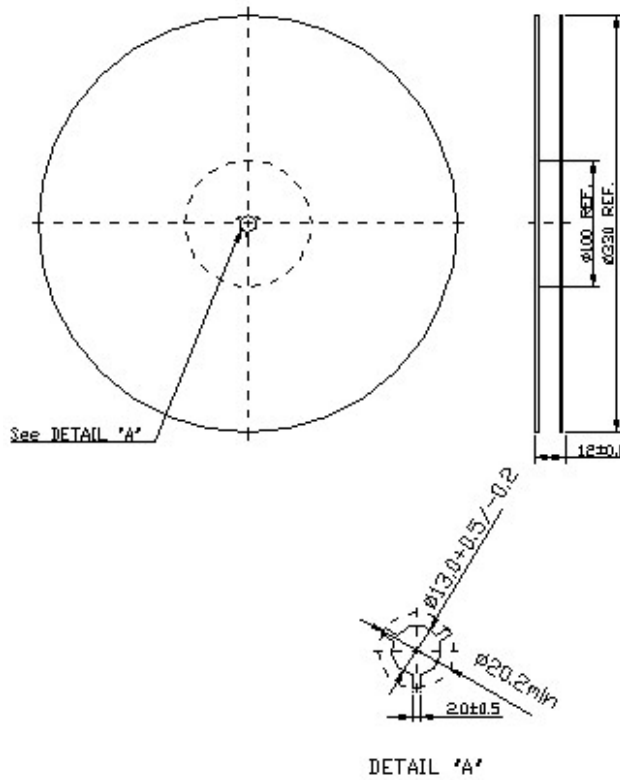

2. TAPE DIMENSION

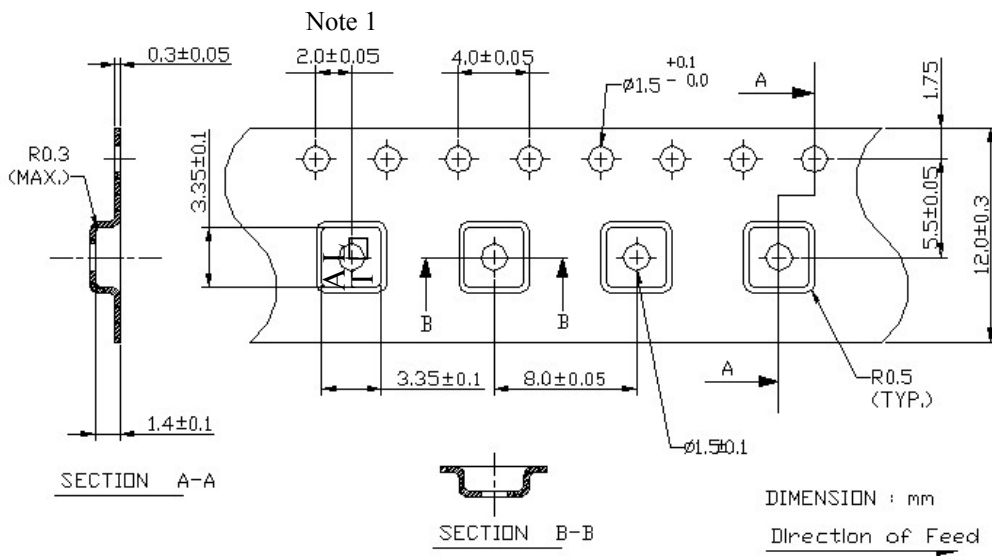

Note :

1. Pocket position relative to sprocket hole measured as true position of pocket, not pocket hole.