

This document is the property of Amphenol Corporation and is delivered on the express condition that it is not to be disclosed, reproduced or used, in whole or in part, by any other person without the express written permission of Amphenol Corporation. All rights reserved. No right is granted to disclose or to use any information in this document.

REVISIONS				
SYM	ECN	DESCRIPTION	DATE	APPROVED
A	HK2613	RELEASE TO PRODUCTION	07/16/03	Y.M. Lee

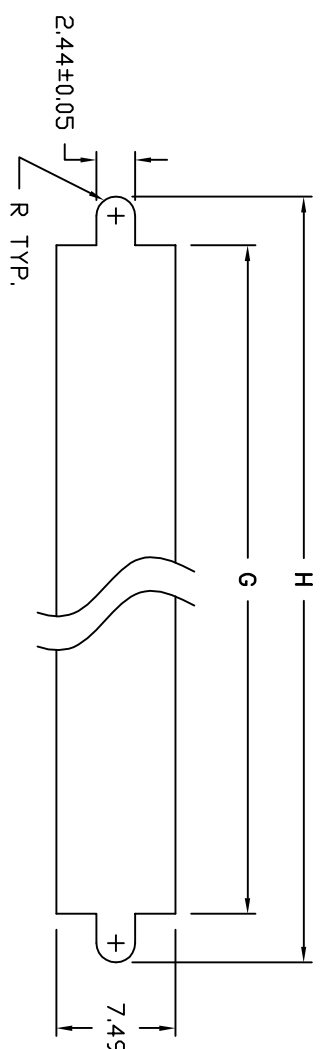
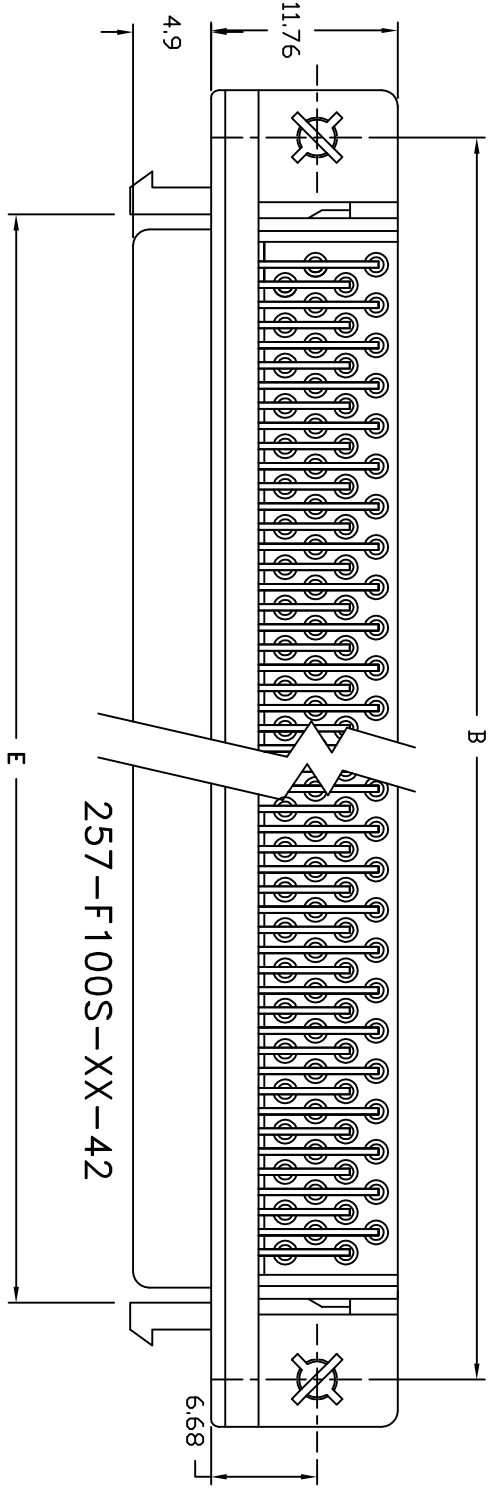
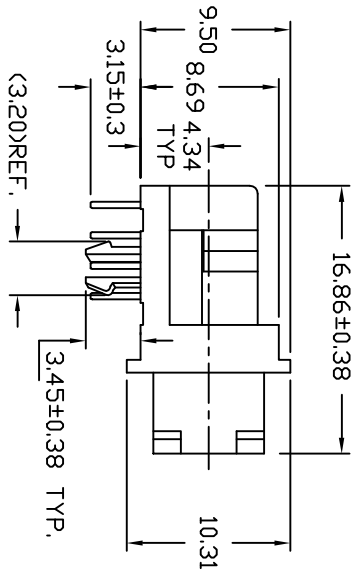
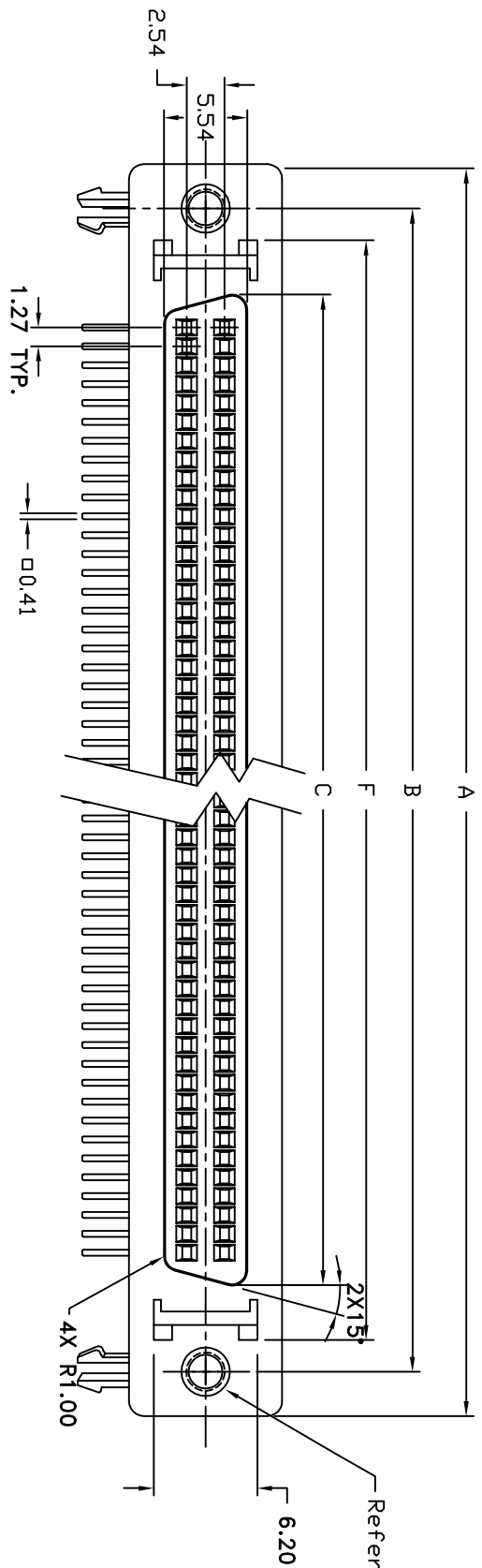

CUSTOMER INFORMATION DRAWING

Part Number	No. of Contacts	A	B	C	D	E	F	G	H	Layout Style
257-F050S-XX-XX	50	52.45	46.48	34.70	30.48	37.29	42.29	42.80	48.92	1
257-F068S-XX-XX	68	63.88	57.91	46.13	41.91	48.72	53.72	54.23	60.35	2
257-F100S-XX-XX	100	84.20	78.23	66.45	62.23	69.04	74.04	74.55	80.67	2

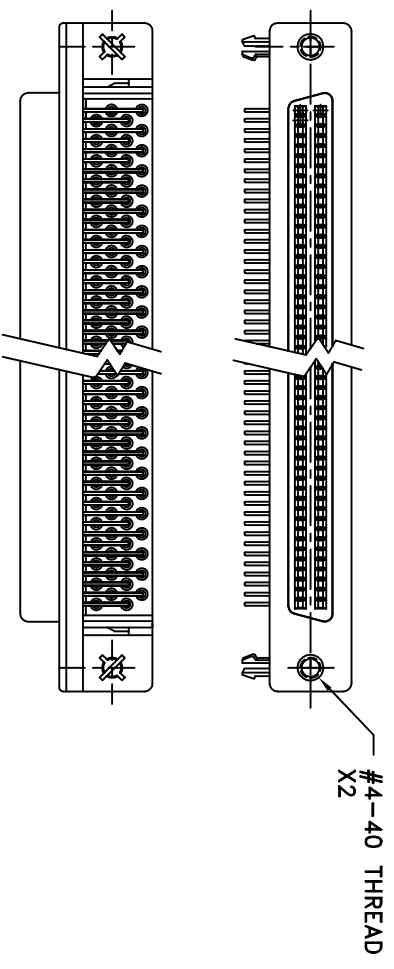

257-F100S-XX-92
SCALE: 1:2

UNLESS OTHERWISE SPECIFIED TOLERANCES U.S. METRIC

.X	+/-	0.20
.XX	+/-	0.13
.XXX	+/-	0.10
ANGLES	+/-	3°

FOR MATERIALS AND FINISHES SEE NOTES

REMOVE SHARP EDGES

DIMENSIONS

[U-S]	[FINCHES]
METRIC	MM

ANGLE OF PROJECTION

APPROVAL

DRAWN	Y.M.LEE	DATE	07/16/03
CHECKED	Y.M.LEE	CHECKED	07/16/03

DRAWING FILE: \DRAWING\257\C257FXXXREVA.DWG

Amphenol

TITLE: 257 SCSI-2 RIGHT ANGLE, SHIELD RECEPTACLE CONNECTOR WITH LOCATION PLATE

SIZE: A3
DRAWING NO.: C257-FXXXS-XX-XX
SCALE: NONE

SHEET 1 OF 2

This document is the property of Amphenol Corporation and is delivered on the express condition that it is not to be disseminated, reproduced or used in any manner without the prior consent of Amphenol Corporation and that no right is granted to disclose or to use any information in this document.

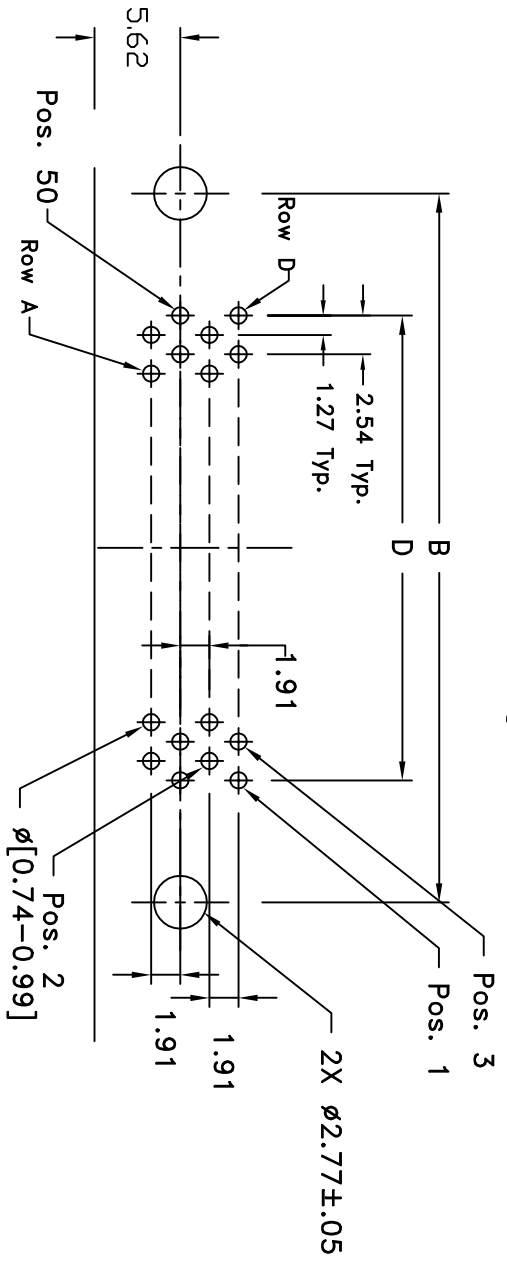
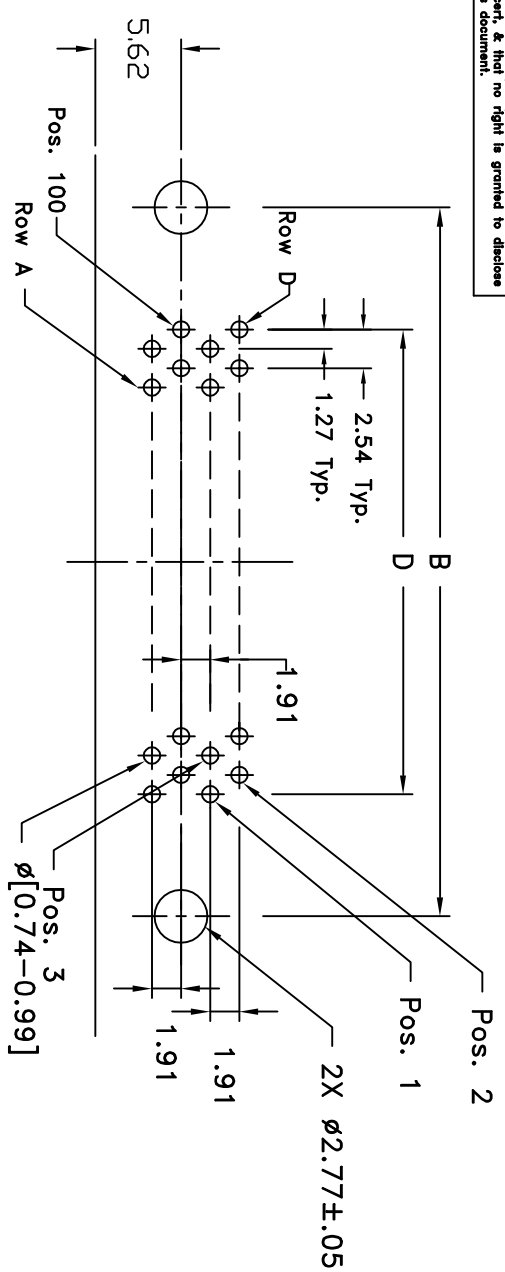

P/N System
257-FXXS-XX-XX
 Contact Type _____
 F - High temp. LCP material's body for board mount R/A 3.15mm tail
 No. of ways _____
 050 - 50 ways
 068 - 68 ways
 100 - 100 ways
 S - Socket (Female)
 P - Pin (Male)

Board Mounting Option (R/A bracket)
 2 - Boardlock
 3 - Clear hole
Panel Mount Option
 9 - #4-40 thr'd hole, w/o latch & rail
 6 - #2-56 thr'd hole, w/o latch & rail
 5 - #4-40 thr'd hole + latch block
 4 - #2-56 thr'd hole + latch block
 Plating Option

AA - Gold flash on mating area
 2.54-5.08µm Tin/Lead plated on termination area
 1.27-2.54µm Nickel underplated
AF - 0.38µm Gold plated on mating area
 2.54-5.08µm Tin/Lead plated on termination area
 1.27-2.54µm Nickel underplated
AM - 0.76µm Gold plated on mating area
 1.27-2.54µm Nickel underplated
 2.54-5.08µm Tin/Lead plated on termination area

Note:

- All dimensions are in mm.
- Materials
 Contact : Phosphor Bronze,
 AA - Gold flash on mating area
 2.54-5.08µm Tin/Lead plated on termination area
 1.27-2.54µm Nickel underplated
 AF - 0.38µm Gold plated on mating area
 2.54-5.08µm Tin/Lead plated on termination area
 1.27-2.54µm Nickel underplated
 AM - 0.76µm Gold plated on mating area
 2.54-5.08µm Tin/Lead plated on termination area
 1.27-2.54µm Nickel underplated
 Shell : Cold Roll Steel,
 5.08-7.62µm Tin/Lead plated.
 Insulator : LCP, color black, UL94V-0 rated.
 Die Casting bracket : Zinc alloy
 1.27-3.81µm Nickel plated with copper underplated.

3. Mechanical Characteristics

Durability : 500 cycles min. for 0.76µm gold
 250 cycles min. for 0.38µm
 50 cycles min. for gold flash
Contact Retention Force : 4.4 N min. per contact
Mating force : 1.22 N Max/contact (total 9.8 kgf approx.)
Unmating force : 0.20 N Max/contact (total 5 kgf approx.)
The housing flatness : should be within 0.003 mm/mm
No. of insertion into PCB : once

4. Electrical Characteristics

Contact Rating : 1 A Max.
Contact Resistance : 25 mΩ Max.
Insulation Resistance : 1000 MΩ Min.at 500 VDC
Operation Temperature : -55°C to 105°C
Dielectric Strength : 500 VAC
 5. Suitable for PCB with a nominal thickness of 1.56 mm
 6. Material should be fulfilled Amphenol Spec.# SSSN001.

CUSTOMER INFORMATION DRAWING

REVISIONS				
SYM	ECN	DESCRIPTION	DATE	APPROVED
A	HK	SEE SHEET 1		Y.M.LEE

UNLESS OTHERWISE SPECIFIED		APPROVAL		DATE	
TOLERANCES		DRAWN	Y.M.LEE	07/16/03	
U.S.		CHECKED	Y.M.LEE	07/16/03	
METRIC					
X	+/-				
.XX	+/-				
.XXX	+/-				
FRACTIONS	+/-				
ANGLES	+/-				
SEE NOTES		DRAWING FILE : \DRAWING\257\C257FXXSREV.A.DWG			
REMOVE SHARP EDGES		ANGLE OF PROJECTION			
DIMENSIONS					
U.S.	INCHES				
(METRIC)	(MM)				
TITLE		Amphenol			
257 SCSI-2 RIGHT ANGLE, SHIELD					
RECEPTACLE CONNECTOR WITH					
LOCATION PLATE					
SIZE	DRAWING NO.	SCALE		SHEET 2 OF 2	
A3	C257-FXXS-XX-XX	NONE		A	