

A B C D E F G H

4 3 2 1

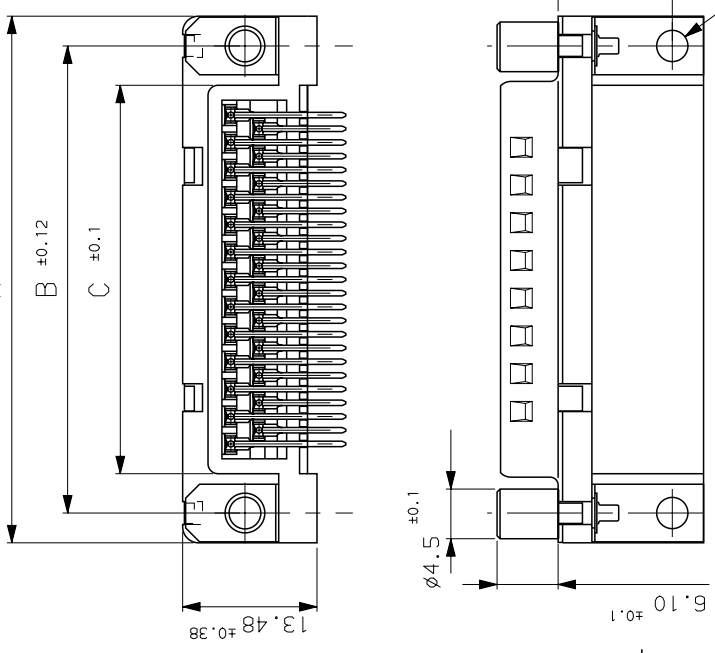
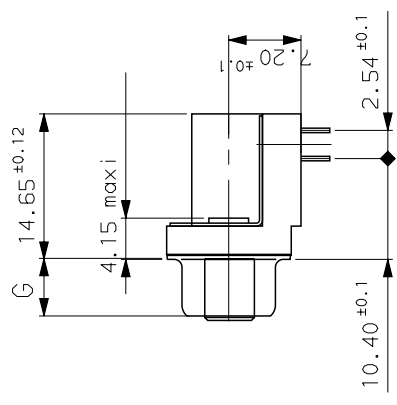
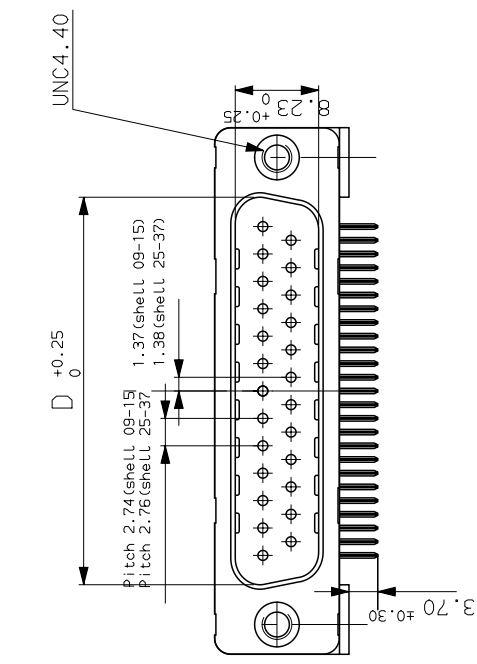

SHELL	A ± 0.38	B ± 0.12	C ± 0.10	D ± 0.25	G ± 0.25	PART NUMBER
09	30.81	24.99	16.96	16.79	5.90	D09P13B*UV00
15	39.14	33.32	25.18	25.12	5.90	D15P13B*UV00
25	53.03	47.04	39.12	38.84	5.70	D25P13B*UV00
37	69.32	63.50	55.68	55.30	5.70	D37P13B*UV00

Plating: 4 --> Flash AU
Plating: 6 --> 0.76µ AU

SEE TABLE

REQUIREMENTS
 Technical characteristics:
 Shell: steel tin plated
 Insulators: self-extinguishing black polyester, UL Class 94V0
 Contacts: size 20; brass, gold on mating end, bright tin on termination end over nickel on entire contact
 Cycles >500 for plating 6
 Cycles >200 for plating 4
 Screwlock: brass, tin plated
 Metal plate for electrical continuity: brass, tin plated

Electrical characteristics:
 max. current rating: 5A
 Test voltage: 1000V
 Rated voltage: 300V
 Contact resistance: $\leq 15\text{m}\Omega$
 Shell resistance: $\leq 5\text{m}\Omega$
 Insulation resistance: $> 5000\text{M}\Omega$
 Climatic characteristics:
 Operating temperature range: -55°C to $+125^\circ\text{C}$
 Dimensions:
 in accordance with MIL-C-24308

b	13/11/01	ISS DATE	Add part number.
ISS	DATE	Latest modification by: G01SNARD	MOD N°
Designed by:	JOUBERT	date: 01/08/94	Type of drawing: CLIENT
Checked by:	---	date: ---	Released by: ---
TITLE : MALE CONNECT.DELTA D RIGHT ANGLED WITH SCREWLOCK, METAL BRACKET.			
SCALE	Special mfg: ---	MATERIAL: ---	N°: ---
2.0	Item List n°: ---	General linear Tolerances: ---	Geometrical Tolerances: see NF E 04-552
General linear Tolerances: ---		General machining surface texture: $\sqrt{\quad}$	SHEET 01
FRAMATOME CONNECTORS FRANCE Rue Louis Bréguet - Bp 05 72024 LE MANS Cedex Tel. 33 (16) 43.84.08.43		This document is the property of FRAMATOME CONNECTORS FRANCE. It must not be reproduced or communicated without permission in writing. Flow the owners	
FORMAT A3	SOURIAU DRG N°	C01-8646-0287	PROJECT M94D002

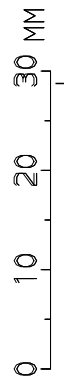

H G F E D C B A