

PLEASE CHECK WWW.MOLEX.COM FOR LATEST PART INFORMATION

Part Number: [0587820011](#)
Status: **Active**
Description: HMC™ Rectangular Industrial Plug Shell Assembly, Single Module Type, For Small Plug Cover, 12 and 40 Circuits

Documents:

[Drawing \(PDF\)](#) [RoHS Certificate of Compliance \(PDF\)](#)
[Product Specification PS-54478-001 \(PDF\)](#)

Agency Certification

CSA LR19980
 UL E29179

General

Product Family I/O Connectors
 Series [58782](#)
 Application Panel-Mount, Wire-to-Wire
 Component Type Hood Bracket
 Product Name HMC™
 Type N/A

Physical

Boot Color N/A
 Circuits (Loaded) N/A
 Durability (mating cycles max) 50
 Flammability 94V-0
 Gender Plug
 Lock to Mating Part Yes
 Material - Plating Mating n/a
 Orientation Vertical
 PCB Locator No
 Packaging Type Bag
 Panel Mount N/A
 Pitch - Mating Interface (in) 0.000 In
 Pitch - Mating Interface (mm) 0.00 mm
 Polarized to Mating Part Yes
 Polarized to PCB N/A
 Ports 1
 Surface Mount Compatible (SMC) No
 Temperature Range - Operating -40°C to +125°C
 Termination Interface: Style N/A
 Waterproof / Dustproof No

Electrical

Current - Maximum per Contact 35A
 Shield Type Full Shield
 Shielded Yes
 Voltage - Maximum 350V AC (RMS)

Material Info

Reference - Drawing Numbers

Product Specification PS-54478-001
 Sales Drawing SD-58782-0011

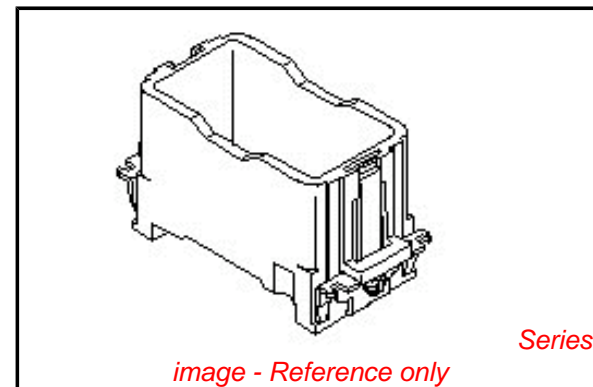

EU RoHS

ELV and RoHS Compliant
REACH SVHC
 Not Reviewed
Halogen-Free Status
 Not Reviewed

China RoHS



Need more information on product environmental compliance?

Email productcompliance@molex.com
 For a multiple part number RoHS Certificate of Compliance, [click here](#)

Please visit the [Contact Us](#) section for any non-product compliance questions.

Search Parts in this Series

[58782Series](#)

Mates With

[58783-0011](#) Receptacle Shell Assembly

Use With

[58461](#) Plug Cover, [58462](#) Plug Cover, [58550](#) End Bell Cap, [58455](#) End Bell Cap, [55347](#) Housing, [54478](#) Housing, [54296](#) TerminalLink:54297 Terminal, [55124](#) Terminal, [55125](#) Terminal

This document was generated on 04/05/2010

PLEASE CHECK WWW.MOLEX.COM FOR LATEST PART INFORMATION

E

D

C
B
A
DIMENSIONS IN METRIC DO NOT SCALE DRAWING

A

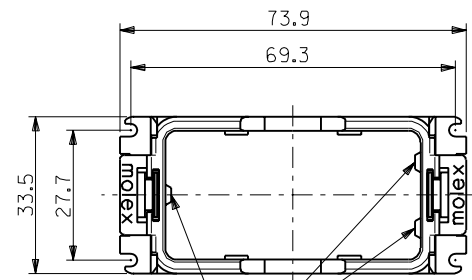
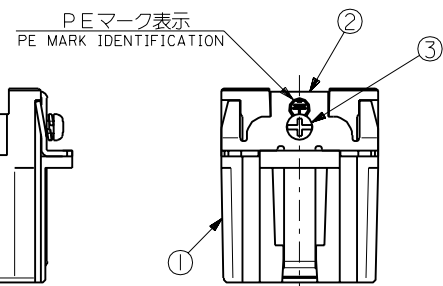
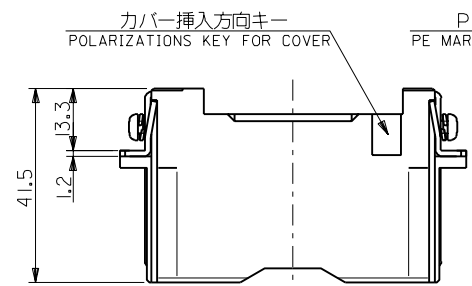
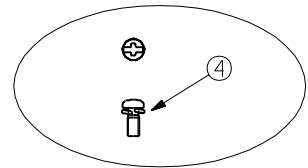
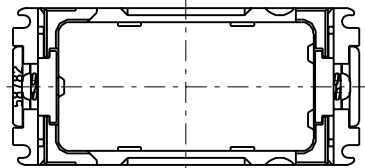

M+

NOTES

- 適用プラグカバーアッセンブリ
 APPLICABLE PLUG COVER ASS'Y
 ライトアングルタイプ : 58461-0011 / 1011 (SMALL)
 RIGHT-ANGLE TYPE
 ストレートタイプ : 58462-0011 / 1011 (SMALL)
 STRAIGHT TYPE
- 適用ハウジングアッセンブリ
 APPLICABLE HOUSING ASS'Y
 55347-40*5 (40 CKTS. MAIL HS'G ASS'Y)
 55348-12*5 (12 CKTS. MAIL HS'G ASS'Y)
 54478-40*5 (40 CKTS. FEMAIL HS'G ASS'Y)
 54479-12*5 (12 CKTS. FEMAIL HS'G ASS'Y)
- 推奨ねじ締め付けトルク
 RECOMMENDED SCREW TIGHTENING TORQUE
 ① M3 : 5~6kgf・cm
 ② M2.5 : 4~5kgf・cm
- 適用グラウンド圧着端子
 APPLICABLE CRIMP TERMINAL FOR GROUND
 活線と同等かそれ以上の電線サイズに適用した圧着端子を使用
 RING TERMINAL FOR POWER WIRE SIZE OR BIGGER ONE.

④	ばね座金組込みブラマイねじ (M2.5 X 6) FREE DRIVE HEAD SCREWS WITH SPRING WASHER (M2.5 X 6)	鋼, ニッケルメッキ STEEL, NI PLATING	4	58782-0011
③	ばね座金組込みブラマイねじ (M3 X 5) FREE DRIVE HEAD SCREWS WITH SPRING WASHER (M3 X 5)	鋼, ニッケルメッキ STEEL, NI PLATING	2	
②	プラグ グラウンド ターミナル PLUG GROUND TERMINAL	黄銅, ニッケルメッキ BRASS, NI PLATING	2	
①	プラグ シェル PLUG SHELL	アルミニウム合金 ALUMINIUM ALLOY	1	
部番 NO.	部品名 PARTS NAME	材質 MATERIAL	個数 QUAN.	製品番号 ENG. NO.

材料 MATERIAL		表参照 SEE TABLE	
仕上げ FINISH		— # —	
適用電線範囲 WIRE RANGE		— # —	
被覆外径 INS. RANGE		— # —	
DRAWN BY J. Matsuura	CHK'D BY J. Ota		
APP'D BY S. Tanaka	DATE 98/11/06	DR. CHK.	日付
REVISION RECORD		記号 LTR	変更内容 REVISION
一般公差 GENERAL TOLERANCES		記号 LTR	変更内容 REVISION

MOLEX-JAPAN CO.,LTD. 日本モレックス株式会社	
REVISE ONLY ON CAD SYSTEM	
TITLE 名称 ROBOT CONN. PLUG SHELL ASS'Y (SMALL)	
DWG. NO. (SHEET 1 OF 3)	REV
SD-58782-0011	0

DWG. NO.
SD-58782-0011

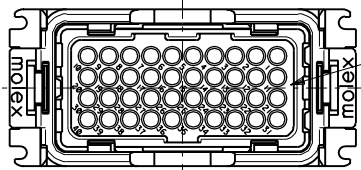
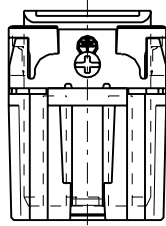
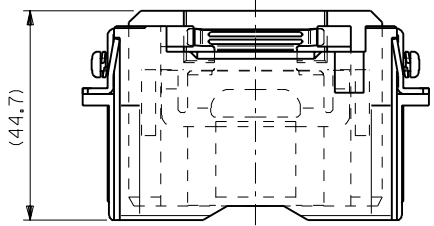
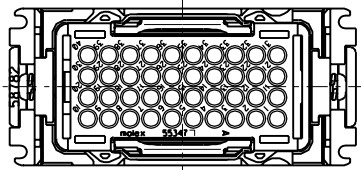

MALE HS'G ASS'Y (40 CKTS.)
55347-4015 (TYPE A)
55347-4065 (TYPE B)

メイルハウジングアッセンブリ装着状態図
FIGURE OF MALE HOUSING ASS'Y WHEN ASSEMBLED

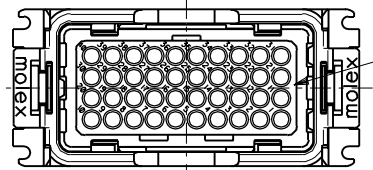
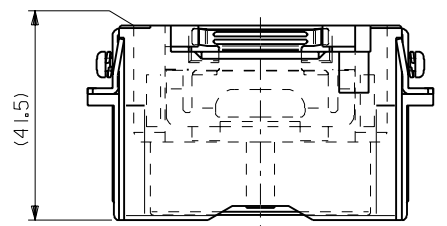
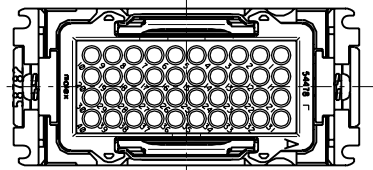

フィメイルハウジングアッセンブリ装着状態図
FIGURE OF FEMALE HOUSING ASS'Y WHEN ASSEMBLED

DIMENSIONS IN METRIC DO NOT SCALE DRAWING

角度 ANGLE	+3°
30 以上 OVER	+0.3
10 以上 30 未満 OVER UNDER	+0.25
10 未満 UNDER	+0.2
一般公差 GENERAL TOLERANCES	記号 LTR 変更内容 REVISION RECORD

材料 MATERIAL	SEE SHEET 1 OF 3
仕上げ FINISH	— #
適用電線範囲 WIRE RANGE	— #
被覆外径 INS. RANGE	— #
DRAWN BY	CHK'D BY
DATE	SCALE

THIS DRAWING CONTAINS INFORMATION THAT IS PROPRIETARY TO MOLEX/JAPAN AND SHOULD NOT BE DISCLOSED TO ANY OTHER PARTY WITHOUT THE WRITTEN PERMISSION OF MOLEX/JAPAN. THIS DRAWING IS THE PROPERTY OF MOLEX/JAPAN AND SHOULD NOT BE REPRODUCED OR TRANSMITTED IN ANY FORM OR BY ANY MEANS, ELECTRONIC OR MECHANICAL, INCLUDING PHOTOCOPYING, RECORDING, OR BY ANY INFORMATION STORAGE AND RETRIEVAL SYSTEM.

DWG. NO.
SD-58782-0011

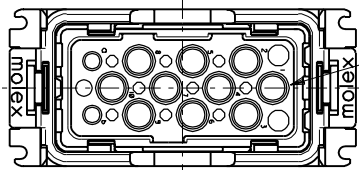
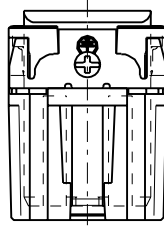
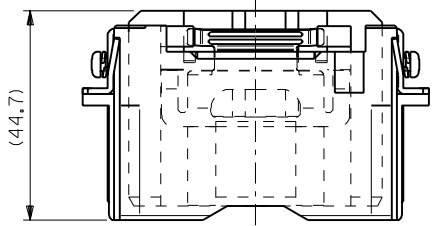
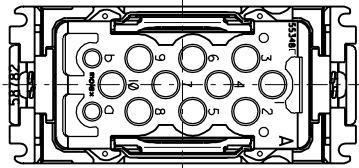

MALE HS'G ASS'Y (12 CKTS.)
55348-1215 (TYPE A)

メイルハウジングアセンブリ装着状態図
FIGURE OF MALE HOUSING ASS'Y WHEN ASSEMBLED

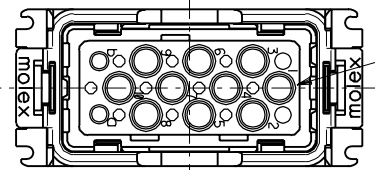
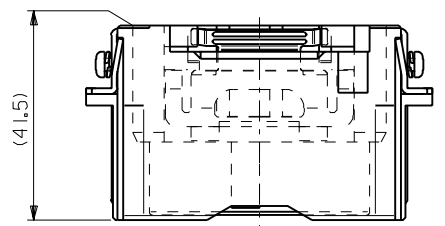
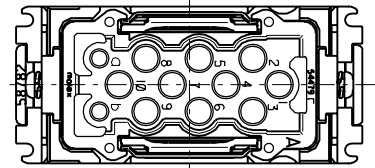

フィメイルハウジングアセンブリ装着状態図
FIGURE OF FEMALE HOUSING ASS'Y WHEN ASSEMBLED

DIMENSIONS IN METRIC DO NOT SCALE DRAWING

角度 ANGLE	+3°
30° 以上 OVER	+0.3
10° 以上 30° 未満 OVER UNDER	+0.25
10° 未満 UNDER	+0.2

材料 MATERIAL	SEE SHEET 1 OF 3	
仕上げ FINISH	— #	
適用電線範囲 WIRE RANGE	— #	
被覆外径 INS. RANGE	— #	
DRAWN BY	CHK'D BY	
記号 LTR	変更内容 REVISION RECORD	DR. DATE
一般公差 GENERAL TOLERANCES	記号 LTR	変更内容 REVISION RECORD
DR. DATE	APP'D BY	尺 度 SCALE

THIS DRAWING CONTAINS INFORMATION THAT IS PROPRIETARY TO MOLEX/JAPAN AND SHOULD NOT BE DISCLOSED OR REPRODUCED WITHOUT THE WRITTEN PERMISSION OF MOLEX/JAPAN. THIS DRAWING IS THE PROPERTY OF MOLEX/JAPAN AND SHOULD NOT BE REPRODUCED OR TRANSMITTED IN ANY FORM OR BY ANY MEANS, ELECTRONIC OR MECHANICAL, INCLUDING PHOTOCOPYING, RECORDING, OR BY ANY INFORMATION STORAGE AND RETRIEVAL SYSTEM.