

# B13a FEMALE HEADER RIGHT ANGLE

PITCH: 2.0mm

## SPECIFICATIONS

### Material

Insulator: PBT, glass reinforced, rated UL 94V-0

Contact: Phosphor Bronze

### Electrical

Current Rating: 1 Amp

Contact Resistance: 30 mΩ max.

Insulation Resistance: 3000MΩ min.

Dielectric Withstanding Voltage: 500 V AC for 1 minute

Operating Temperature: -40°C to +105°C

♦ **Mating Suggestion:** C27, C28, C29 & C30 series.

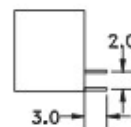
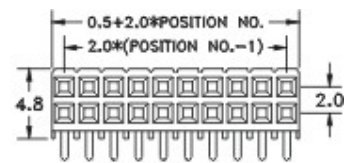
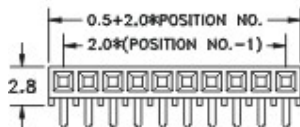

(TYPE A)

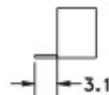
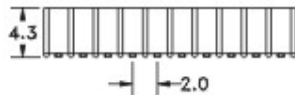

(TYPE C)

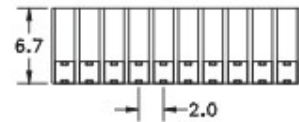
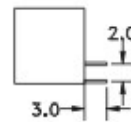

(TYPE B)

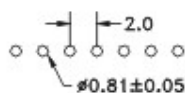

RECOMMENDED P.C.B LAYOUT

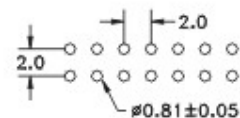

RECOMMENDED P.C.B LAYOUT

## HOW TO ORDER:

B13a -  1 -  2 -  3 -  4 -  5

1.NO. OF CONTACT	2.CONTACT MATERIAL	3.CONTACT PLATING	4.INSULATOR HEIGHT	5.INSULATOR COLOR
SINGLE ROW 1*2 - 1*40 DUAL ROW 2*2 - 2*40	B: PHOSPHOR BRONZE	T: TIN PLATED S: SELECTIVE G: GOLD FLASH A: 5μ" INCH GOLD B: 10μ" INCH GOLD C: 15μ" INCH GOLD D: 30μ" INCH GOLD	A: TYPE A B: TYPE B C: TYPE C	1. BLACK