

DWG. NO. 312-510-0850G			
REV	DESCRIPTION	BY DATE	APPD
A	ECR 7438	6/19/02	JEM

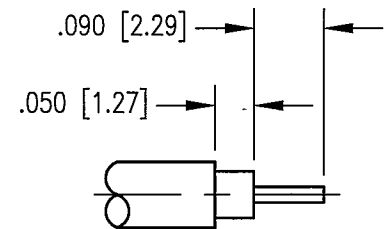
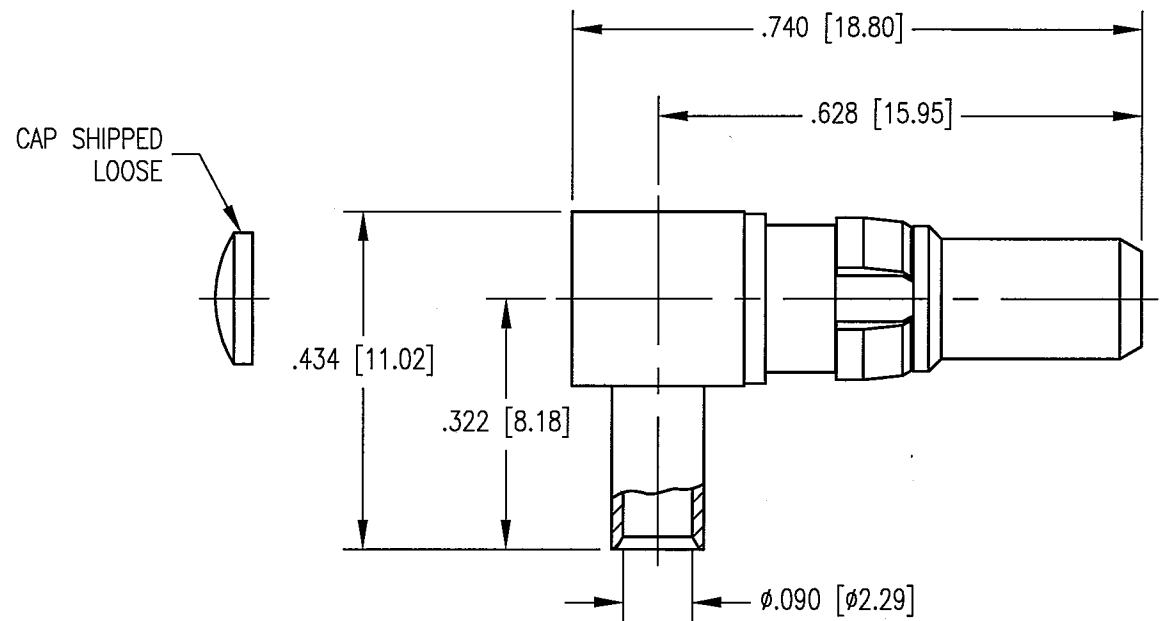

CABLE TRIMMING DIMENSIONS

NOTES:

- MATERIALS:
 CENTER CONTACT: COPPER ALLOY
 CLIP RING: BERYLLIUM COPPER PER ASTM B194
 INSULATOR: TEFLON PER ASTM D1710
 ALL OTHER METAL PARTS: BRASS PER ASTM B16
- FINISH:
 BODY AND CENTER CONTACT: .000030 MIN. GOLD PER MIL-G-45204 OVER
 .000050 MIN. NICKEL PER QQ-N-290
 CAP: .000005 MIN. GOLD PER MIL-G-45204 OVER
 .000050 MIN. NICKEL PER QQ-N-290
 CLIP RING: .000100 MIN. NICKEL PER QQ-N-290
 OVER COPPER FLASH
- FOR USE WITH .085 DIA. SEMI-RIGID OR EQUIVALENT CABLE.
- FOR CABLING PROCEDURES USE CAP 5-16 WITH TRIMMING DIMENSIONS SHOWN.

PER ASME Y14.5M-1994 UNLESS OTHERWISE SPECIFIED: DIMENSIONS ARE IN INCHES [MM]		NORTHROP GRUMMAN	
TOLERANCES: DECIMALS .XX ± .01 [0.254] .XXX ± .005 [0.127] ANGLES ± 2°		Winchester Electronics 400 Park Road Watertown, CT 06795	
SCALE: 4:1		TITLE	
CUSTOMER DRAWING		31 SERIES RIGHT ANGLE PLUG	
DRAWN	DATE	CHECKED	DATE
JED	11/20/00	JEM	11/21/00
APPROVED	DATE	APPROVED	DATE
JMC	11/21/00	KJT	11/21/00
A		312-510-0850G	SHT. 1 OF 1 REV. A