

SD

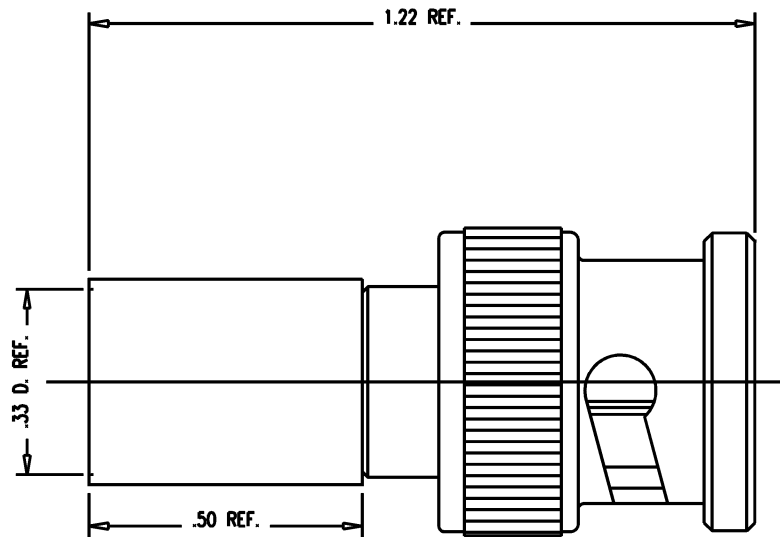

NOTES:

1. FOR USE WITH WE 724, BELDEN 8281, AND COMM SCOPE 7501 CABLE.
2. FOR CABLING INSTRUCTIONS SEE 3-661-4.
3. FOR CRIMPING USE KTH-2119
4. INTERFACE PER MIL-STD-348, FIG. 301-1 (AS APPLICABLE).
5. MATERIALS:
 - INSULATOR-TEFLON.
 - GASKET-SILICONE RUBBER.
 - K-GRIP SLEEVE-COMMERCIAL BRONZE.
 - OUTER CONTACT } BER. COP.
 - SPRING WASHER } BER. COP.
 - ALL OTHER METAL PARTS-BRASS.
6. FINISHES:
 - CENTER CONTACTS: GOLD PLATE.
 - SPRING WASHER-SILVER PLATE.
 - ALL OTHER METAL PARTS-NICKEL PLATE.
7. ELECTRICAL CHARACTERISTICS:
 - NOMINAL IMPEDANCE-75 OHMS
 - WORKING VOLTAGE-500 VRMS
 - FREQUENCY RANGE-DC TO 3 GHZ

SD

2065-15-9

REVISIONS	
ISSUE	CHANGES
0	ER 39301 DCT 7/19/5
SCALE 4:1	
APPROX SURFACE AREA	
-	
USED ON	
REF:	
PL, 75 BNC	
DRAWN	DCT DATE 7/19/5
DESIGN	DCT DATE 7/19/5
APPR.	DATE
KINGS ELECTRONICS CO., INC. ROCK HILL, SOUTH CAROLINA 29730	
2065-15-9	