



KI SEMICONDUCTOR CO.

High Voltage Diodes for Special Using

2CL500/30

■ Outline Dimensions and Mark (example)

Unit: mm

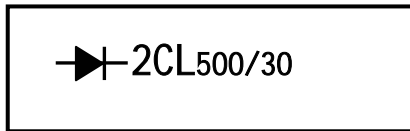
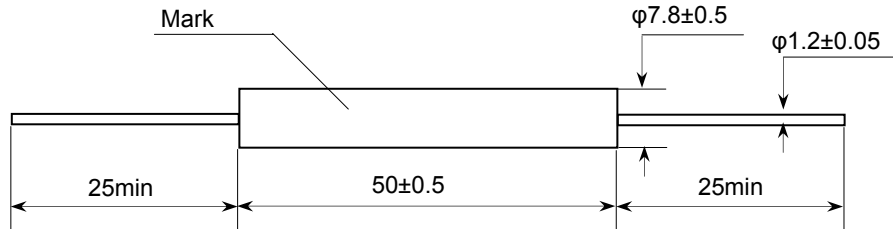

■ Limiting Values (Absolute Maximum Rating)

Item	Symbol	Unit	2CL500/30
Repetitive Peak Reverse Voltage	V_{RRM}	kV	30
Average Forward Current	$I_{F(AV)}$	mA	500
Surge(Non-repetitive)Forward Current	I_{FSM}	A	10
Storage Temperature	T_{stg}		-40~+125
Operating Ambient Temperature	T_a		-40~+100

■ Electrical Characteristics ($T_a=25$ Unless otherwise specified)

Item	Symbol	Test Condition	Unit	Max	
				2CL500/30	
Peak Forward Voltage	V_{FM}	$I_{FM}=I_{F(AV)}$	V	60	
Peak Reverse Current	I_{RRM1}	$T_a=25$	$V_{RM}=V_{RRM}$	μA	5
	I_{RRM2}	$T_a=100$			50

■ Outline Dimensions and Mark (example)

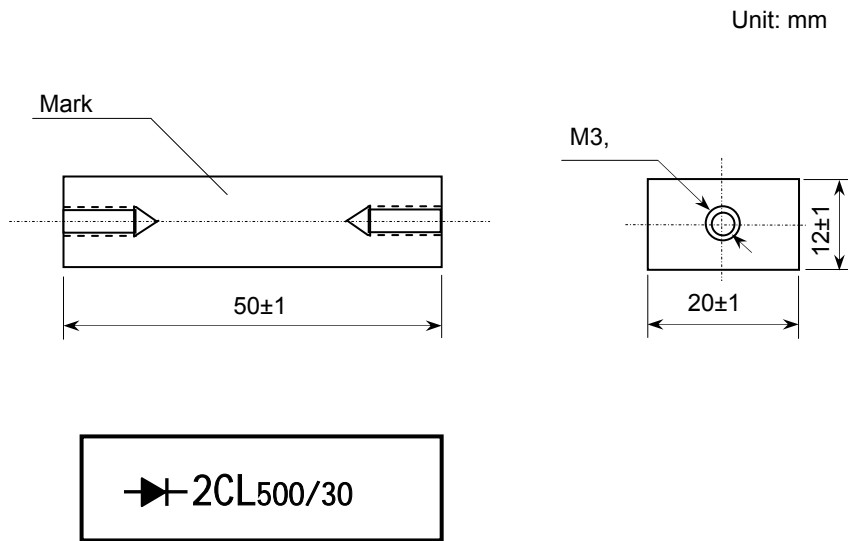

■ Limiting Values (Absolute Maximum Rating)

Item	Symbol	Unit	2CL500/30
Repetitive Peak Reverse Voltage	V_{RRM}	kV	30
Average Forward Current	$I_{F(AV)}$	mA	500
Surge(Non-repetitive)Forward Current	I_{FSM}	A	10
Storage Temperature	T_{stg}		-40~+125
Operating Ambient Temperature	T_a		-40~+100

■ Electrical Characteristics ($T_a=25$ Unless otherwise specified)

Item	Symbol	Test Condition	Unit	Max	
				2CL500/30	
Peak Forward Voltage	V_{FM}	$I_{FM}=I_{F(AV)}$	V	60	
Peak Reverse Current	I_{RRM1}	$T_a=25$	$V_{RM}=V_{RRM}$	μA	5
	I_{RRM2}	$T_a=100$			50