

SQUARE CORNER IS CKT 1 IDENTIFIER

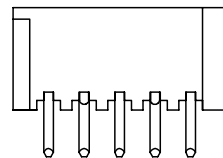

SEE NOTE 4

SEE NOTE 4

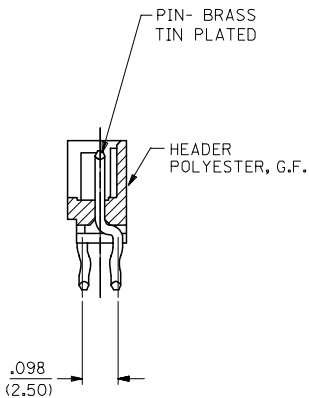
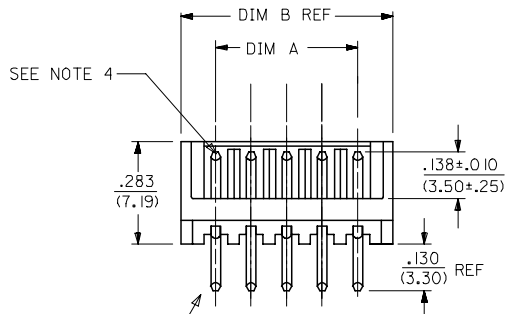
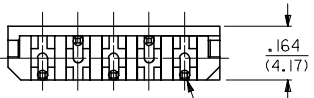

CIRCUIT 1

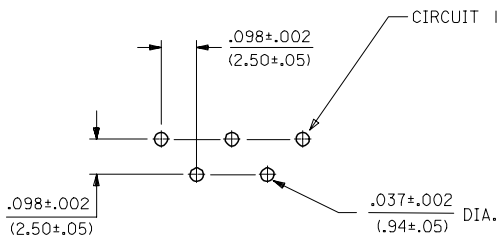

PCB HOLE LAYOUT: COMPONENT SIDE
RECOMMENDED PCB THICKNESS: .062 (1.57)

NOTES:

1. FOR PRODUCT SPECS. SEE PS-42219-0001.
2. ANY VOID COMBINATION LEAVING PINS IN ONE ROW ONLY IS NOT AN AVAILABLE OPTION. THE RESULT WOULD BE MINIMAL BOARD RETENTION.

NO. OF CKTS.	KINK LOC.	DIM A (MM)	DIM B (MM)
2	ALL PINS	(2.50)	(7.42)
3	ALL PINS	(5.00)	(9.92)
4	ALL PINS	(7.50)	(12.42)
5	ALL PINS	(10.00)	(14.92)
6	ALL PINS	(12.50)	(17.40)
7	ALL PINS	(15.00)	(19.90)
8	ALL PINS	(17.50)	(22.40)
9	ALL PINS	(20.00)	(24.90)
10	ALL PINS	(22.50)	(27.40)
11	ALL PINS	(25.00)	(29.90)
12	ALL PINS	(27.50)	(32.40)
13	ALL PINS	(30.00)	(34.90)
14	ALL PINS	(32.50)	(37.40)
15	ALL PINS	(35.00)	(39.90)

A-42249-N*-**-**

NO. OF CKTS. PART
BLANK = STANDARD
SP = SPECIAL
VOID LOCATION
PIN
BLANK = 42238-D2(102)
154 = 42238-D2(154)

ADD P/N 42249-1000 EC NO: UCP2005-1882 DRWNAELHAG 2005/03/18 CHKDELHAG 2005/03/24 APPR:FSM:TH 2005/03/24 REV DESCRIPTION	QUALITY SYMBOLS	GENERAL TOLERANCES (UNLESS SPECIFIED)	DIMENSION STYLE IN/MM	SCALE 4:1	DESIGN UNITS METRIC	THIRD ANGLE PROJECTION	
	$\nabla=0$ $\nabla=0$	4 PLACES ± --- ± --- 3 PLACES ± --- ± .010 2 PLACES ± 0.25 ± .015 1 PLACE ± 0.38 ± --- ANGULAR ±1/2°	DRAWN BY RE DATE 12/17/88 CHECKED BY WRL DATE 12/17/88 APPROVED BY LENZ DATE 12/17/88	TITLE	2.5 MM HEADER ASSEMBLY (STAGGERED PINS)		
	DRAFT WHERE APPLICABLE MUST REMAIN WITHIN DIMENSIONS	MATERIAL NO. SEE CHART DOCUMENT NO. SDA-42249-* SHEET NO. 1 OF 4	MOLEX INCORPORATED				
	R4	THIS DRAWING CONTAINS INFORMATION THAT IS PROPRIETARY TO MOLEX INCORPORATED AND SHOULD NOT BE USED WITHOUT WRITTEN PERMISSION					

A-42249-NA*				A-422649-NB*				A-42249-NC*				
OPTIONS	HOUSING	42249-N		OPTIONS	HOUSING	42249-NA		OPTIONS	HOUSING	42249-NB		
	COLOR	WHITE			COLOR	BLUE			COLOR	BROWN		
	PIN NO	42238-D2(102)			PIN NO	42238-D2(102)			PIN NO	42238-D2(102)		
	PLATING	102			PLATING	102			PLATING	102		
Ckt	Material No	Engineering No	Void Ckts	Ckt	Material No	Engineering No	Void Ckts	Ckt	Material No	Engineering No	Void Ckts	
2	22-43-6020	A-42249-2A		2	22-44-7026	A-42249-2B		2	22-44-7025	A-42249-2C		
3	22-43-6030	A-42249-3A		3	22-44-7036	A-42249-3B		3	22-44-7035	A-42249-3C		
4	22-43-6040	A-42249-4A		4	22-44-7046	A-42249-4B		4	22-44-7045	A-42249-4C		
5	22-43-6050	A-42249-5A		5	22-44-7056	A-42249-5B		5	22-44-7055	A-42249-5C		
6	22-43-6060	A-42249-6A		6		A-42249-6B		6	22-44-7065	A-42249-6C		
7	22-43-6070	A-42249-7A		7		A-42249-7B		7	22-44-7075	A-42249-7C		
8	22-43-6080	A-42249-8A		8		A-42249-8B		8	22-44-7085	A-42249-8C		
9	22-43-6090	A-42249-9A		9		A-42249-9B		9	22-44-7095	A-42249-9C		
10	22-43-6100	A-42264910A		10		A-42264910B		10	22-44-7105	A-42249-10C		
11	22-43-6110	A-42249-11A		11		A-42249-11B		11	22-44-7115	A-42249-11C		
12	22-43-6120	A-42249-12A		12		A-42249-12B		12	22-44-7125	A-42249-12C		
13	22-43-6130	A-42249-13A		13		A-42249-13B		13	22-44-7135	A-42249-13C		
14	22-43-6140	A-42249-14A		14		A-42249-14B		14	22-44-7145	A-42249-14C		
15	22-43-6150	A-42249-15A		15		A-42249-15B		15	22-44-7155	A-42249-15C		
	22-43-6041	A-42249-4A-2	2									
	22-43-6042	A-42249-4A-3	3									
	22-43-6063	A-42249-6A-51	3,5									
	22-43-6064	A-42249-6A-52	2,4									
	22-43-6032	A-42249-3A-3	3									
	022-43-6073	A-42249-07A-51	2,5									
	022-43-6072	A-42249-07A-3	3									
	022-43-6074	A-42249-07A-5	5									
	022-43-6075	A-42249-07A-52	3,6									
	022-43-6061	A-42249-06A-5	5									
	022-43-6065	A-42249-06A-2	2									
REV:	SEE SHEET 1 3/24/2005			TITLE:	2.5 MM HEADER ASSEMBLY (STAGGERED PINS)						SHEET No.	- 2 -
DOCUMENT NUMBER:	SDA-42249-*			CREATED / REVISED BY:	ELHAG		CHECKED BY:	ELHAG		APPROVED BY:	FSMITH	

