

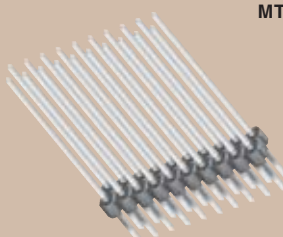

MTSW-126-09-L-S-430-RA

MTSW-203-11-T-T-740



MTSW-110-27-G-D-990

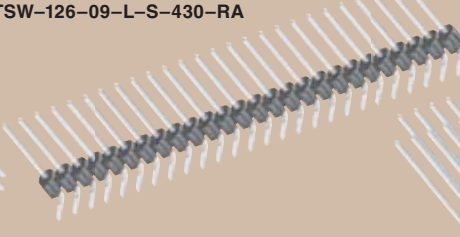

MTSW-112-12-G-Q-730-RA

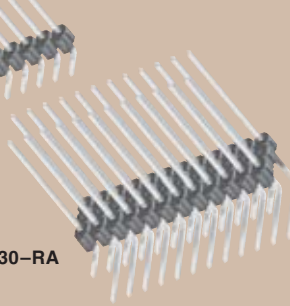

MTSW-125-07-T-S-100

**PLATING OPTION**

**-F**

= Gold flash on post, Matte Tin on tail

**-L**

= 10µ" (0,25 µm) Gold on post, Matte Tin on tail

**-G**

= 10µ" (0,25 µm) Gold on post, Gold flash on balance

**-T**

= Matte Tin



Note: Other Gold plating options available. Contact Samtec.

**ROW OPTION**

**-S**

= Single

**-D**

= Double

**-T**

= Triple

**-Q**

= Double Row  
.200" (5,08 mm) row space

**POST HEIGHT**

**OTHER OPTION**

**POLARIZED OPTION**

**-“XXX”**

= Polarized  
(Specify ‘XXX’ as position number)

**-RA or -RE** = Right Angle

**-LL**

= Locking Lead  
(N/A with -RE,  
N/A in single row 1 or 2  
positions. Available on  
tails from (2,29 mm) .090"  
to (10,16 mm) .400" only)

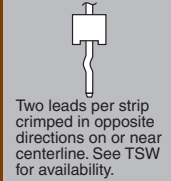

**-LA** = -RA Option with -LL Option  
(Maximum “C” = (13,46 mm) .530)

**-“XXXX”** = “C” Dimension (Specify post height in INCHES - .005" (0,13 mm) increments)

LEAD STYLE	FOR A = (2,29) .090			
	OAL	C MAXIMUM STRAIGHT	C MAXIMUM w/RA	C MAXIMUM w/RE
-06	(7,62) .300	(2,79) .110	N/A	N/A
-07	(10,92) .430	(6,10) .240	(3,30) .130	N/A
-08	(13,46) .530	(8,64) .340	(5,84) .230	(3,30) .130
-09	(18,54) .730	(13,72) .540	(10,92) .430	(8,38) .330
-10	(21,08) .830	(16,26) .640	(13,46) .530	(10,92) .430
-11	(23,62) .930	(18,80) .740	(16,00) .630	(13,46) .530
-12	(26,16) 1.030	(21,34) .840	(18,54) .730	(16,00) .630
* -13	(31,24) 1.230	(26,42) 1.040	(23,62) .930	(21,08) .830
* -21	(36,32) 1.430	(31,50) 1.240	(28,70) 1.130	(26,16) 1.030
* -22	(16,00) .630	(11,18) .440	(8,38) .330	(5,84) .230
* -23	(11,30) .445	(6,48) .255	(3,68) .145	N/A
* -24	(12,19) .480	(7,37) .290	(4,57) .180	N/A
* -27	(33,78) 1.330	(28,96) 1.140	(26,16) 1.030	(23,62) .930
* -28	(28,70) 1.130	(23,88) .940	(21,08) .830	(18,54) .730

\* Styles -21, -23, -24, -27 not available with -D Right Angle  
Styles -13, -21, -23, -24, -27, -28 not available with -T or -Q Right Angle

**Straight Pin Versions** A = OAL - C - (2,54) .100

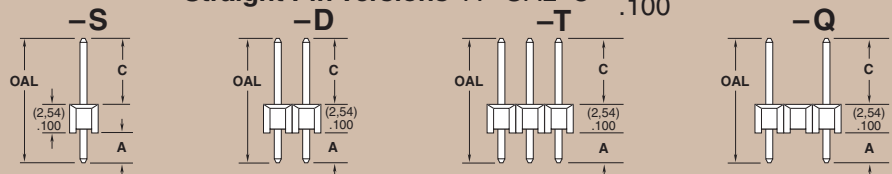

**Right Angle Versions (-RA Options)** A = OAL - C - (5,33) .210

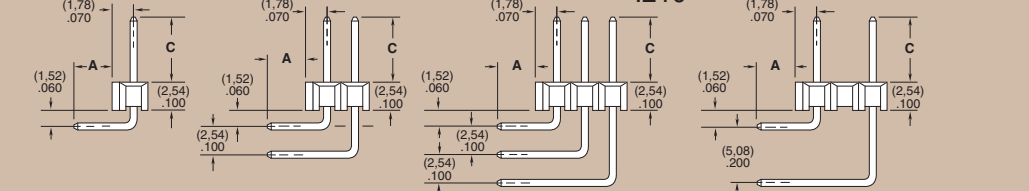

**Right Angle Versions (-RE Options) Single Row Only**

A = OAL - C - (7,87) .310

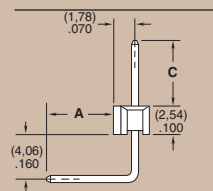

Due to technical progress, all designs, specifications and components are subject to change without notice.

[WWW.SAMTEC.COM](http://WWW.SAMTEC.COM)