

DASH NO.	M CODE	MADE FROM
----------	--------	-----------

GSD

KN-59-148

REVISIONS	
ISSUE	CHANGES

6	CN 33385 E REDRAWN WJM 09/23/91
---	---------------------------------------

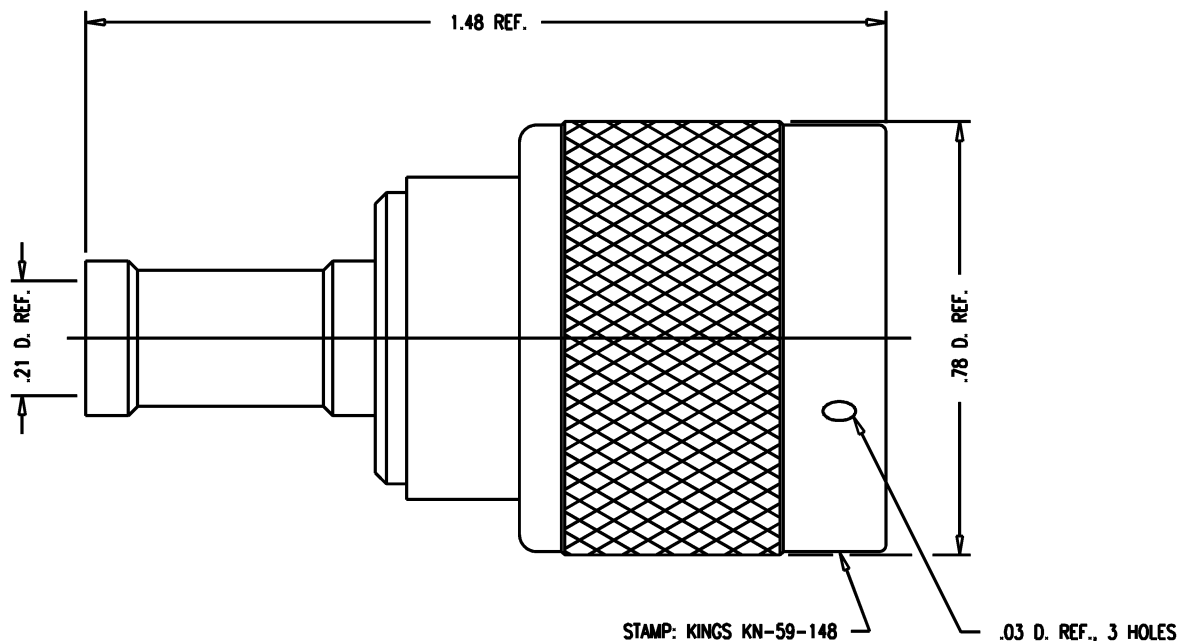

NOTES:

- FOR USE WITH RG-58, 58A, 58C, 141 & 141A/U CABLE.
- FOR CABLING INSTRUCTIONS SEE CP-415.
- FOR CABLE TRIMMING USE KTJ-65 & KTD-38.
- FOR CRIMPING USE DIE KTH-2061.
- FOR POSITIONING OF CENTER CONTACT USE KTP-3.
- INTERFACE PER MIL-STD-348, FIG. 304-1.
- MATERIALS:
 - INSULATOR: TEFLON, ASTM-D-1457
 - GASKET: SILICONE RUBBER, ZZ-R-765
 - K-GRIP SLEEVE: COM. BRONZE TUBE, ALLOY 220
 - C-RING } PHOSPHOR BRONZE, Q0-B-750
 - OUTER CONTACT }
 - ALL OTHER METAL PARTS: BRASS, ASTM-B16
- FINISHES:
 - CENTER CONTACT } SILVER PLATE, PER Q0-S-365
 - OUTER CONTACT }
 - ALL OTHER METAL PARTS: KINGS TARNISH RESISTANT FINISH (TR-5)
- ELECTRICAL CHARACTERISTICS:
 - NOMINAL IMPEDANCE: 50 OHMS
 - WORKING VOLTAGE: 1000 VRMS
 - FREQUENCY RANGE: DC TO 11 GHz.

WJM1381

SCALE	4:1
-------	-----

APPROX SURFACE AREA	
---------------------	--

USED ON	
---------	--

REF:	
------	--

PLUG, N

DRAWN	WJM	DATE	09/23/91
-------	-----	------	----------

DESIGN	MJB	DATE	09/25/91
--------	-----	------	----------

APPR.		DATE	
-------	--	------	--

KINGS
ELECTRONICS CO., INC.
TUCKAHOE, NEW YORK 10707

KN-59-148

GSD