

LOW PROFILE MOLDED PLASTIC SURFACE MOUNT, kHz FREQUENCY CRYSTAL



ABS25

Pb in High Temperature Solder
(exempt per RoHS 2002/95/EC Annex (7))

**RoHS
Compliant**

➤ **FEATURES:**

- Low frequency in small size SMD
- 2.5mm height ideal for high density circuit boards
- Excellent environmental & heat resistance plastic package with reflow capability
- Extended temperature -40°C to +85°C for industrial applications

➤ **APPLICATIONS:**

- Wide range in communication & measuring equipment
- Commercial & Industrial applications
- Automotive electronics applications
- Wireless communications
- PDA and Palm Pilots

➤ **STANDARD SPECIFICATIONS:**

PARAMETERS	
ABRACON P/N	ABS25
Standard Frequency	32.768 kHz
Frequency Range	30kHz to 100kHz
Operating Temperature	-40°C to + 85°C
Turn-over Temperature	+25°C to ±5°C
Storage Temperature	-55°C to +125°C
Frequency Tolerance	±20 ppm max. (for 32.768kHz) ±30 ppm max. for other frequencies (see options)
Capacitance Ratio	450 typ. (32.768kHz) 425 to 800 typ. (others)
Frequency Coefficient (β)	- 0.034±0.006 ppm/T ²
Equivalent Series Resistance	50 kohms max.
Load Capacitance CL	12.5 pF (see option)
Shunt Capacitance C0	1.35 pF typ. (32.768kHz) 0.8 pF to 1.7 pF typ. (others)
Drive Level	1.0 μW max.
Aging @ 25°C ± 3°C first year	± 3 ppm max. (32.768kHz) ± 5 ppm max. (others)
Insulation Resistance	500 MΩ with 100 Vdc ±15V

➤ **OPTIONS AND PART IDENTIFICATION:**

(Left blank if standard)

ABS25- Frequency- [] - [] - []

CL Option
Please specify load cap. in pF (ex. 6pF)

Freq. Tolerance	
1	± 10 ppm
5	± 15 ppm
2	± 20 ppm
3	± 25 ppm
4	± 30 ppm

Packaging	
Blank	Bulk
T	Tape and Reel



LOW PROFILE MOLDED PLASTIC SURFACE MOUNT, kHz FREQUENCY CRYSTAL

ABS25



8.0 x 3.8 x 2.5 mm

ABS25

Pb in High Temperature Solder
(exempt per RoHS 2002/95/EC Annex (7))

RoHS
Compliant

OUTLINE DRAWING:

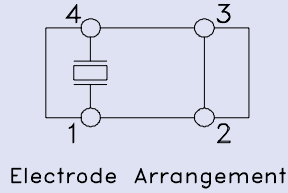
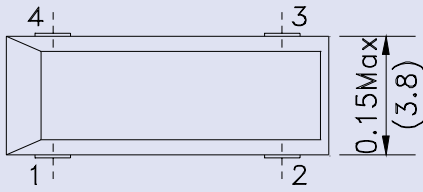

Recommended Land Pattern

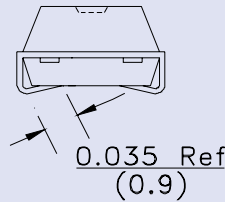
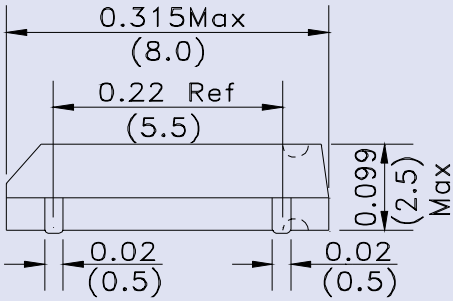
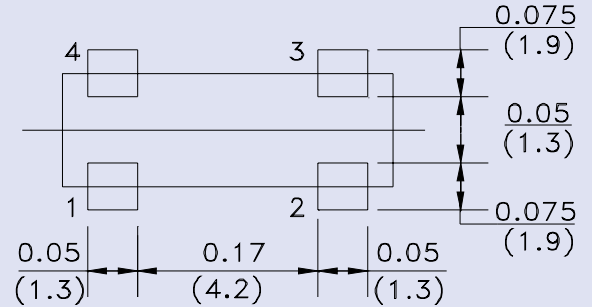

Dimensions: (inches) mm

TAPE & REEL: T = Tape and reel 3,000pcs/reel

FEEDING (PULL) DIRECTION →

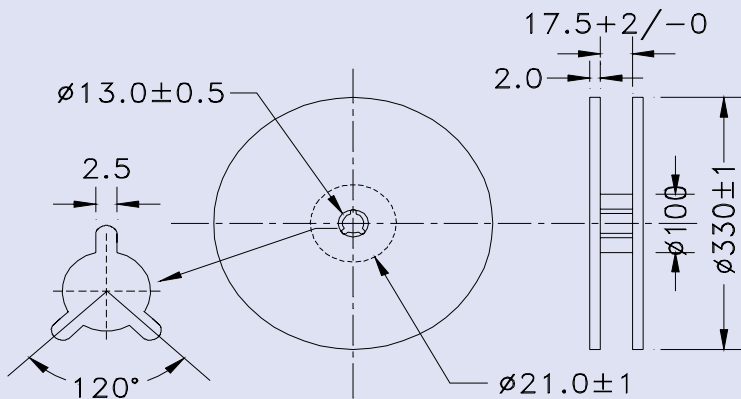
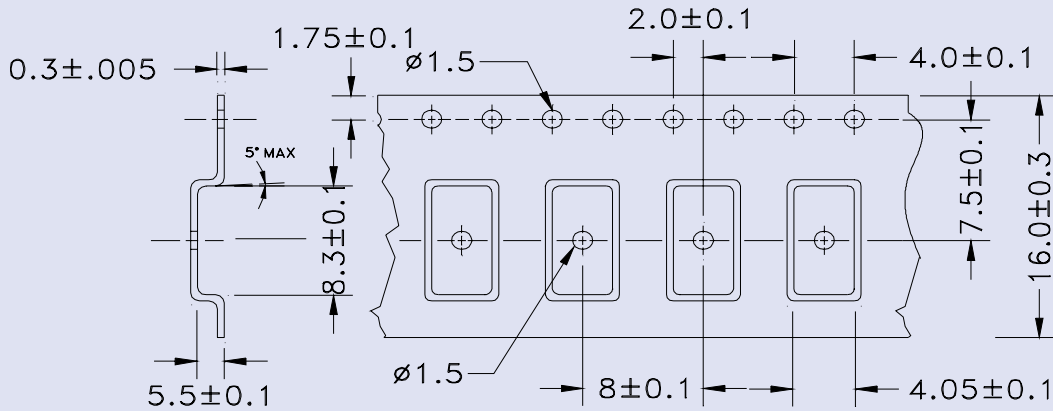

Dimensions: mm