

小形ジャック (φ2.5, プリント基板用)
Miniature Jacks (2.5 DIA, P.C. Board Terminals)

UNIT: mm

h=2 mm

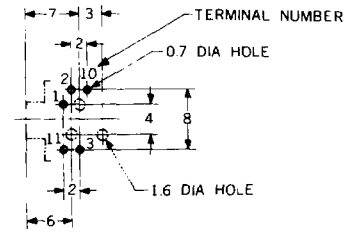
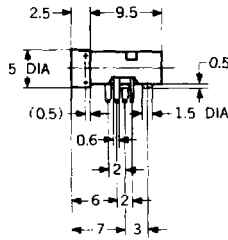
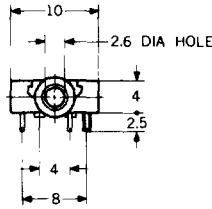

HOLE LAYOUT
(BOTTOM VIEW)

HSJ1102-01-510

Schematic						
	Model No.	HSJ1102-01-510	HSJ1102-01-520	HSJ1102-01-530	HSJ1102-01-540	HSJ1102-01-550

— 体積比約 50% (HSJ0861 比) の小形、薄形タイプ—
 超薄形、小形で回路構成はフルチョイスが可能です。ボディを上げ底構成とし、フラックス流入防止の向上と密閉化を計っています。

— Small thin type, about 50% in volume
 (compared with HSJ0861) —
 It is extra-thin and compact, and allows full choice of circuit configuration. The housing is a raised bottom structure so that flux inflow can be effectively prevented.

h=2.5 mm

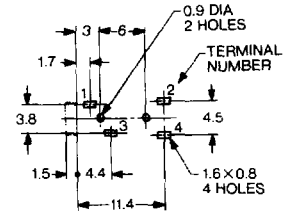
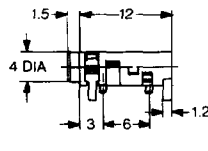
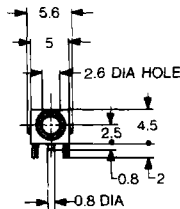

HOLE LAYOUT
(BOTTOM VIEW)

HSJ1650-010040

Schematic		
	Housing Color	Black
Model No.	HSJ1650-010020	HSJ1650-010040

h=2.5 mm

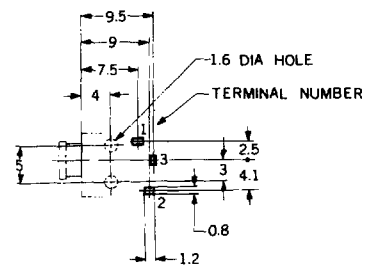
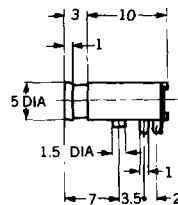
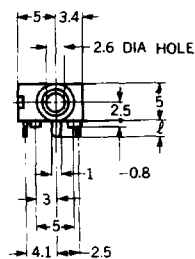

HOLE LAYOUT
(BOTTOM VIEW)

HSJ0838-01-010

Schematic	
	Model No.
Height (mm)	1.8
Model No.	HSJ0838-01-500

UNIT: mm

$h=2.5$ mm

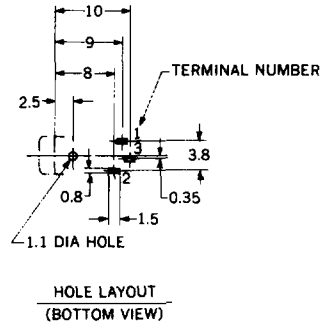
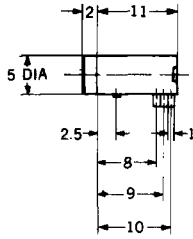
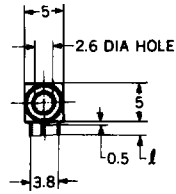

HSJ1080-01-010

Schematic	
l (mm)	
1.8	HSJ1080-01-010
2.5	HSJ1080-01-110

$h=2.5$ mm

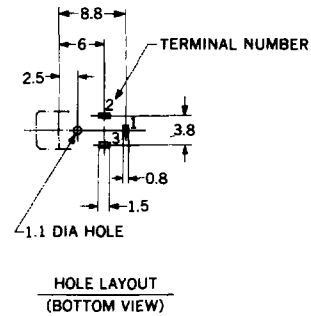
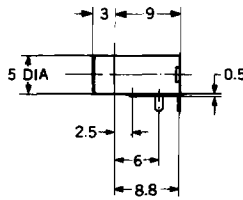
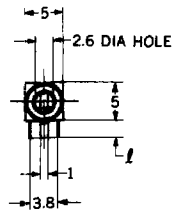

HSJ1122-010010

Schematic	
l (mm)	
1.8	HSJ1122-010010
2.3	HSJ1122-010110

$h=2.5$ mm

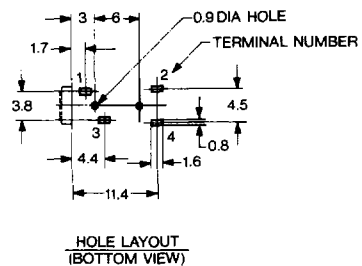
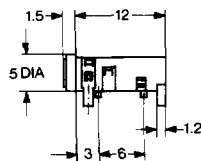
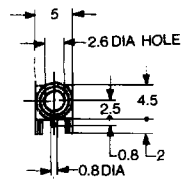

HSJ1550-010010

Schematic	
Model No.	HSJ1550-010010

小形ジャック (φ2.5, プリント基板用)
Miniature Jacks (2.5 DIA, P.C. Board Terminals)

UNIT: mm

h=5 mm

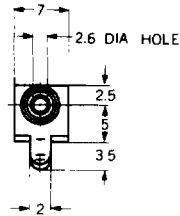

WITH OR WITHOUT THREAD

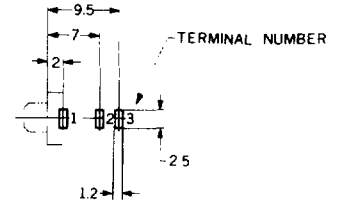
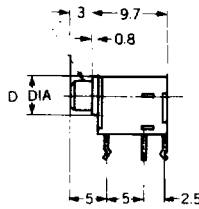

HOLE LAYOUT
(BOTTOM VIEW)

HSJ0789-01-020

Schematic		
Flange D DIA (mm)	Sleeve	
5	M4-0.5	HSJ0789-01-010
5	4 DIA	HSJ0789-01-020
6	M4-0.5	HSJ0789-01-030

h=5.5 mm

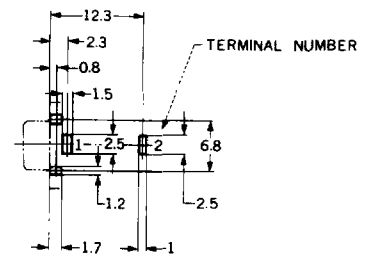
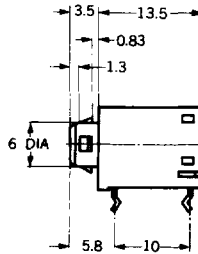
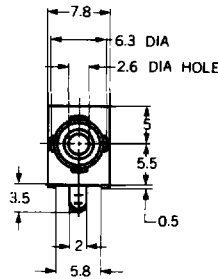

HOLE LAYOUT
(BOTTOM VIEW)

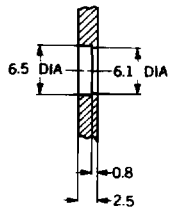

MOUNTING HOLE

HSJ0803-01-010

Schematic	
Model No.	HSJ0803-01-010

小形ジャック (φ2.5, プリント基板用)
 Miniature Jacks (2.5 DIA, P.C. Board Terminals)

UNIT: mm

$h=6.5$ mm

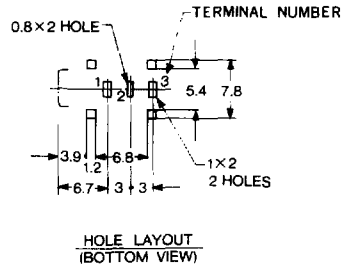
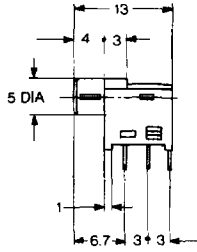
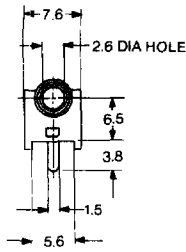

HSJ1462-01-010

Schematic	
Model No.	HSJ1462-01-010

$h=6.5$ mm

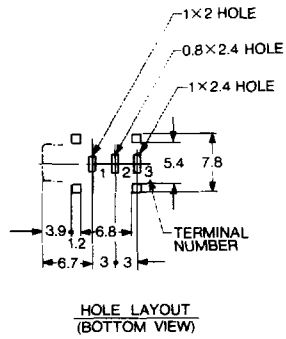
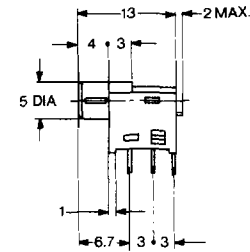
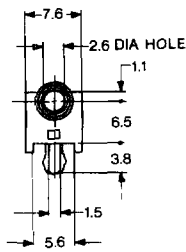

HSJ1492-01-010

Schematic	
Model No.	HSJ1492-01-010

UNIT: mm

ℓ = 12.7 mm

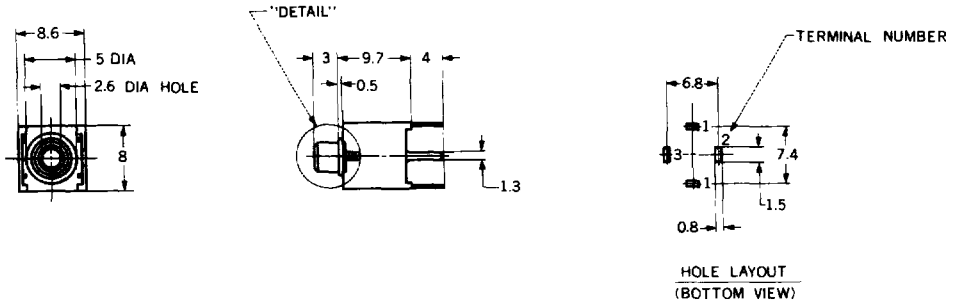

HSJ0798-01-010

Schematic	
Sleeve	
Fig. 1	HSJ0798-01-010
Fig. 2	HSJ0798-01-020

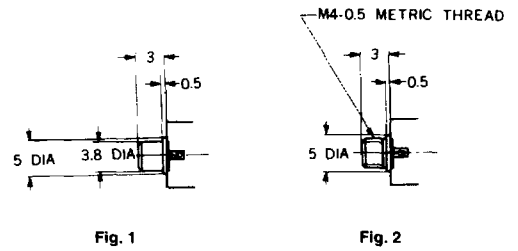

ℓ = 13.5 mm

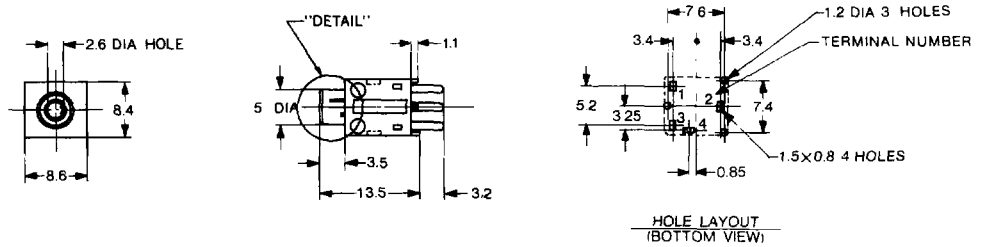

HSJ1552-010020

スリーブ Sleeve	ボディ 色調 Housing Color		
Fig. 1	Black Blue	HSJ1552-010010 HSJ1552-010018	HSJ1552-010020
Fig. 2	Black Blue		HSJ1553-010610 HSJ1553-010618

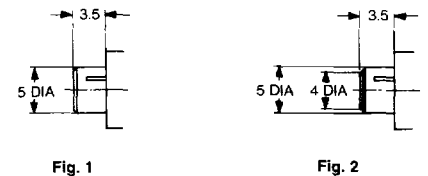

ℓ = 17.5 mm

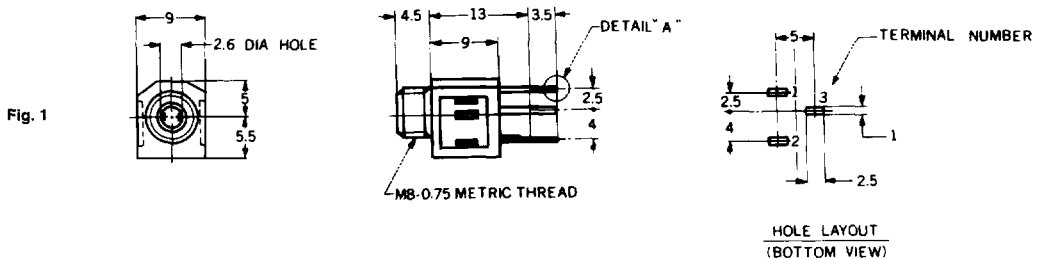

HSJ0834-01-010

リード配線も可能です。
Available Lead Wire Terminals.

Schematic	
Housing	
Fig. 1	HSJ0834-01-010
Fig. 2	HSJ1516-010010

