



## SMA Female Connector Solder Attachment 4 Hole Flange Tab Terminal, .375 inch x .500 inch Hole Spacing

### TECHNICAL DATA SHEET

PE4539

#### SMA Female Connector Solder Attachment 4 Hole Flange Tab Terminal, .375 inch x .500 inch Hole Spacing

##### Configuration

Connector	SMA Female
Connector Interface Type	Tab
Cable Attachment Method (Shield/Contact)	Solder
Body Style	Straight
Mount Method	4 Hole Flange

##### Electrical Specifications

Impedance, Ohms	50
-----------------	----

##### Mechanical Specifications

###### Size

Length, in [mm]	0.475 [12.07]
Width/Dia., in [mm]	0.375 [9.53]
Height, in [mm]	0.5 [12.7]
Weight, lbs [g]	0.006 [2.72]

###### Connector

Type	SMA Female
Contact Material and Plating	Gold
Body Material and Plating	Stainless Steel, Gold
Dielectric Type	PTFE

##### Compliance Certifications (visit [www.Pasternack.com](http://www.Pasternack.com) for current document)

RoHS Compliant	Yes
----------------	-----

##### Plotted and Other Data

Notes:	Values at 25 °C, sea level
--------	----------------------------

SMA Female Connector Solder Attachment 4 Hole Flange Tab Terminal, .375 inch x .500 inch Hole Spacing from Pasternack Enterprises has same day shipment for domestic and International orders. Our RF, microwave and fiber optic products maintain a 99% availability and are part of the broadest selection in the industry.

Click the following link (or enter part number in "SEARCH" on website) to obtain additional part information including price, inventory and certifications: [SMA Female Connector Solder Attachment 4 Hole Flange Tab Terminal, .375 inch x .500 inch Hole Spacing PE4539](http://www.pasternack.com/sma-female-standard-tab-terminal-connector-pe4539-p.aspx)

URL: <http://www.pasternack.com/sma-female-standard-tab-terminal-connector-pe4539-p.aspx>

The information contained in this document is accurate to the best of our knowledge and representative of the part described herein. It may be necessary to make modifications to the part and/or the documentation of the part, in order to implement improvements. Pasternack reserves the right to make such changes as required. Unless otherwise stated, all specifications are nominal.



**MATERIALS**

BODY	STAINLESS STEEL GOLD PLATED
CONTACT	GOLD PLATED
INSULATOR	PTFE

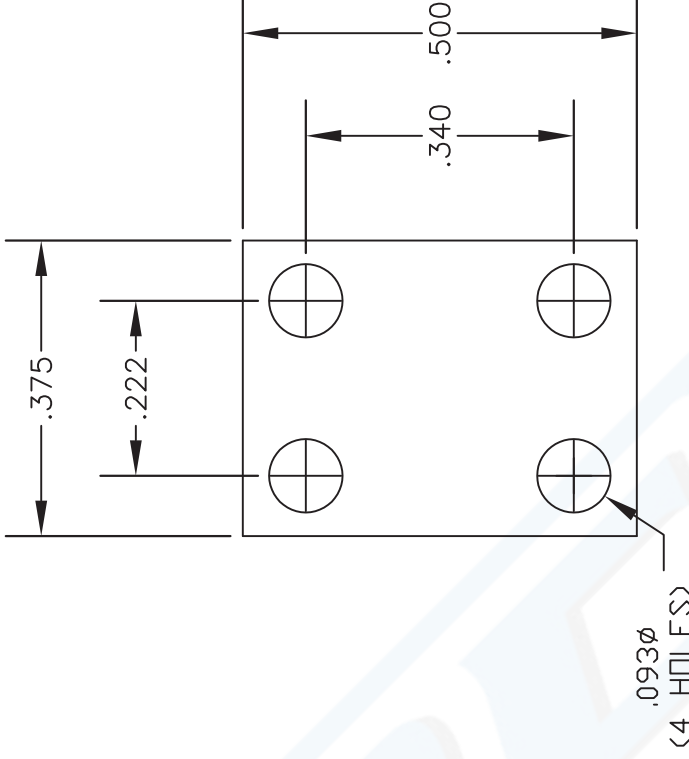
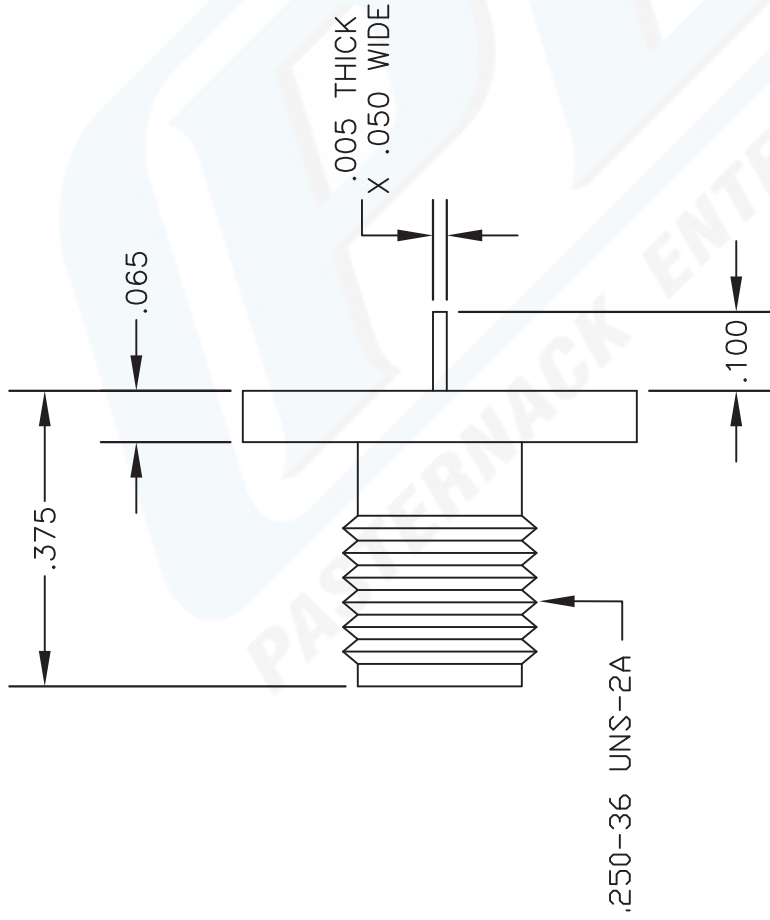

MOUNTING HOLES



**PASTERNAK ENTERPRISES**  
ESTABLISHED 1972

**PASTERNAK ENTERPRISES, INC.**  
P.O. BOX 16759, IRVINE, CA 92623  
PHONE (949) 261-1920 FAX (949) 261-7451  
WEB ADDRESS: www.pasternack.com  
E-MAIL ADDRESS: sales@pasternack.com  
**COAXIAL & FIBER OPTICS**

DWG TITLE

**PE4539**

DES. SMA FEMALE, FLANGE MOUNT REMOVABLE  
TAB CONTACT

SIZE A

FSCM NO. 53919

CAD FILE 060302

SCALE N/A

127

NOTES:

1. UNLESS OTHERWISE SPECIFIED ALL DIMENSIONS ARE NOMINAL.
2. ALL SPECIFICATIONS ARE SUBJECT TO CHANGE WITHOUT NOTICE AT ANY TIME.