

Bushes and Shanks

with full plain Pin-Plate

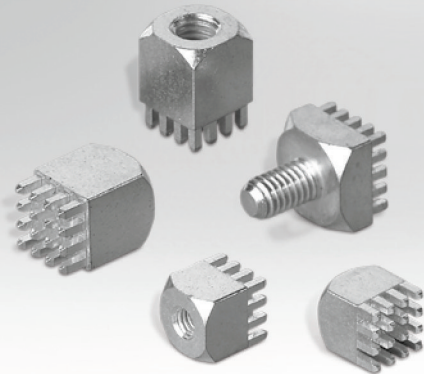

Characteristics

- Prepared hole diameter: 1.60 mm
- Final hole diameter for HAL surface: 1.45 mm ±0.05 mm
- Final diameter for chemical surfaces (e.g. tin): 1.475 mm ±0.05 mm
- Not suitable for soldering
- Available with threaded shank or threaded hole

Dimensions (mm)

Order Code	Power Elements					Pins	Format Type	Type
	Four corners a (mm)	b (mm)	c (mm)	d (mm)	e			
746 100 1	7	15.5	3.5	8	M 5	9	I	shank
746 109 3	7	9.5	3.5	4	M 3	9	I	bush
746 109 4	7	11	3.5	5	M 3	9	I	shank
746 109 5	9	10.5	3.5	4	M 4	16	J	bush
746 109 6	7	12.5	3.5	6	M 4	9	I	shank
746 114 7	9	10.5	3.5	4	M 5	16	J	bush
746 138 3	9	16	3.5	8	M 5	16	J	shank
746 109 7	10	14	3.5	7	M 6	16	J	bush
746 109 8	13	19	3.5	10	M 6	25	K	shank
746 109 9	13	17	3.5	8	M 8	25	K	bush
746 071 9	13	24	3.5	13	M 8	25	K	shank
746 106 1	16	21	3.5	10	M 10	36	L	bush
746 110 0	16	27.5	3.5	16	M 10	36	L	shank

Dimensions Threaded Shank

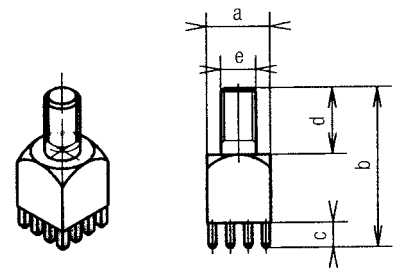

Illustration of hole I

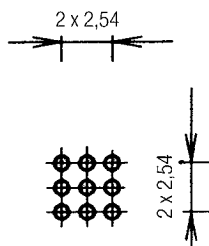

Illustration of hole J

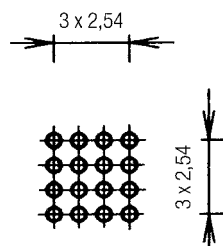

Illustration of hole K

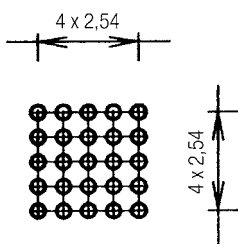
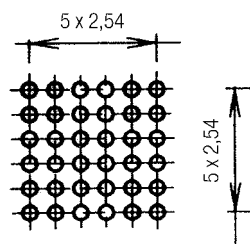

Illustration of hole L



Dimensions Threaded Hole

