

DWG. NO. 241-910-0630G			
REV	DESCRIPTION	BY DATE	APPD
F	ECN 2447	JWH 7/19/00	[Signature]

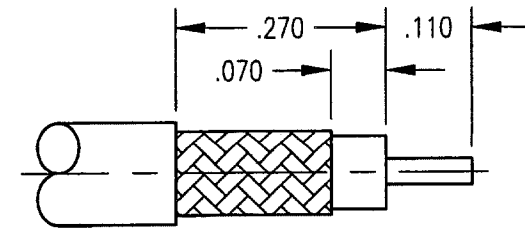
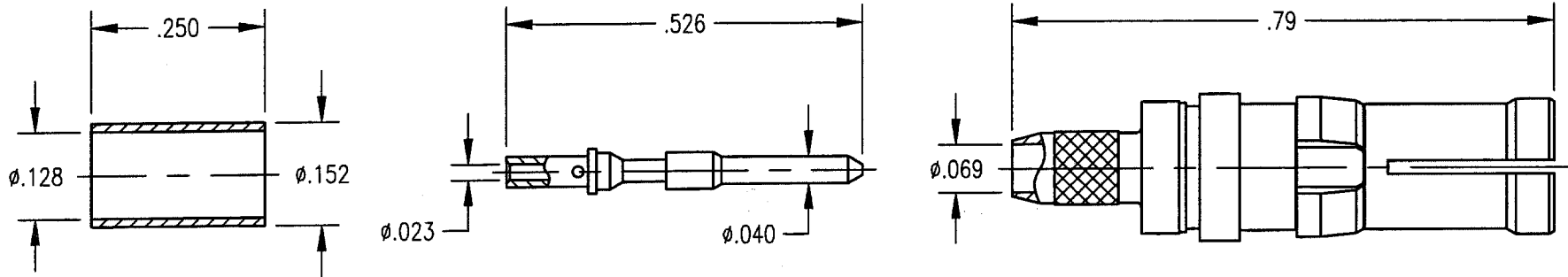

TRIMMING DIMENSIONS

NOTES:

- MATERIALS:  
 FRONT BODY: BERYLLIUM COPPER PER ASTM B196  
 CLIP RING: BERYLLIUM COPPER PER ASTM B194  
 ALL OTHER METAL PARTS: BRASS PER ASTM B16  
 INSULATOR: TEFLON PER ASTM D1710
- FINISH:  
 BODY AND CONTACT:  $.000030$  MIN. GOLD PER MIL-G-45204 OVER  
 $.000050$  MIN. NICKEL PER QQ-N-290  
 CLIP RING:  $.000100$  MIN. NICKEL PER QQ-N-290  
 OVER COPPER FLASH  
 FERRULE:  $.000005$  MIN. GOLD PER MIL-G-45204 OVER  
 $.000050$  MIN. NICKEL PER QQ-N-290
- FOR USE WITH RG-179 CABLE OR EQUIVALENT.
- FOR CABLING PROCEDURE USE CAP 9-07.
- CRIMP FERRULE USING  $.128$  HEX DIE.

PER ASME Y14.5M-1994 UNLESS OTHERWISE SPECIFIED: DIMENSIONS ARE IN INCHES [MM]		<b>Litton</b> 400 Park Road Waterbury, Connecticut 06785	
TOLERANCES: DECIMALS .XX $\pm .01/0.254$ XXX $\pm .005/0.127$ ANGLES $\pm 2^\circ$ SCALE: 4:1		<b>Winchester/Retconn</b>	
<b>CUSTOMER DRAWING</b>		TITLE RDM 75 OHM STRAIGHT RECEPTACLE	
DRWN JED	DATE 3/14/00	CHECKED JWH	DATE 3/14/00
APPROVED JMC	DATE 3/14/00	APPROVED JFT	DATE 3/14/00
A 241-910-0630G		SHT. OF 1 1	REV. F