

### Specifications

Parameter	Unit	Minimum	Typical	Maximum
Center Frequency	MHz	114.92	115	115.08
Insertion Loss	dB		20	21.5
3dB Bandwidth	MHz	1.8	1.85	
30dB Bandwidth	MHz		2.55	2.6
40dB Bandwidth	MHz		2.66	2.8
50dB Bandwidth	MHz		2.9	3
Passband Variation	dB		0.8	1
Absolute Delay	usec		3.4	4
Group Delay Variation( $f_0 \pm 720\text{kHz}$ )	nsec		150	200
Phase Linearity( $f_0 \pm 720\text{MHz}$ )	degree		3.4	4
Ultimate Rejection	dB	52	55	
Substrate Material			quartz	
Ambient Temperature	°C		25	
Package Size		DIP2712 (27.0x12.8x4.7mm <sup>3</sup> )		

#### Notes:

1. All specifications are based on the test circuit shown
2. In production, devices will be tested at room temperature to a guardbanded specification to ensure electrical compliance over temperature
3. Electrical margin has been built into the design to account for the variations due to temperature drift and manufacturing tolerances
4. This is the optimum impedance in order to achieve the performance show

### Matching Configuration

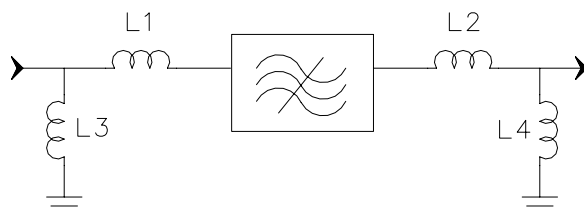

**L1=68nH L2=15nH**

**L3=27nH L4=82nH**

**Source/Load Impedance=50 ohm**

Notes - Component values may change depending on board layout.

	<b>SIPAT Co., Ltd.</b> ( CETC No. 26 Research Institute ) Nanping Huayuan Road No. 14 Chongqing, China, 400060	Part Number	LBS11531	
		Rev. Date	2005-4-11	
		Rev.	1.0	Page

*Package Dimension*

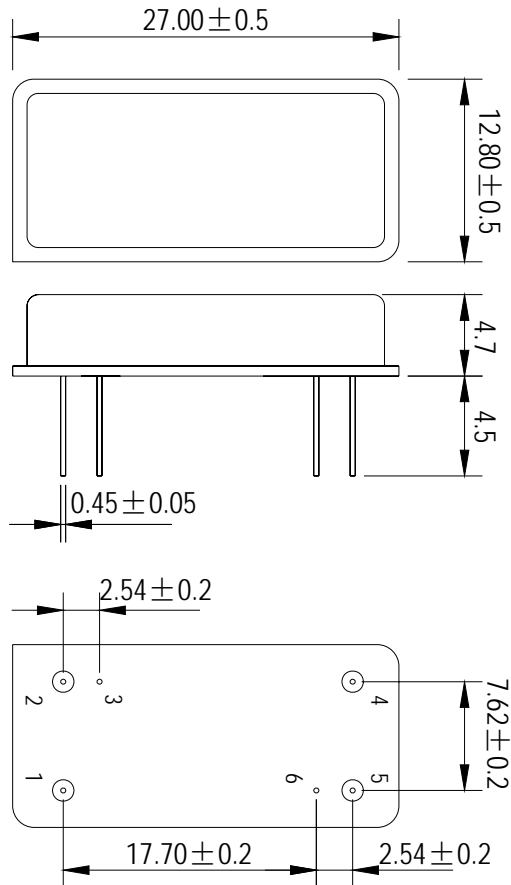

Pin 1: input  
Pin 5: output  
Others: Grounded



**SIPAT Co., Ltd.**  
( CETC No. 26 Research Institute )  
Nanping Huayuan Road No. 14  
Chongqing, China, 400060

Part Number	LBS11531	
Rev. Date	2005-4-11	
Rev.	1.0	Page 2/3

Typical Performance

Frequency Respond

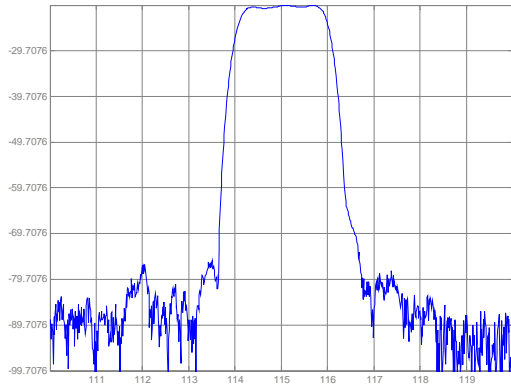

Passband Respond

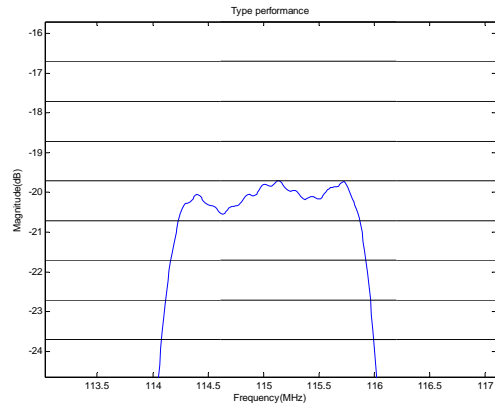

Group Delay Variation( $f_0 \pm 720\text{kHz}$ )

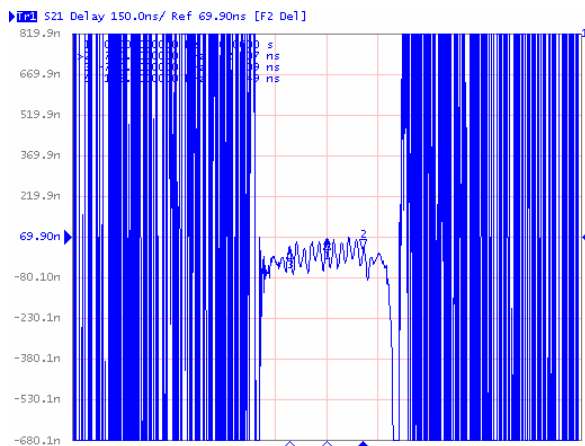

Phase Linearity( $f_0 \pm 720\text{kHz}$ )

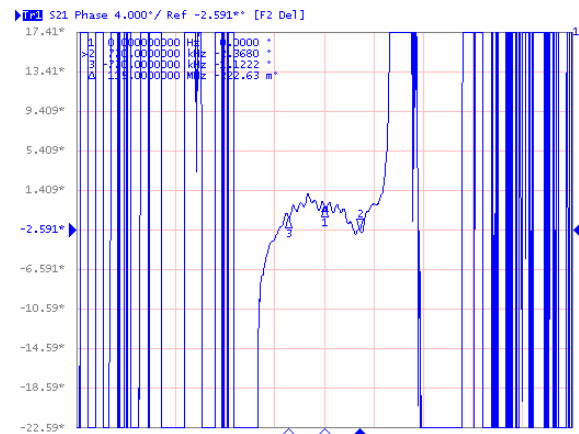

Smith Chart S11

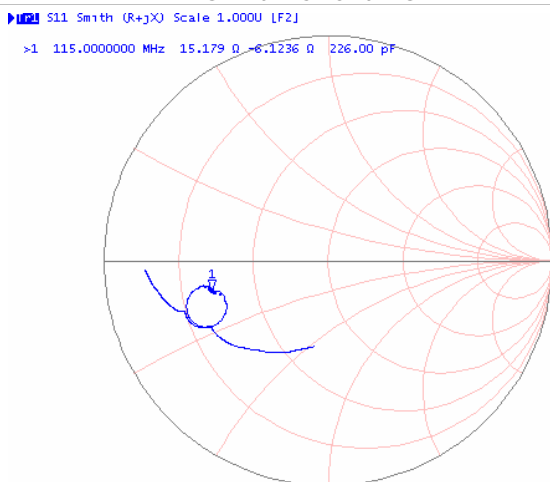

Smith Chart S22

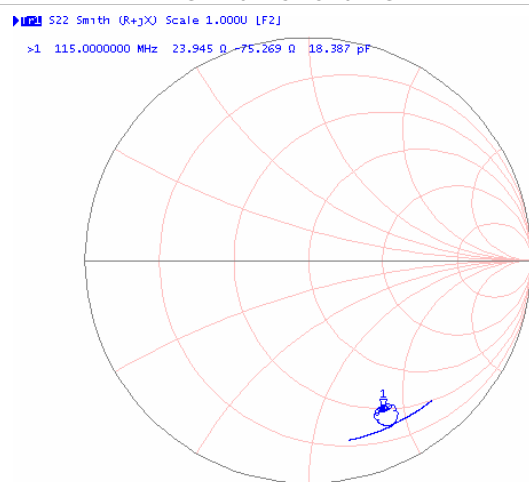

**SIPAT Co., Ltd.**  
( CETC No. 26 Research Institute )  
Nanping Huayuan Road No. 14  
Chongqing, China, 400060

Part Number	LBS11531	
Rev. Date	2005-4-11	
Rev.	1.0	Page 3/3