



# TAI-SAW TECHNOLOGY CO., LTD.

No. 3, Industrial 2nd Rd., Ping-Chen Industrial District,  
Taoyuan, 324, Taiwan, R.O.C.

TEL: 886-3-4690038 FAX: 886-3-4697532  
E-mail: [tstsales@mail.taisaw.com](mailto:tstsales@mail.taisaw.com) Web: [www.taisaw.com](http://www.taisaw.com)

## Approval Sheet For Product Specification

Issued Date:

Product Name: SAW IF Filter 240MHz

TST Parts No.: TB0376A ( package 7mm x 5 mm )

Customer Parts No.: \_\_\_\_\_

Company: _____
Division: _____
Approved by : _____
Date: _____

Checked by: \_\_\_\_\_ Andy Yu *Andy*

Approval by: \_\_\_\_\_ Francis Chen *(Signature)*

Date: \_\_\_\_\_ 07/07 /2009

1. Customer signed back is required before TST can proceed with sample build and receive orders.
2. Orders received without customer signed back will be regarded as agreement on the specifications.
3. Any specifications changes must be approved upon by both parties and a new revision of specifications shall be released to reflect the changes.



# TAI-SAW TECHNOLOGY CO., LTD.

No.3, Industrial 2nd Rd., Ping-Chen Industrial District, Taoyuan, Taiwan, R.O.C.

TEL: 886-3-4690038 FAX: 886-3-4697532

E-mail: [tstsales3@mail.taisaw.com](mailto:tstsales3@mail.taisaw.com) Web: [www.taisaw.com](http://www.taisaw.com)

SAW Filter 240MHz (SMD 7×5 mm)

MODEL NO.: TB0376A

Rev. No. 2.0

RoHS Compliant  
Lead free  
Lead-free soldering

## A. MAXIMUM RATING:

1. Input Power Level: 10 dBm
2. Operating Temperature: -40 °C ~ +85 °C
3. Storage Temperature: -40 °C ~ +85 °C

Characteristics	Value			Note.
	Min.		Max.	
Center frequency $F_c$ MHz	239.5	240.0	240.5	-
Maximum Insertion loss I.L. dB	-	12.0	14.0	-
1dB Bandwidth MHz	10.5	10.9		
3dB Bandwidth MHz	-	12.2	13.3	
40dB Bandwidth MHz	-	18.0	20.0	
Passband Ripple at any 200kHz within 11MHz dB	-	0.6	1	-
Group Delay Ripple (234.5 ~245.5MHz) nS	-	75	200	-
Temp Coefficient ppm/° C		-23		
Attenuation:( Reference level from minimum insertion loss)				
1) 100 ~ 223 MHz	40	43	-	-
2) 257MHz ~ 500 MHz dB	42.5	46	-	-

## C. TEST Circuit:

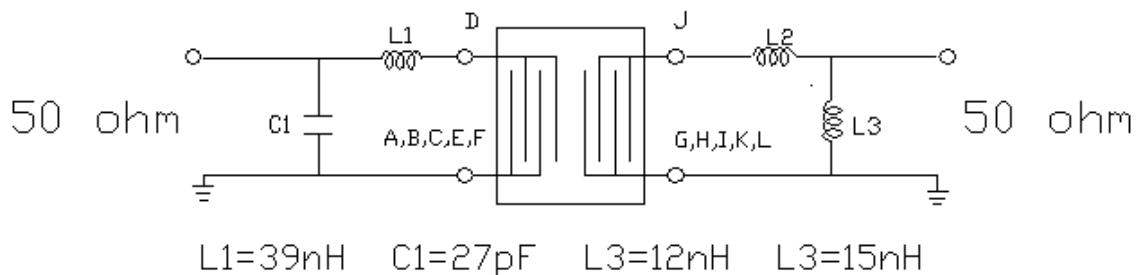

D. OUTLINE DRAWING:

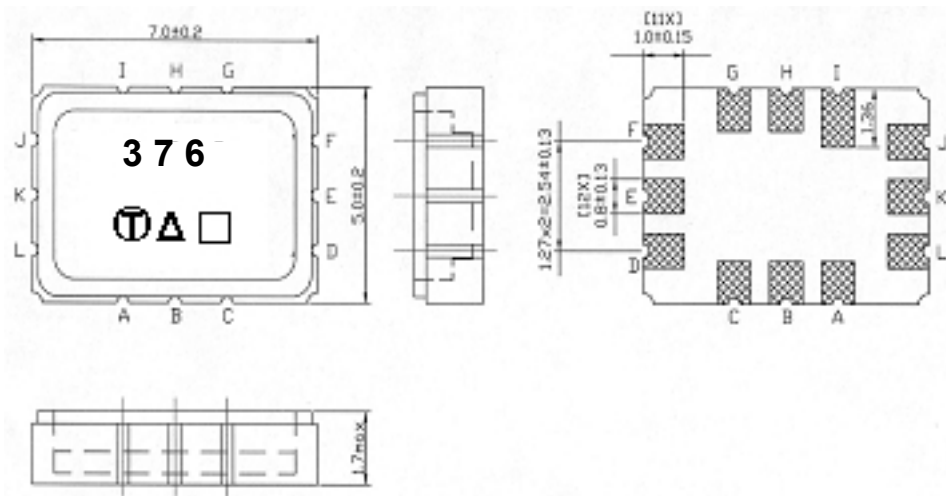

Pin D : Unbalanced Input

Pin J : Unbalanced Output

Pin A, B, C, E, F, G, H, I, K, L : To be Ground

□ : Week Code (Follow the table from planner each year)

Unit : mm

△ : Product / Year Code

Year	2005 2009	2006 2010	2007 2011	2008 2012
Product Code	B	b	<u>B</u>	<u>b</u>

E. PCB FOOTPRINT:

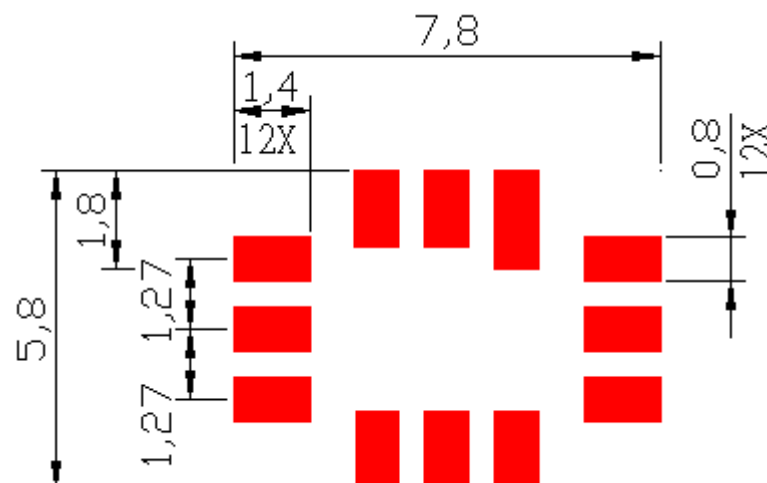

## F.FREQUENCY CHRACTERISTICS:

(1) wide band of Response:

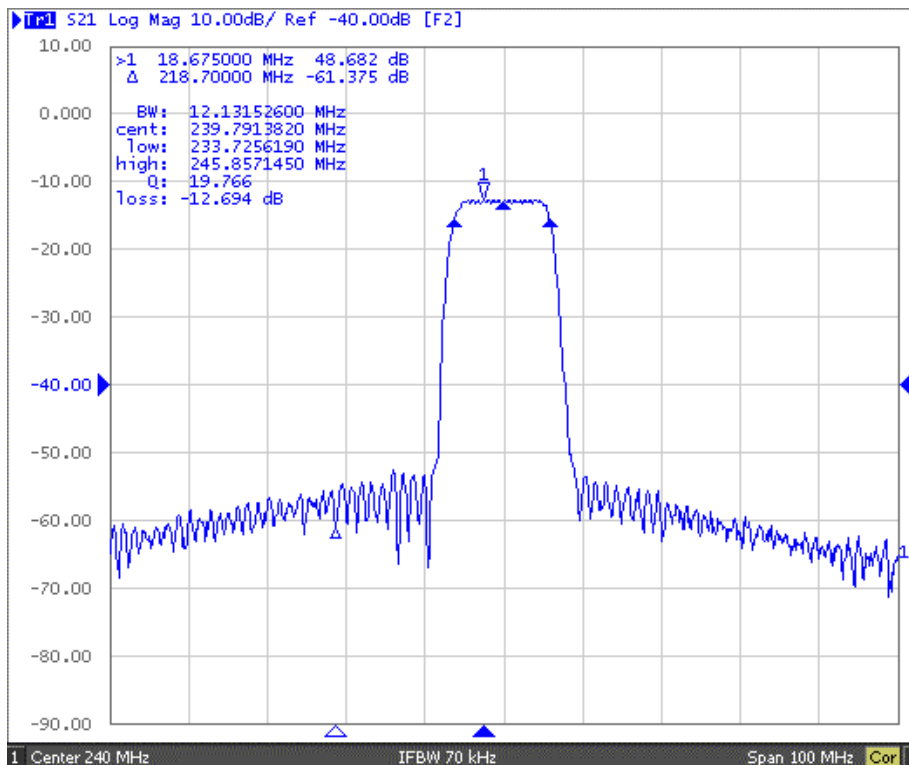

Fig-1 S21 Response Horizontal: 10MHz/Div  
Vertical: 10dB/Div

(2) Passband of Response:

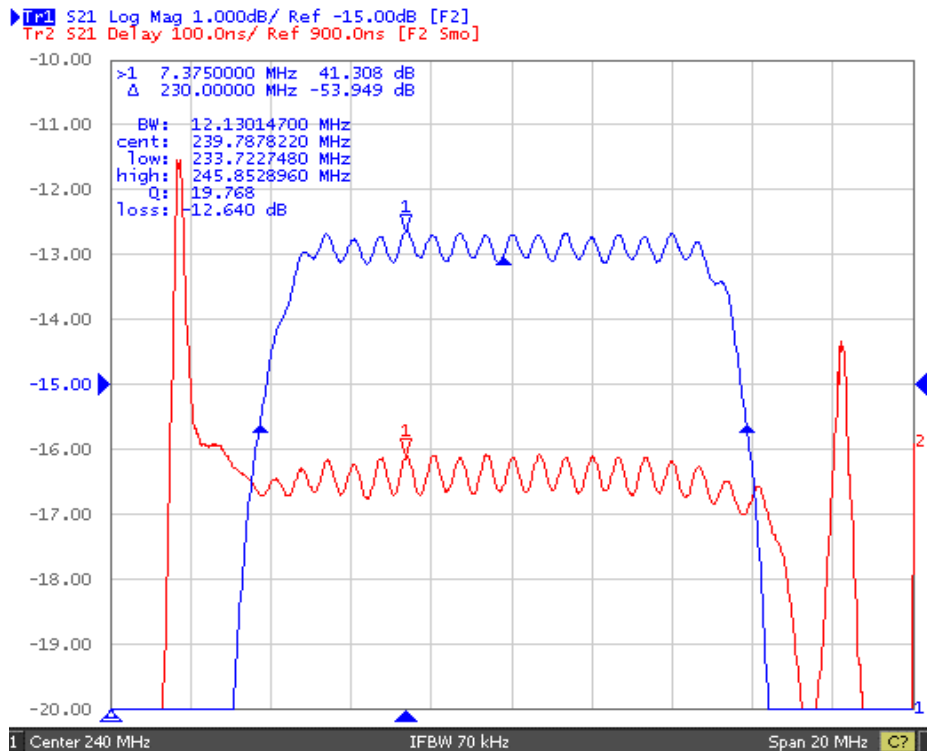
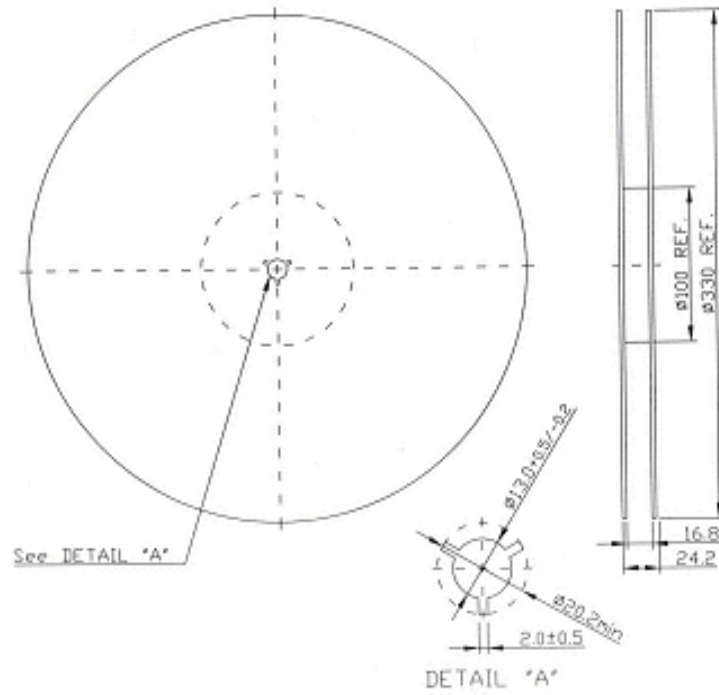

Fig-2 Group Delay and Ripple, Horizontal:2MHz/Div  
Vertical: 1 dB/Div Vertical: 100nS/Div

G. PACKING:

(1). REEL DIMENSION



(2). TAPE DIMENSION

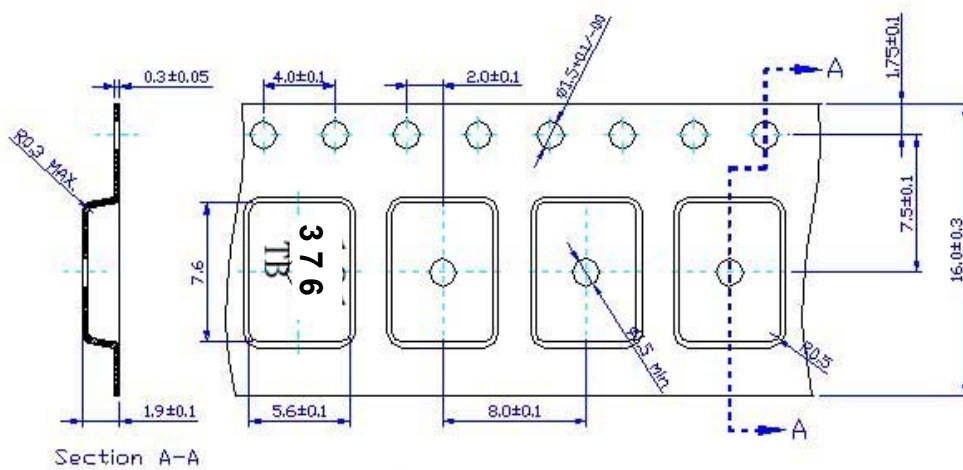

H. Recommended Reflow Profile:

